



Seymours



# Woodlands Close Camberley, GU17 9HZ £570,000

Arrange a viewing: 01276 534100

## Property Details

-  4 bedrooms
-  2 baths
-  EPC Rating TBC
-  1405 sqft
-  Blackwater (1.3 miles)
  - NO ONWARD CHAIN
  - Neo Georgian
  - Detached
  - Four Bedrooms
  - Off Road Parking
  - Two Reception Rooms
  - Kitchen/ Breakfast Room
  - Study
  - Downstairs W/C

**\*\*NO ONWARD CHAIN\*\*** An attractive Neo Georgian detached house nestled in this desirable close in Hawley. This four-bedroom family home boasts a great amount of living accommodation with scope for the incoming purchaser to modernise and update to their own taste. The ground floor consists of two reception rooms, study, kitchen breakfast room, utility and downstairs cloakroom. Upstairs offers three generous double bedrooms, one single and two bathrooms, one of which is an en-suite off the principal bedroom. The property also benefits from a long driveway leading to a double length garage which incorporates a glass garden room on the side overlooking the mature and private rear garden.

[01276 534100](tel:01276534100) / [james@seymours-blackwater.co.uk](mailto:james@seymours-blackwater.co.uk)



### Woodlands Close

Approximate Gross Internal Area = 130.5 sq m / 1405 sq ft  
(Excluding Garage & Garden Room)

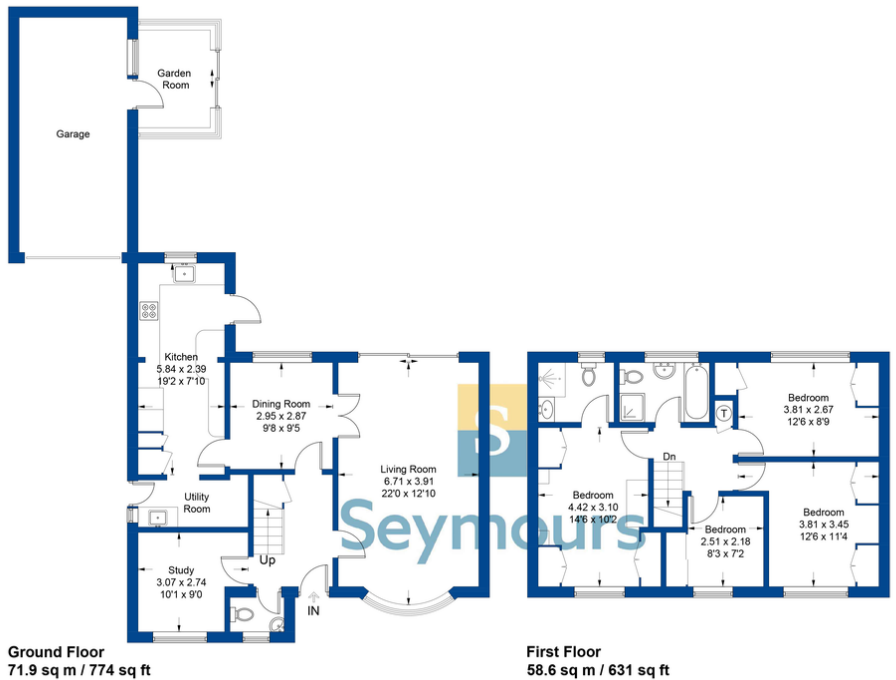

Illustration for identification purposes only, measurements are approximate, not to scale. FloorplansUsketch.com © 2024 (ID1094516)