



Seymours



Celandine Court Yateley, GU46 6LP £350,000

Arrange a viewing: 01276 534100

Property Details

-  2 bedrooms
-  1 baths
-  EPC Rating TBC
-  698 sqft
-  Sandhurst (2.7 miles)

- Two double bedrooms
- Living room
- Kitchen/dining room
- Modern bathroom
- Private rear garden
- Parking
- Convenient for Yateley village
- Waitrose close by
- Good local schools

A well presented home with two double bedrooms and a modern bathroom as well as a spacious living room and kitchen/dining room. The property has the benefit of having had a useful porch being added and also has an attractive enclosed rear garden offering a good degree of privacy. To the front of the property is allocated parking. The house is ideally located in this popular close in Yateley where there are a range of shops ,amenities and pubs as well as good local schools and attractive countryside close by.

[01276 534100](tel:01276534100) / james@seymours-blackwater.co.uk



Celandine Court

Approximate Gross Internal Area = 64.9 sq m / 698 sq ft

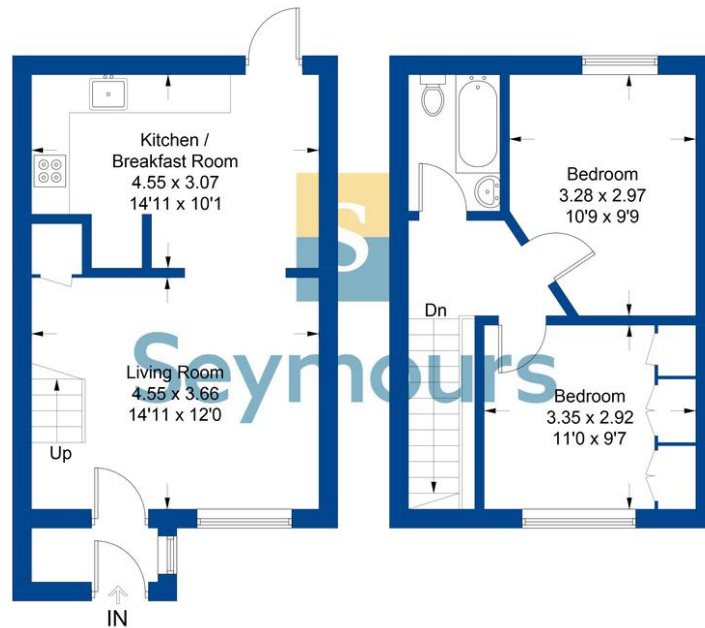

Ground Floor

First Floor

Illustration for identification purposes only, measurements are approximate, not to scale. FloorplansUsketch.com © 2024 (ID1091860)