







Seymours



North Fryerne  
Yateley, GU46 7ST  
£575,000

Arrange a viewing: 01276 534100

## Property Details

-  4 bedrooms
-  2 baths
-  EPC Rating C
-  1860 sqft (inc garage)
-  Station Name (1.4 miles)

- NO ONWARD CHAIN
- Four bedrooms
- Annex
- Living room and dining room
- Kitchen and utility
- Garage and driveway
- Westerly facing garden
- Near to the hub of Yateley
- Council Tax band E currently £2550.46 per annum

A spacious four-bedroom family home which was extended in 1978 with the addition of an annex to the left side of the property and an upstairs extension to enlarge the main bedroom. The property offers a spacious hallway leading to a decent living room through to a dining room giving access to the rear garden. There is also a kitchen and utility room and an integral garage. From the dining room there is access to the annex which is open plan at present with one large room as well as a separate shower room and also separate access to the rear patio. Upstairs there is a very large main bedroom which also benefits from a shower room and there are two further double bedrooms and a good single bedroom. There is also a family bathroom. The property does require some updating but offers the incoming purchaser the opportunity to put their own stamp on the property. To the rear of the property is an enclosed westerly facing garden.

[01276 534100](tel:01276534100) / [james@seymours-blackwater.co.uk](mailto:james@seymours-blackwater.co.uk)

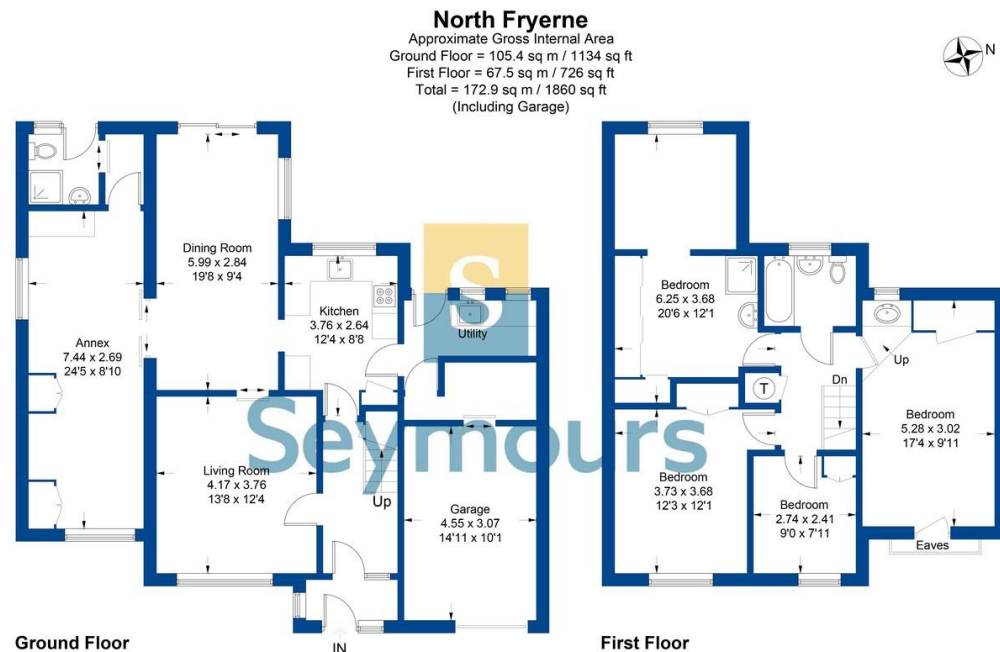

Illustration for identification purposes only, measurements are approximate, not to scale. FloorplansUsketch.com © 2024 (ID1087998)