



Seymours



Ryves Avenue  
Yateley, GU46 6FD  
£480,000

Arrange a viewing: 01276 534100

## Property Details

 4 bedrooms

 2 baths

 EPC Rating D

 1003 sqft

 Sandhurst (2.7 miles)

- Four bedrooms
- Open plan living room and modern kitchen
- Spacious downstairs bedroom with modern en suite shower room
- Study/bedroom 5
- Modern bathroom and cloakroom
- Enclosed walled rear garden
- Parking

A beautifully modernised home which has been the subject of much updating and transformation and offers fabulous open plan living space downstairs. The downstairs space offers a Large open plan living room and kitchen with modern units as well as quartz worksurfaces over. There is also a useful room which can either be used as a double bedroom or a family room/office as it also benefits from a modern shower room. Upstairs there are four bedrooms although at present the smaller bedroom works well as a study. There is also a modern family bathroom. To the rear of the house is an attractive walled garden. To the front of the house is parking. The house is conveniently located in Yateley and there is Waitrose close by with good local schools and attractive countryside at Yateley common.

[01276 534100](tel:01276534100) / [james@seymours-blackwater.co.uk](mailto:james@seymours-blackwater.co.uk)

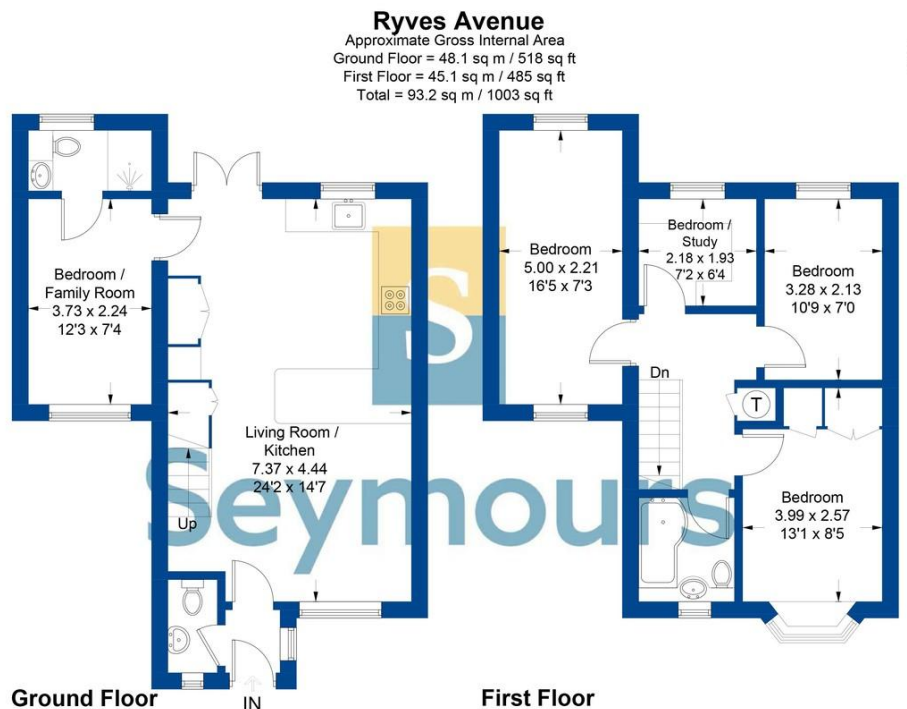

Illustration for identification purposes only, measurements are approximate, not to scale. FloorplansUsketch.com © 2024 (ID1083002)