



Seymours



# Frogmore Park Drive Camberley, GU17 0PJ £620,000

Arrange a viewing: 01276 534100

## Property Details

 5 bedrooms

 2 baths

 EPC Rating TBC

 1706 sqft

 Station Name (0.0 miles)

- Detached chalet
- Large south facing rear garden
- Five bedrooms
- Large living room with access onto rear garden
- Kitchen breakfast room
- Two bathrooms
- Driveway leading to detached garage
- Convenient for Blackwater and the shops, amenities and railway station

A well presented detached chalet which benefits from a large southerly facing rear garden as well as plenty of driveway parking leading to a detached garage. The property offers well proportioned and flexible living space with a large Living room having access out on to the patio and sunny aspect garden. There is also a kitchen breakfast room. To the front of the property are two bedrooms which could easily serve as a study and TV room if required. There is also a downstairs shower room. Upstairs are two spacious double bedrooms and a bathroom. The home is conveniently located on this popular road which is close to Blackwater shops and amenities as well as the railway station. The area is well served by good local schools as well as attractive countryside and excellent road links nearby.

[01276 534100](tel:01276534100) / [james@seymours-blackwater.co.uk](mailto:james@seymours-blackwater.co.uk)



### Frogmore Park Drive

Approximate Gross Internal Area = 136.8 sq m / 1473 sq ft  
Garage = 21.7 sq m / 233 sq ft  
Total = 158.5 sq m / 1706 sq ft

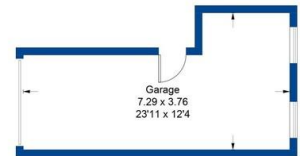

(Not Shown In Actual Location / Orientation)

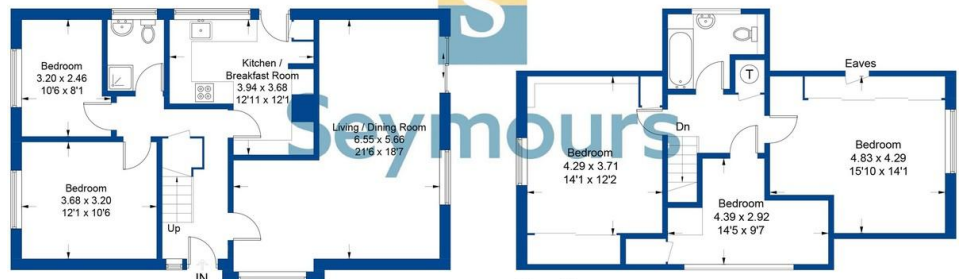

Illustration for identification purposes only, measurements are approximate, not to scale. FloorplansUseketch.com © 2023 (ID993023)