

SILK POINT

MACCLESFIELD CHESHIRE SK10 2BB



RANGE OF SMALL OFFICES SUITES
FLEXIBLE AGREEMENTS
CLOSE TO MACCLESFIELD TOWN CENTRE

SILK POINT

MACCLESFIELD CHESHIRE

DESCRIPTION

Silk Point is a modern two storey office building located on the corner of Queens Avenue and Hulley Road in the historic market town of Macclesfield. With a variety of small suites from 94sq ft on flexible 12-month contracts, the property is ideally suited for growing businesses looking for work space that can adapt to their needs as required.

SPECIFICATION

- Suspended ceilings
- Eight person passenger lift
- Access to meeting room
- Kitchen on each floor
- Secure site with CCTV and 24-hour access control system
- On-site parking
- Gas central heating
- LED Lighting



SILK POINT

MACCLESFIELD CHESHIRE

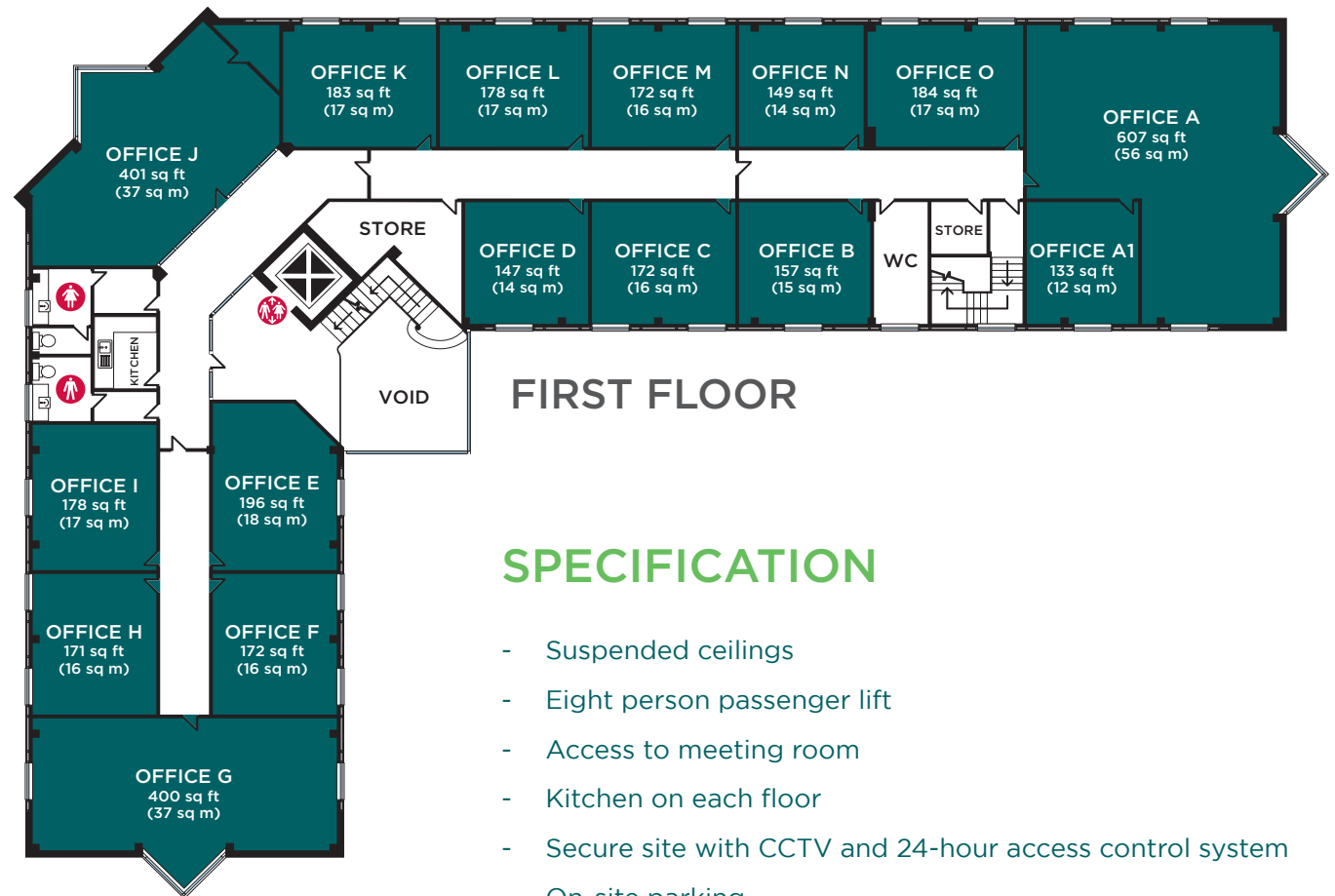

SPECIFICATION

- Suspended ceilings
- Eight person passenger lift
- Access to meeting room
- Kitchen on each floor
- Secure site with CCTV and 24-hour access control system
- On-site parking
- Gas central heating
- LED Lighting

MACCLESFIELD Town Centre



Bus Depot

TO LEEK & STOKE-ON-TRENT



Arighi Bianchi
MACCLESFIELD

TESCO

BARRICKS MILL



KFC

bm



Sainsbury's

A523
Silk Road

SILK POINT

Queens Avenue

Hulley Road

Wickes



TAPE

C E F



DOORCO
CORPORATE DOORS

AstraZeneca
MACCLESFIELD

TO STOCKPORT & MANCHESTER

SAT NAV: SK10 2BB

TRAINS

Macclesfield Train Station

5 minutes drive or 20 minutes walk

Direct trains to London Euston - Every hour

Direct trains to Manchester - Every 20 minutes

AIRPORT

Manchester Airport - 30 minutes drive

With over 200 destinations worldwide

BUS

Bus service to Macclesfield Bus Station runs every half hour

MOTORWAYS

M60 - Approximately 35 minutes drive

M56 - Approximately 40 minutes drive

M6 - Approximately 45 minutes drive

Manchester City Centre - 50 minutes drive