

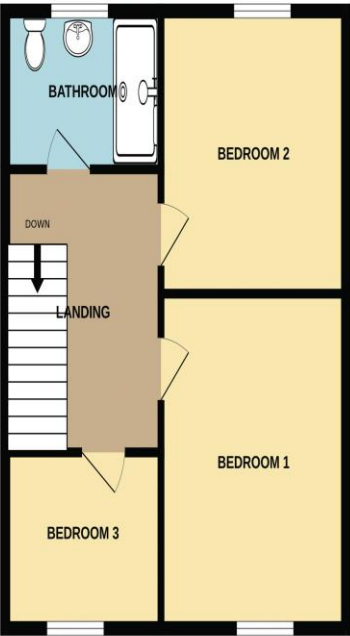

GROUND FLOOR

1ST FLOOR

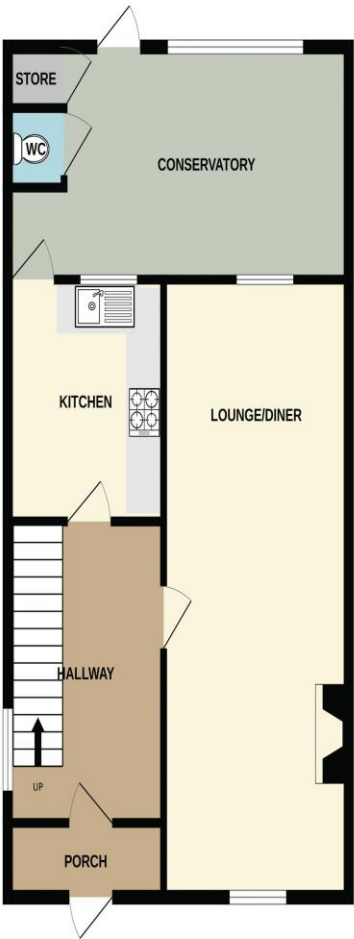

Whilst every attempt has been made to ensure the accuracy of the floorplan contained here, measurements of doors, windows, rooms and any other items are approximate and no responsibility is taken for any error, omission or mis-statement. This plan is for illustrative purposes only and should be used as such by any prospective purchaser. The services, systems and appliances shown have not been tested and no guarantee as to their operability or efficiency can be given.
Made with Mensopix ©2023

Wainwright Estates
10 The Precinct, London Road
Waterlooville, Hampshire PO7 7DT

Tel: 02392 264500
Email: sales@wainwrightestates.co.uk
www.wainwrightestates.co.uk

13 Prinsted Crescent

Portsmouth PO6 1NS

Price: £330,000

DESCRIPTION

This well presented Three bedroom semi detached property is located in the ever popular location of Farlington in Portsmouth. Internally the property boasts a spacious lounge/diner, modern fitted kitchen and handy downstairs w/c. Upstairs you will find three bedrooms and a wet room. Outside there is a low maintenance rear garden and private driveway and garage. Additional benefits come in the form of the property being fully double glazed and gas central heated. Council tax band C.

ACCOMMODATION

LOUNGE 24' 9" x 10' 9" (7.54m x 3.27m)

KITCHEN 9' 1" x 9' 8" (2.77m x 2.94m)

CONSERVATORY 11' 8" x 9' 5" (3.55m x 2.87m)

HALLWAY

BEDROOM 1 13' 5" x 9' 7" (4.09m x 2.92m)

BEDROOM 2 10' 9" x 11' 1" (3.27m x 3.38m)

BEDROOM 3 9' 8" x 7' 0" (2.94m x 2.13m)

BATHROOM



OUTSIDE

Front & Rear Garden

Driveway

