

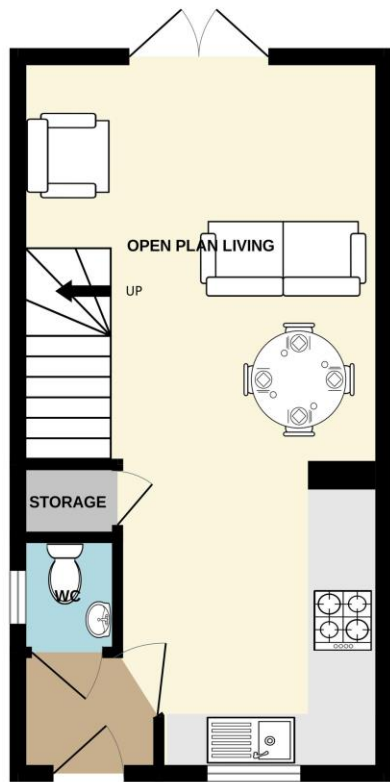

GROUND FLOOR
318 sq.ft. (29.5 sq.m.) approx.

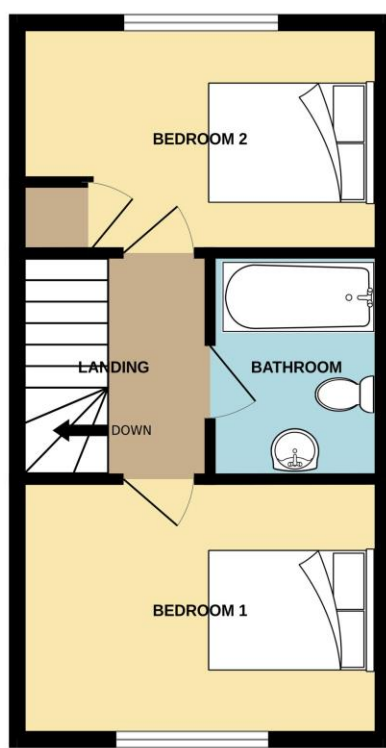

1ST FLOOR
320 sq.ft. (29.7 sq.m.) approx.



TOTAL FLOOR AREA: 638 sq.ft. (59.3 sq.m.) approx.
 Whilst every attempt has been made to ensure the accuracy of the floorplan contained here, measurements of doors, windows, rooms and any other items are approximate and no responsibility is taken for any error, omission or mis-statement. This plan is for illustrative purposes only and should be used as such by any prospective purchaser. The services, systems and appliances shown have not been tested and no guarantee as to their operability or efficiency can be given.
 Made with Metropix ©2024.

Denford, Pebble Walk, Sinah Lane

Hayling Island PO11 0EY

Price: £295,000

DESCRIPTION

Situated on the Pebble Walk Development 'The Denford' is a modern, open plan TWO DOUBLE BEDROOM Home situated in West Hayling Island. On entering the property step through the lobby and into the flexible downstairs space, which combines LIVING, DINING AND KITCHEN space. This versatile room benefits from natural light thanks to the 'French' doors which open out onto your rear garden. There is also a handy downstairs w/c which adds additional convenience. Upstairs you will find Two double bedrooms and a modern bathroom suite. Outside you will find two allocated parking spaces side by side and a rear garden with shed for outdoor storage. Incentives and upgrades available! On leaving the property you can take the short stroll to the local shops and amenities in West Town or take a leisurely stroll along the coastline Billy Trail. The beach and Hayling's Links Golf Course are also just a short distance away.

ACCOMMODATION

ENTRANCE HALL

WC

OPEN PLAN KITCHEN/DINING/LOUNGE: 23' 8" x 12' 11" (7.21m x 3.93m)

FIRST FLOOR

BEDROOM 1: 12' 11" x 7' 11" (3.93m x 2.41m)

BATHROOM: 6' 0" x 6' 4" (1.83m x 1.93m)

BEDROOM 2: 12' 11" x 8' 10" (3.93m x 2.69m)



OUTSIDE

REAR GARDEN

DRIVEWAY

