

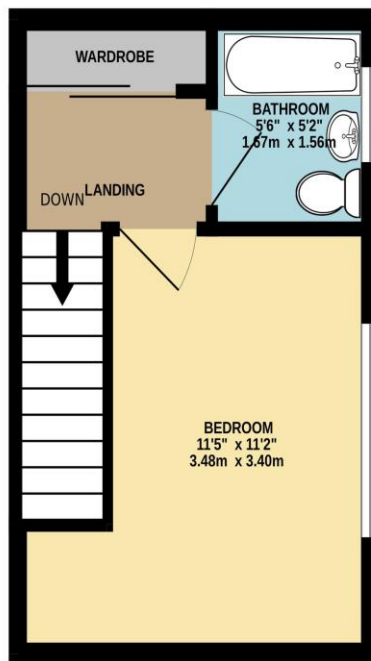

GROUND FLOOR
201 sq.ft. (18.7 sq.m.) approx.

1ST FLOOR
190 sq.ft. (17.6 sq.m.) approx.

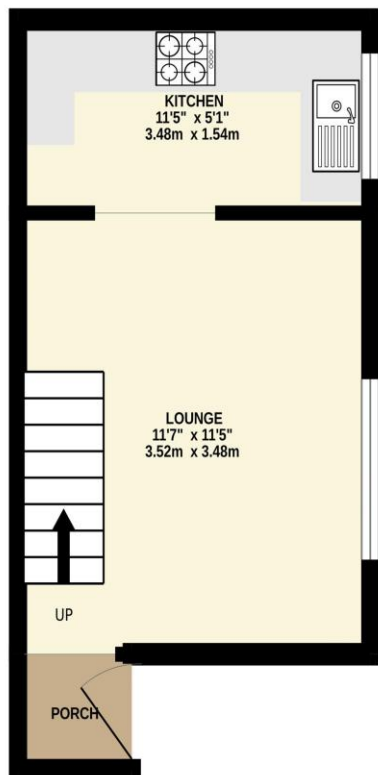

TOTAL FLOOR AREA: 391 sq.ft. (36.3 sq.m.) approx.

Whilst every attempt has been made to ensure the accuracy of the floorplan contained here, measurements of doors, windows, rooms and any other items are approximate and no responsibility is taken for any error, omission or mis-statement. This plan is for illustrative purposes only and should be used as such by any prospective purchaser. The services, systems and appliances shown have not been tested and no guarantee as to their operability or efficiency can be given.

Made with Metropix ©2024

Wainwright Estates

10 The Precinct, London Road
Waterlooville, Hampshire PO7 7DT

Tel: 02392 264500

Email: sales@wainwrightestates.co.uk
www.wainwrightestates.co.uk

37 Amethyst Grove

Tempest, Waterlooville PO7 8SG

Price: £205,000

DESCRIPTION

Situated on the ever popular Tempest Estate you will come across this One bedroom house with adjacent private GARDEN in Waterlooville, Internally the property has an entrance porch leading into your lounge which then opens into your fitted kitchen. Upstairs you will find fitted wardrobes on the landing a modern bathroom suite and generous sized bedroom. The property also benefits from being fully double glazed, gas central heated and is offered with one allocated parking space.

ACCOMMODATION

PORCH

LOUNGE: 11' 7" x 11' 5" (3.53m x 3.48m)

KITCHEN: 11' 5" x 5' 1" (3.48m x 1.55m)

FIRST FLOOR

BEDROOM: 11' 0" x 8' 2" (3.35m x 2.49m)

BATHROOM: 5' 7" x 5' 2" (1.70m x 1.57m)

LANDING

Built in wardrobes.

OUTSIDE

PRIVATE GARDEN

