

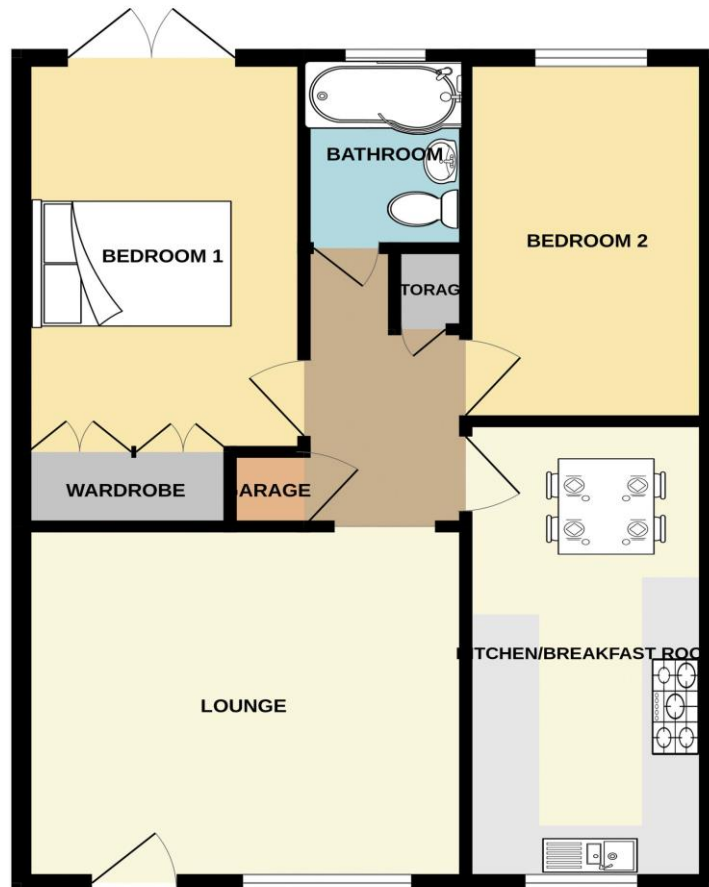

GROUND FLOOR
552 sq.ft. (51.3 sq.m.) approx.



TOTAL FLOOR AREA : 552 sq.ft. (51.3 sq.m.) approx.
 Whilst every attempt has been made to ensure the accuracy of the floorplan contained here, measurements of doors, windows, rooms and any other items are approximate and no responsibility is taken for any error, omission or mis-statement. This plan is for illustrative purposes only and should be used as such by any prospective purchaser. The services, systems and appliances shown have not been tested and no guarantee as to their operability or efficiency can be given.
 Made with Metropix ©2024

Wainwright Estates
 10 The Precinct, London Road
 Waterlooville, Hampshire PO7 7DT

Tel: 02392 264500
 Email: sales@wainwrightestates.co.uk
www.wainwrightestates.co.uk

23 Saxon Close

Clanfield, Waterlooville PO8 0JT

Price: £245,000

DESCRIPTION

Highly unique and rarely available this spacious TWO BEDROOM GROUND FLOOR APARTMENT with its own PRIVATE GARDEN can be found on the outskirts of the village of Clanfield in Hampshire. Internally this generous sized apartment boasts a modern fitted kitchen/breakfast room with integrated slimline dishwasher and space for a fridge/freezer and washing machine, there's also a separate lounge. The master bedroom has patio doors leading to your private and secluded wrap around garden which would be an ideal place to entertain on those summer evenings. The property also has an additional double bedroom and modern fitted bathroom. Additional benefits come in the form of two internal storage cupboards, an external storage cupboard, double glazing, gas central heating and the property is offered with extremely reasonable ground rent and maintenance charges. High levels of interest are expected on this property so dont delay and book your viewing today.

ACCOMMODATION

LOUNGE: 11' 9" x 11' 3" (3.58m x 3.43m)

KITCHEN/BREAKFAST ROOM: 15' 3" x 7' 2" (4.64m x 2.18m)

BEDROOM 1: 13' 0" x 9' 1" (3.96m x 2.77m)
Built in wardrobes.

BEDROOM 2: 12' 0" x 7' 2" (3.65m x 2.18m)

BATHROOM: 6' 3" x 4' 9" (1.90m x 1.45m)



OUTSIDE

PRIVATE REAR GARDEN

STORAGE CUPBOARD TO FRONT.

LEASE INFORMATION

Lease: 106 Year remaining.

Ground Rent: £10 per year.

Service Charge: Approximately £100 per year.

