

These particulars are believed to be accurate but they are not guaranteed and do not form a contract. Neither Jordan Fishwick nor the vendor or lessor accept any responsibility in respect of these particulars, which are not intended to be statements or representations of fact and any intending purchaser or lessee must satisfy himself by inspection or otherwise as to the correctness of each of the statements contained in these particulars. Any floorplans on this brochure are for illustrative purposes only and are not necessarily to scale.

Whilst every attempt has been made to ensure the accuracy of the floorplan contained herein, measurements of doors, windows, rooms and other items are approximate and no responsibility is taken for any error or omission or mis-statement. This plan is for illustrative purposes only and should be used as such by any prospective purchaser. The services, fixtures and appliances shown here and when tested and no guarantee as to their operation or efficiency can be given. Made with Blueprints 10/2025

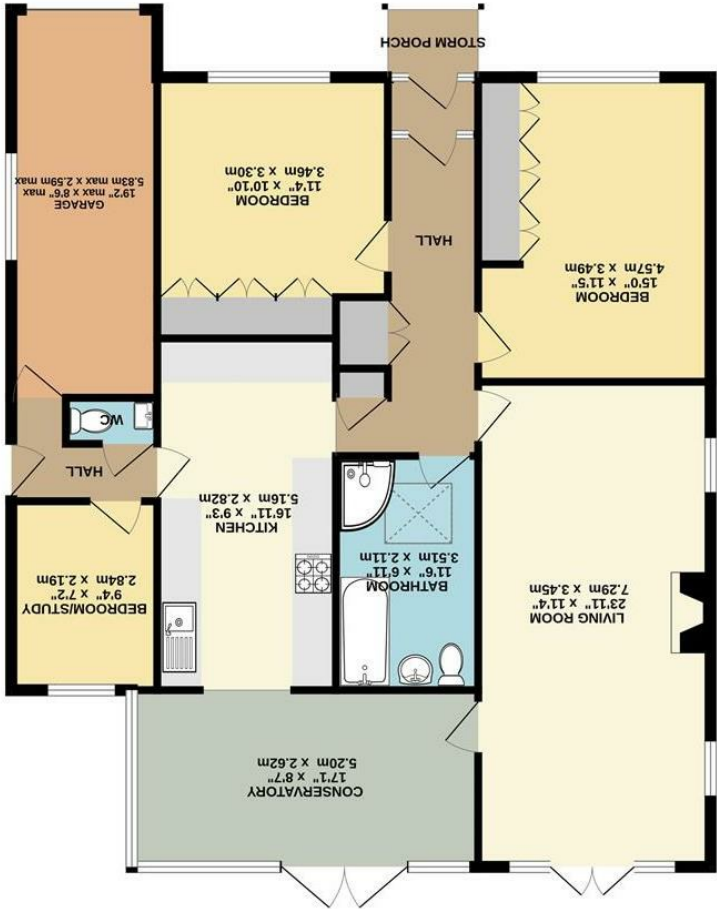

GROUND FLOOR







51 Cromley Road, High Lane,  
Stockport, SK6 8BU

£450,000



The Property

Occupying an enviable position within a sought after, established residential area in High Lane, an extended three bedroom detached bungalow. Brick paved driveway, attached garage and enclosed, private beautiful gardens with Summerhouse. Spacious, well presented accommodation with pvc double glazing, gas central heating and comprising: storm porch, porch, hallway, 23ft living room, conservatory, fitted kitchen, two double bedrooms with fitted wardrobes, re-fitted contemporary bathroom with separate shower, bedroom three/study and second wc. Useful loft space. No Chain and Viewing highly recommended.



- Extended Detached Bungalow
- Sought After Location
- Three Bedrooms
- Enclosed Gardens With Summerhouse
- 23ft Living Room
- Re-fitted Bathroom
- Attached Garage and Driveway Parking
- Well Presented
- No Chain

Postcode - SK6 8BU  
EPC Rating - D  
Local Authority - Stockport  
Council Tax - E

