



jordan fishwick

Hollinwood Road Disley Stockport



Hollinwood Road Disley Stockport SK12 2EG

£325,000



The Property

Conveniently positioned within an established and extremely sought after area in Disley Village, a superbly presented, brick-built end of terrace property. Arranged over three floors and boasting delightful private gardens with gravel patio area, complimented by a walled frontage, off road parking and a car port. This deceptive and charming character home consists of: vestibule, living room with wood burning stove, separate dining room, fitted kitchen, two first floor bedrooms, bathroom with white suite and a second floor bedroom with wc. Pvc double glazing and gas central heating. Viewing highly recommended.



- Charming Period End Of Terrace
- Three Bedrooms
- Driveway Parking With Carport
- Enclosed Private Gardens
- Wood Burning Stove
- Arranged Over Three Floors
- Convenient For Disley Village Amenties
- Living Room Plus Dining Room

Postcode SK12 2EG
 EPC Rating D
 Local Authority Cheshire East
 Council Tax B

| Energy Efficiency Rating | | |
|--|-----------|---|
| | Current | Potential |
| <i>Very energy efficient - lower running costs</i> | | |
| (92 plus) A | 68 | 86 |
| (81-91) B | | |
| (69-80) C | | |
| (55-68) D | | |
| (39-54) E | | |
| (21-38) F | | |
| (1-20) G | | |
| <i>Not energy efficient - higher running costs</i> | | |
| England & Wales | | EU Directive 2002/91/EC  |



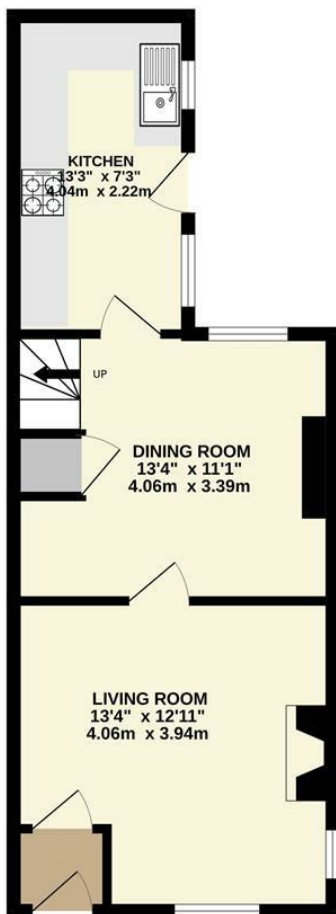

GROUND FLOOR

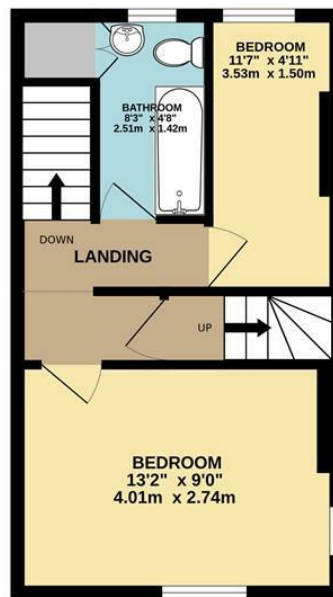

1ST FLOOR

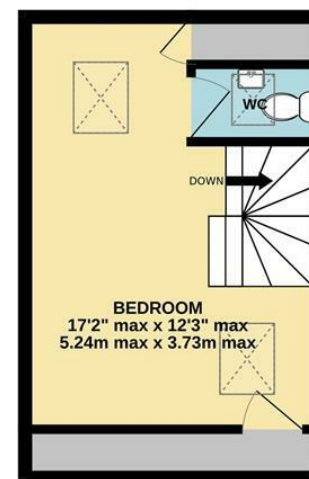

2ND FLOOR

Whilst every attempt has been made to ensure the accuracy of the floorplan contained here, measurements of doors, windows, rooms and any other items are approximate and no responsibility is taken for any error, omission or mis-statement. This plan is for illustrative purposes only and should be used as such by any prospective purchaser. The services, systems and appliances shown have not been tested and no guarantee as to their operability or efficiency can be given.
Made with Metropix ©2025



These particulars are believed to be accurate but they are not guaranteed and do not form a contract. Neither Jordan Fishwick nor the vendor or lessor accept any responsibility in respect of these particulars, which are not intended to be statements or representations of fact and any intending purchaser or lessee must satisfy himself by inspection or otherwise as to the correctness of each of the statements contained in these particulars. Any floorplans on this brochure are for illustrative purposes only and are not necessarily to scale.

Offices at: Chorlton, Didsbury, Disley, Hale, Glossop, Macclesfield, Manchester Deansgate, Manchester Whitworth Street, New Mills, Sale, Wilmslow and Withington

14 Market St, Disley, Cheshire, Stockport SK12 2AA

01663 767878

disley@jordanfishwick.co.uk

www.jordanfishwick.co.uk