



jordan fishwick

Park Crescent Furness Vale High Peak



Park Crescent Furness Vale High Peak SK23 7PU

Guide Price £250,000



The Property

NO CHAIN. Located on a quiet cul-de-sac and set above Furness Vale centre is this three bedroom semi detached property on Park Crescent. With its positioning at the head of the cul-de-sac there is a generous garden plot and driveway with rear access from Charlesworth Road. The property in brief comprises a generous entrance hallway with access to all downstairs areas; Two reception rooms, kitchen and WC. The kitchen also provides access to the rear with a stepped porch area leading to the garden. To the first floor the property has three well sized bedrooms, a WC with a separate two piece bathroom (bath/shower and sink). The rear has a double storey extension resulting in generous sizing, with the added space to the master bedroom there is potential to create an ensuite. Viewing highly recommended.



- No Chain
- Three Bedrooms
- Cul-De-Sac location
- Rear Access Driveway
- Garden To Three Aspects
- Great Transport Links
- Nearby Open Country Side
- Previously Extended

Postcode

SK23 7PU

EPC Rating

C

Local Authority

High Peak

Council Tax

C

Energy Efficiency Rating		
	Current	Potential
Very energy efficient - lower running costs		
(92 plus) A		
(81-91) B		84
(69-80) C	70	
(55-68) D		
(39-54) E		
(21-38) F		
(1-20) G		
Not energy efficient - higher running costs		
England & Wales	EU Directive 2002/91/EC	



GROUND FLOOR

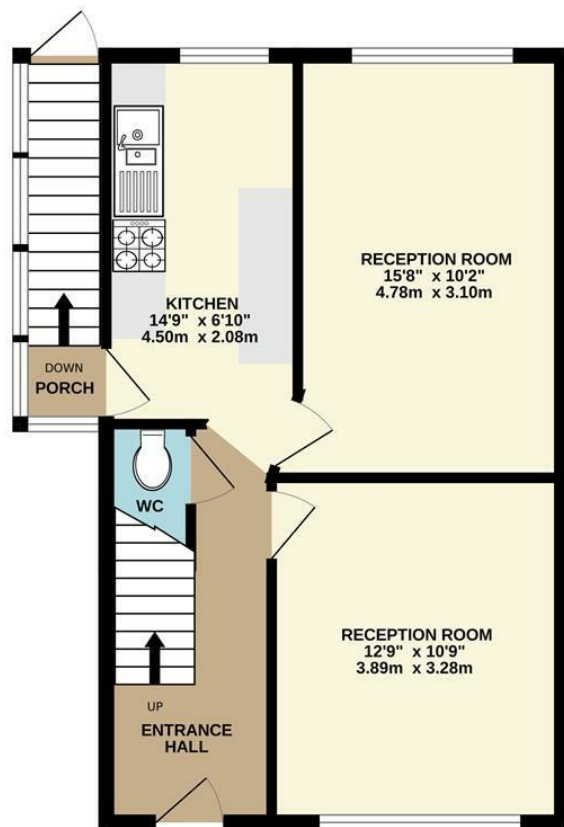

1ST FLOOR

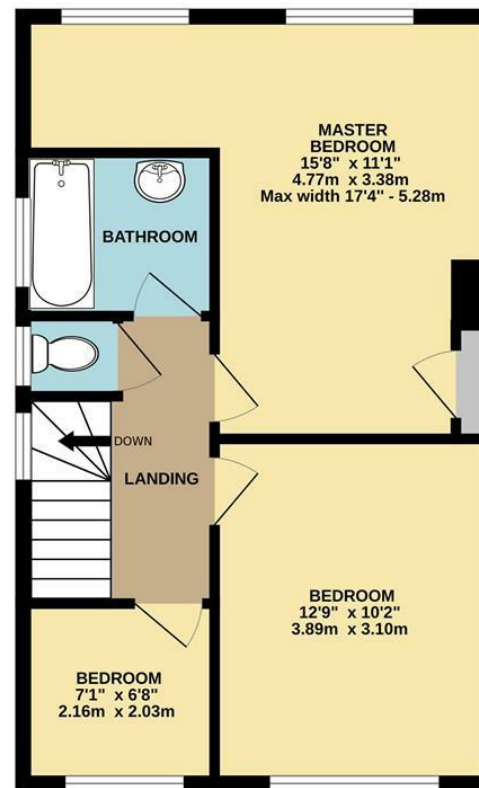

Whilst every attempt has been made to ensure the accuracy of the floorplan contained here, measurements of doors, windows, rooms and any other items are approximate and no responsibility is taken for any error, omission or mis-statement. This plan is for illustrative purposes only and should be used as such by any prospective purchaser. The services, systems and appliances shown have not been tested and no guarantee as to their operability or efficiency can be given.
Made with Metropix ©2025



These particulars are believed to be accurate but they are not guaranteed and do not form a contract. Neither Jordan Fishwick nor the vendor or lessor accept any responsibility in respect of these particulars, which are not intended to be statements or representations of fact and any intending purchaser or lessee must satisfy himself by inspection or otherwise as to the correctness of each of the statements contained in these particulars. Any floorplans on this brochure are for illustrative purposes only and are not necessarily to scale.

Offices at: Chorlton, Didsbury, Disley, Hale, Glossop, Macclesfield, Manchester Deansgate, Manchester Whitworth Street, New Mills, Sale, Wilmslow and Withington

14 Market St, Disley, Cheshire, Stockport SK12 2AA

01663 767878

disley@jordanfishwick.co.uk
www.jordanfishwick.co.uk