



jordan fishwick

Bridgemont Whaley Bridge High Peak



Bridgemont Whaley Bridge High Peak SK23 7PD

£190,000



The Property

Well presented throughout! A spacious, stone built, three bedroom mid terraced home. Offered for sale with no chain, this fabulous property offers excellent value for the size of accommodation. Convenient position and close to a children's park, this perfect first time buy or starter family home, has to be viewed. Pvc double glazing, gas central heating and paved rear garden. Comprising: vestibule, living room with feature stone fireplace, re-fitted dining kitchen, store room, breakfast area, ground floor bathroom and three first floor bedrooms.



- Well Presented and Ready to Walk Into
- Three Bedrooms
- Stone Built Cottage
- Convenient Location
- No Chain
- Contemporary Kitchen and Bathroom
- Pvc Double Glazing and Gas Central Heating
- Close to a Childrens Park

Postcode

SK23 7PD

EPC Rating

Local Authority

High Peak

Council Tax

A

Energy Efficiency Rating		
	Current	Potential
Very energy efficient - lower running costs		
(92 plus) A		
(81-91) B		
(69-80) C		
(55-68) D		
(39-54) E		
(21-38) F		
(1-20) G		
Not energy efficient - higher running costs		
England & Wales	EU Directive 2002/91/EC 	



GROUND FLOOR

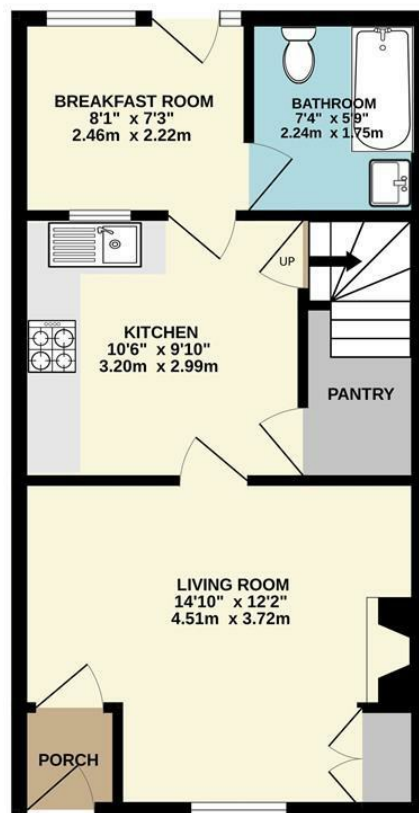

1ST FLOOR

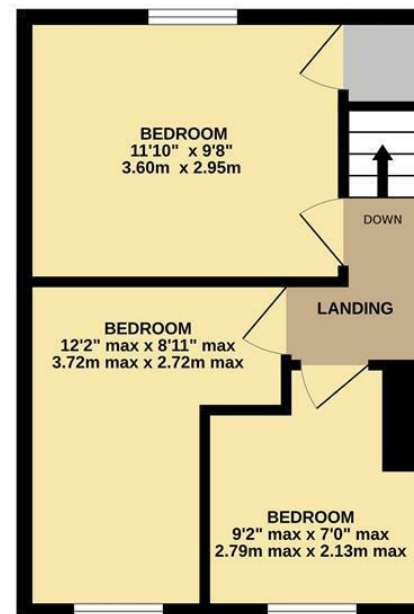

Whilst every attempt has been made to ensure the accuracy of the floorplan contained here, measurements of doors, windows, rooms and any other items are approximate and no responsibility is taken for any error, omission or mis-statement. This plan is for illustrative purposes only and should be used as such by any prospective purchaser. The services, systems and appliances shown have not been tested and no guarantee as to their operability or efficiency can be given.
Made with Metropix ©2025



These particulars are believed to be accurate but they are not guaranteed and do not form a contract. Neither Jordan Fishwick nor the vendor or lessor accept any responsibility in respect of these particulars, which are not intended to be statements or representations of fact and any intending purchaser or lessee must satisfy himself by inspection or otherwise as to the correctness of each of the statements contained in these particulars. Any floorplans on this brochure are for illustrative purposes only and are not necessarily to scale.

Offices at: Chorlton, Didsbury, Disley, Hale, Glossop, Macclesfield, Manchester Deansgate, Manchester Whitworth Street, New Mills, Sale, Wilmslow and Withington

14 Market St, Disley, Cheshire, Stockport SK12 2AA

01663 767878

disley@jordanfishwick.co.uk

www.jordanfishwick.co.uk