



jordan fishwick

Reddish Avenue Whaley Bridge High Peak



Reddish Avenue Whaley Bridge High Peak SK23 7DP

£375,000



The Property

Standing on nearly 1/3 of an acre plot in Whaley Bridge with fabulous gardens, ample parking and a detached double garage, a 1920's bay-fronted semi-detached property. Offering fantastic potential, this superb, extended home offers the next owner an amazing opportunity to make their mark. Situated within an established and popular location off Macclesfield Road in Whaley Bridge and comprising: entrance hall, garden room, shower room, living room, dining room, kitchen, store rooms, utility porch, three generous first floor bedrooms (smallest 11'0 x 9'8), second shower room and separate wc. Viewing highly recommended.



- Fantastic Third of an Acre Plot
- Beautiful Gardens, lots of Parking and Detached Double Garage
- Three Generous Bedrooms
- 1920's Built Bay Fronted Semi Detached
- Feature Fireplaces
- Popular, Convenient Location
- Potential to Extend Further (subject to P/P)
- Well Presented

Postcode

SK23 7DP

EPC Rating

Local Authority

High Peak

Council Tax

C

| Energy Efficiency Rating | | |
|---|---|-----------|
| | Current | Potential |
| Very energy efficient - lower running costs | | |
| (92 plus) A | | |
| (81-91) B | | |
| (69-80) C | | |
| (55-68) D | | |
| (39-54) E | | |
| (21-38) F | | |
| (1-20) G | | |
| Not energy efficient - higher running costs | | |
| England & Wales | EU Directive 2002/91/EC  | |



GROUND FLOOR

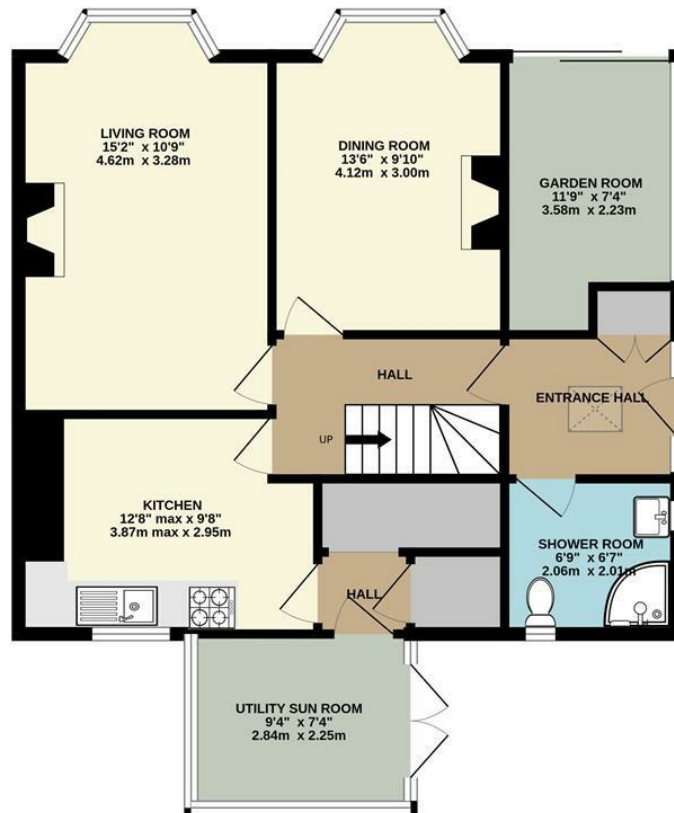

1ST FLOOR

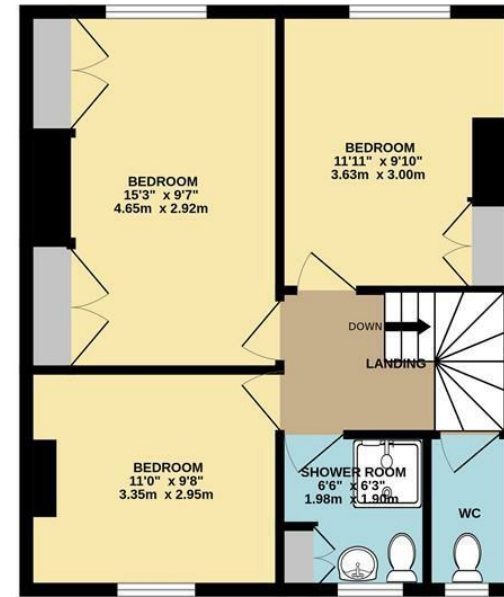

Whilst every attempt has been made to ensure the accuracy of the floorplan contained here, measurements of doors, windows, rooms and any other items are approximate and no responsibility is taken for any error, omission or mis-statement. This plan is for illustrative purposes only and should be used as such by any prospective purchaser. The services, systems and appliances shown have not been tested and no guarantee as to their operability or efficiency can be given.
Made with Metropix ©2025



These particulars are believed to be accurate but they are not guaranteed and do not form a contract. Neither Jordan Fishwick nor the vendor or lessor accept any responsibility in respect of these particulars, which are not intended to be statements or representations of fact and any intending purchaser or lessee must satisfy himself by inspection or otherwise as to the correctness of each of the statements contained in these particulars. Any floorplans on this brochure are for illustrative purposes only and are not necessarily to scale.

Offices at: Chorlton, Didsbury, Disley, Hale, Glossop, Macclesfield, Manchester Deansgate, Manchester Whitworth Street, New Mills, Sale, Wilmslow and Withington

14 Market St, Disley, Cheshire, Stockport SK12 2AA

01663 767878

disley@jordanfishwick.co.uk

www.jordanfishwick.co.uk