



jordan fishwick

Buxton Road Whaley Bridge High Peak



Buxton Road Whaley Bridge High Peak SK23 7HX

£230,000



The Property

Ready to walk into and guaranteed to impress! A stunning and charming two bedroom, stone-built end of terrace in a popular and convenient position in Whaley Bridge. Perfect for First Time Buyers, this beautiful home has been updated and improved in recent years, has a wood burning stove and comprises: living room, re-fitted dining kitchen, two first floor bedrooms and a contemporary bathroom. Pvc double glazing, gas central heating with combination boiler and a delightful low maintenance garden which doubles up as an area to park off road. Viewing highly recommended.



- Beautifully Presented
- Perfect For First Time Buyers
- Stone End Of Terrace
- Two Bedrooms
- Enclosed Garden Doubling as Off Road Parking
- Pvc Double Glazing and Gas Central Heating
- Convenient Popular Location
- Re-fitted Kitchen and Bathroom
- Wood Burning Stove

Postcode

SK23 7HX

EPC Rating

D

Local Authority

High Peak

Council Tax

A

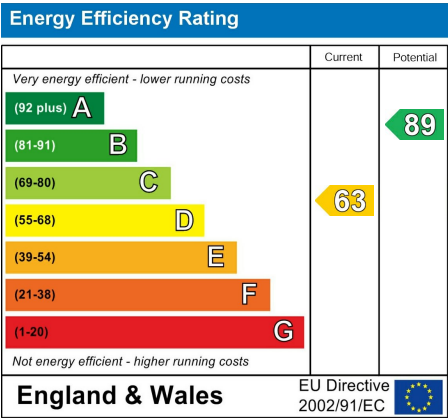

GROUND FLOOR

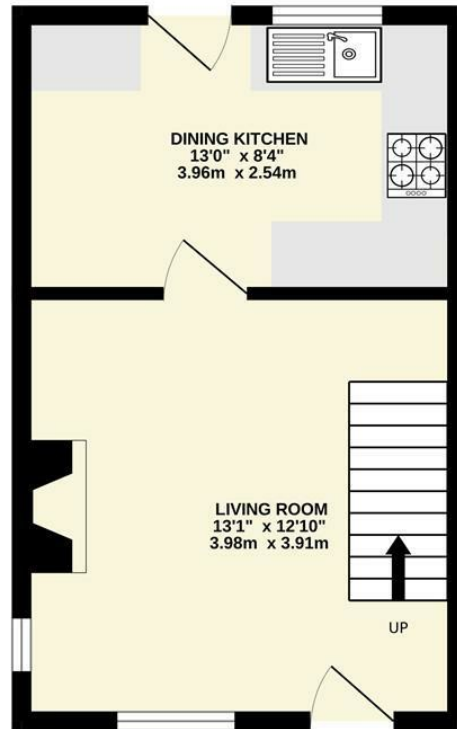

1ST FLOOR

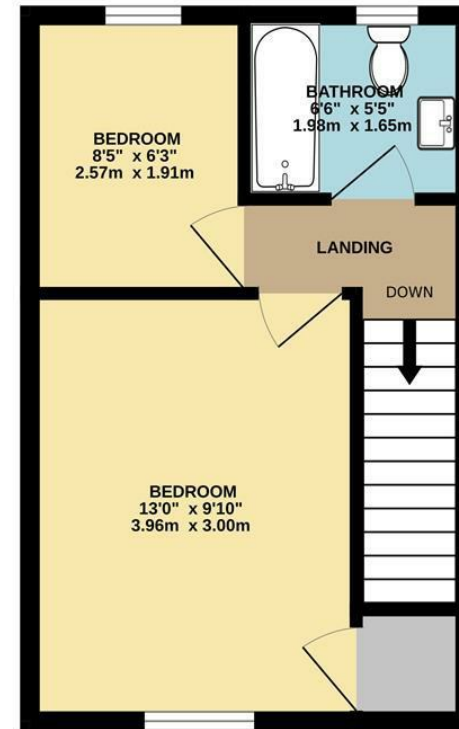

Whilst every attempt has been made to ensure the accuracy of the floorplan contained here, measurements of doors, windows, rooms and any other items are approximate and no responsibility is taken for any error, omission or mis-statement. This plan is for illustrative purposes only and should be used as such by any prospective purchaser. The services, systems and appliances shown have not been tested and no guarantee as to their operability or efficiency can be given.
Made with Metropix ©2025



These particulars are believed to be accurate but they are not guaranteed and do not form a contract. Neither Jordan Fishwick nor the vendor or lessor accept any responsibility in respect of these particulars, which are not intended to be statements or representations of fact and any intending purchaser or lessee must satisfy himself by inspection or otherwise as to the correctness of each of the statements contained in these particulars. Any floorplans on this brochure are for illustrative purposes only and are not necessarily to scale.

Offices at: Chorlton, Didsbury, Disley, Hale, Glossop, Macclesfield, Manchester Deansgate, Manchester Whitworth Street, New Mills, Sale, Wilmslow and Withington

14 Market Street, Disley, Cheshire, SK12 2AA

01663 76 78 78

disley@jordanfishwick.co.uk

www.jordanfishwick.co.uk