



jordan fishwick

Storey Road Disley Stockport



Storey Road Disley Stockport SK12 2BF

£330,000



The Property

Situated on the popular Waters Edge development in Disley, a very well presented, 2015 built, three bedroom semi-detached home. Extended and improved in recent years with a well stocked SOUTH FACING rear garden. Parking for two cars, high energy efficiency with pvc double glazing and gas central heating. Special mention for the STUNNING open plan living dining kitchen with bi fold door! Also comprising: entrance hall, wc, living room, first floor master bedroom with ensuite, two further bedrooms and a family bathroom. Private patio, tiered garden and upper graveled area with fabulous views. Viewing essential.



- Recently Extended
- Stunning Open Plan Living Dining Kitchen
- Three Bedroom Semi-Detached
- Popular Modern Development
- Convenient For Disley Village
- South Facing Garden With Views
- En-Suite Shower Room
- Parking For Two Cars
- High Energy Efficiency

Postcode SK12 2BF
EPC Rating B
Local Authority Cheshire East
Council Tax C

Energy Efficiency Rating		
	Current	Potential
Very energy efficient - lower running costs		
(92 plus) A		95
(81-91) B	82	
(69-80) C		
(55-68) D		
(39-54) E		
(21-38) F		
(1-20) G		
Not energy efficient - higher running costs		
England & Wales	EU Directive 2002/91/EC	



GROUND FLOOR

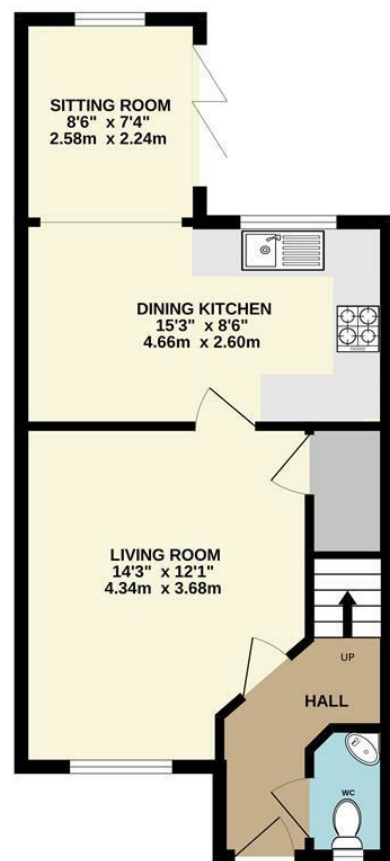

1ST FLOOR

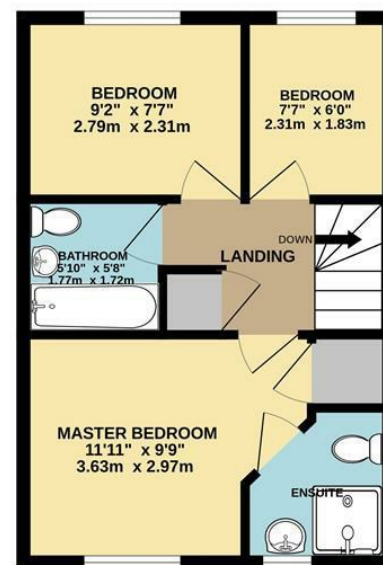

Whilst every attempt has been made to ensure the accuracy of the floorplan contained here, measurements of doors, windows, rooms and any other items are approximate and no responsibility is taken for any error, omission or mis-statement. This plan is for illustrative purposes only and should be used as such by any prospective purchaser. The services, systems and appliances shown have not been tested and no guarantee as to their operability or efficiency can be given.
Made with Metropix ©2025



These particulars are believed to be accurate but they are not guaranteed and do not form a contract. Neither Jordan Fishwick nor the vendor or lessor accept any responsibility in respect of these particulars, which are not intended to be statements or representations of fact and any intending purchaser or lessee must satisfy himself by inspection or otherwise as to the correctness of each of the statements contained in these particulars. Any floorplans on this brochure are for illustrative purposes only and are not necessarily to scale.

Offices at: Chorlton, Didsbury, Disley, Hale, Glossop, Macclesfield, Manchester Deansgate, Manchester Whitworth Street, New Mills, Sale, Wilmslow and Withington

14 Market Street, Disley, Cheshire, SK12 2AA

01663 76 78 78

disley@jordanfishwick.co.uk

www.jordanfishwick.co.uk