



*jordan fishwick*

Buxton Road Whaley Bridge High Peak





## Buxton Road Whaley Bridge High Peak SK23 7JE

£299,950



### The Property

Set back from the road behind a generous landscaped garden, a superbly presented three double bedroom end of terrace which has been extended over time to create a wonderful home. Conveniently located in Whaley Bridge, this beautiful home is guaranteed to impress. Pvc double glazing, gas central heating and comprising: Entrance hall, living room with wood burning stove which is open to a spacious dining room. The open plan kitchen has benefitted from the extension to the rear. Creating a sunroom with downstairs w.c and washing facilities. To the first floor are two double bedrooms and spacious bathroom with a free-standing bath and separate shower cubicle. To the second floor is the truly impressive third bedroom, a loft conversion which is a naturally bright room benefiting from 'Velux' windows and boasting eaves storage. Externally, the rear outdoor space offers a lovely quiet place to enjoy the tranquil area benefitting from its Southerly facing aspect. Viewings via appointment only.





- Three Double Bedroomed Property
- Extended End Terrace
- Beautiful Loft Conversion
- Landscaped Garden to The Front Aspect
- Extended Kitchen
- Downstairs W.C
- Accommodation Over Three Floors

Postcode SK23 7JE  
 EPC Rating  
 Local Authority High Peak  
 Council Tax B

Energy Efficiency Rating		
	Current	Potential
Very energy efficient - lower running costs		
(92 plus) A		
(81-91) B		
(69-80) C		
(55-68) D		
(39-54) E		
(21-38) F		
(1-20) G		
Not energy efficient - higher running costs		
England & Wales	EU Directive 2002/91/EC 	





GROUND FLOOR

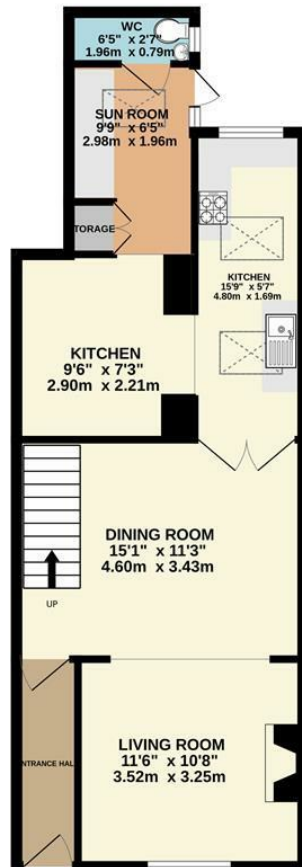

1ST FLOOR



2ND FLOOR

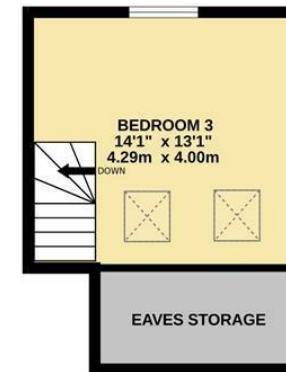

Whilst every attempt has been made to ensure the accuracy of the floorplan contained here, measurements of doors, windows, rooms and any other items are approximate and no responsibility is taken for any error, omission or mis-statement. This plan is for illustrative purposes only and should be used as such by any prospective purchaser. The services, systems and appliances shown have not been tested and no guarantee as to their operability or efficiency can be given.  
Made with Metropix ©2024



These particulars are believed to be accurate but they are not guaranteed and do not form a contract. Neither Jordan Fishwick nor the vendor or lessor accept any responsibility in respect of these particulars, which are not intended to be statements or representations of fact and any intending purchaser or lessee must satisfy himself by inspection or otherwise as to the correctness of each of the statements contained in these particulars. Any floorplans on this brochure are for illustrative purposes only and are not necessarily to scale.

Offices at: Chorlton, Didsbury, Disley, Hale, Glossop, Macclesfield, Manchester Deansgate, Manchester Whitworth Street, New Mills, Sale, Wilmslow and Withington

14 Market Street, Disley, Cheshire, SK12 2AA

**01663 76 78 78**

[disley@jordanfishwick.co.uk](mailto:disley@jordanfishwick.co.uk)

[www.jordanfishwick.co.uk](http://www.jordanfishwick.co.uk)