



jordan fishwick

Homestead Way Chapel-en-le-frith High Peak



Homestead Way Chapel-en-le-frith High Peak SK23 0DA

£285,000



The Property

Adjoining open farmland and boasting fabulous forward views towards Eccles Pike, a Barratt built four bedroom semi-detached property. Located on a popular small modern development in Chapel-en-le-frith and In need of some updating. No Chain, pvc double glazing and gas central heating. Comprising: entrance hall, ground floor wc, 18ft living room, fitted dining kitchen, additional conservatory, four floor bedrooms and a shower room with Velux skylight. Driveway and manageable gardens with a decked patio overlooking fields. Viewing recommended.



- Adjoining Open Countryside
- Popular Small Development
- Amazing Views
- Convenient Location
- Four Bedrooms
- Useful Conservatory
- Driveway and Garden
- In Need Of Some Updating
- No Chain

Postcode

SK23 0DA

EPC Rating

C

Local Authority

High Peak

Council Tax

D

Energy Efficiency Rating		
	Current	Potential
Very energy efficient - lower running costs		
(92 plus) A		87
(81-91) B		
(69-80) C	73	
(55-68) D		
(39-54) E		
(21-38) F		
(1-20) G		
Not energy efficient - higher running costs		
England & Wales	EU Directive 2002/91/EC 	



GROUND FLOOR

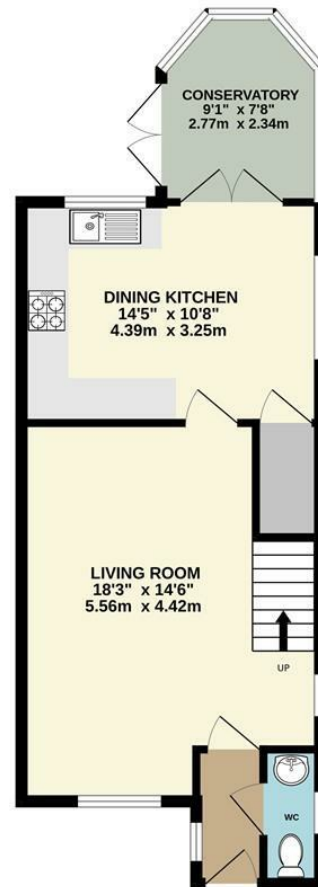

1ST FLOOR

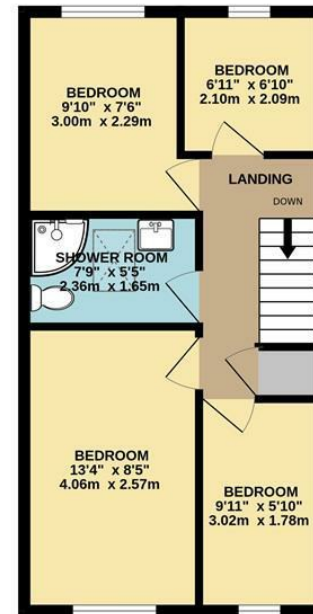

Whilst every attempt has been made to ensure the accuracy of the floorplan contained here, measurements of doors, windows, rooms and any other items are approximate and no responsibility is taken for any error, omission or mis-statement. This plan is for illustrative purposes only and should be used as such by any prospective purchaser. The services, systems and appliances shown have not been tested and no guarantee as to their operability or efficiency can be given.
Made with Metropix ©2024



These particulars are believed to be accurate but they are not guaranteed and do not form a contract. Neither Jordan Fishwick nor the vendor or lessor accept any responsibility in respect of these particulars, which are not intended to be statements or representations of fact and any intending purchaser or lessee must satisfy himself by inspection or otherwise as to the correctness of each of the statements contained in these particulars. Any floorplans on this brochure are for illustrative purposes only and are not necessarily to scale.

Offices at: Chorlton, Didsbury, Disley, Hale, Glossop, Macclesfield, Manchester Deansgate, Manchester Whitworth Street, New Mills, Sale, Wilmslow and Withington

14 Market Street, Disley, Cheshire, SK12 2AA

01663 76 78 78

disley@jordanfishwick.co.uk

www.jordanfishwick.co.uk