



*jordan fishwick*

Buxton Old Road Disley Stockport



# Buxton Old Road Disley Stockport SK12 2BB

£250,000



## The Property

A charming semi-detached cottage located on Buxton Old Road in the village of Disley. This delightful property boasts a prime location in the heart of the village, offering easy access to all local amenities. Upon entering you are greeted by a cosy reception room with feature log burner and access through to the open plan dining/kitchen area. To the first floor off the landing the property offers two bedrooms and a tastefully redesigned shower room with walk-in-shower. Externally the property offers a private and secluded rear yard which is a lovely space for entertaining family and friends. Finally, to the rear of the courtyard is a small outhouse which is currently used a bin store. Viewings of this property are highly recommended and a property not to be missed.





- Walking distance to Disley Village
- Overlooking Fountain Square
- Perfect for First Time Buyers
- Two Generous Bedrooms
- Council Tax Band B
- Semi-Detached Home
- Gas Central Heating
- Double Glazing Throughout

**Postcode** SK12 2BB

**EPC Rating** D

**Local Authority** Cheshire East

**Council Tax** B

Energy Efficiency Rating		Current	Potential
Very energy efficient - lower running costs			
(92 plus) <b>A</b>			<b>84</b>
(81-91) <b>B</b>			
(69-80) <b>C</b>			
(55-68) <b>D</b>		<b>62</b>	
(39-54) <b>E</b>			
(21-38) <b>F</b>			
(1-20) <b>G</b>			
Not energy efficient - higher running costs			
<b>England &amp; Wales</b>		EU Directive 2002/91/EC 	





GROUND FLOOR

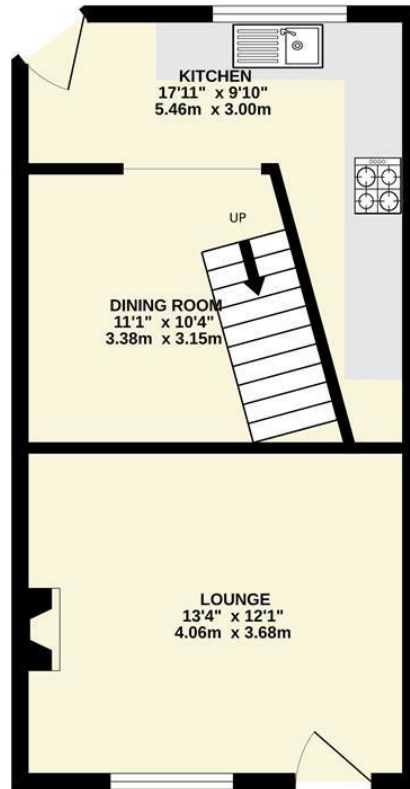

1ST FLOOR

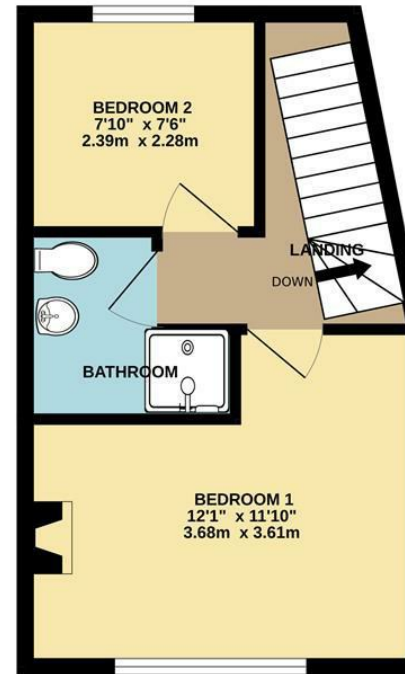

Whilst every attempt has been made to ensure the accuracy of the floorplan contained here, measurements of doors, windows, rooms and any other items are approximate and no responsibility is taken for any error, omission or mis-statement. This plan is for illustrative purposes only and should be used as such by any prospective purchaser. The services, systems and appliances shown have not been tested and no guarantee as to their operability or efficiency can be given.  
Made with Metropix ©2024



These particulars are believed to be accurate but they are not guaranteed and do not form a contract. Neither Jordan Fishwick nor the vendor or lessor accept any responsibility in respect of these particulars, which are not intended to be statements or representations of fact and any intending purchaser or lessee must satisfy himself by inspection or otherwise as to the correctness of each of the statements contained in these particulars. Any floorplans on this brochure are for illustrative purposes only and are not necessarily to scale.

Offices at: Chorlton, Didsbury, Disley, Hale, Glossop, Macclesfield, Manchester Deansgate, Manchester Whitworth Street, New Mills, Sale, Wilmslow and Withington

14 Market Street, Disley, Cheshire, SK12 2AA

01663 76 78 78

disley@jordanfishwick.co.uk

www.jordanfishwick.co.uk