



*jordan fishwick*

Buxton Road Disley Stockport

# Buxton Road Disley Stockport SK12 2RA

Auction Guide £180,000



## The Property

This property is for sale by Modern Method of Auction powered by iamsold LTD - Starting Bid £180,000 + Reservation Fee  
Immaculately presented and boasting spacious, versatile accommodation over three floors, a two bedroom end of terrace. Ideally located for Newtown railway station with direct rail link to Manchester Piccadilly, this stunning home has to be viewed. Pvc double glazing, gas central heating and comprising: open plan living/sitting room, lower ground floor breakfast kitchen, wc/store, boiler room, two first floor bedrooms and a re-fitted contemporary bathroom. Indian stone paved walled garden and perfect for the first time buyer.



- For Sale by Modern Auction
- Subject to Reserve Price & Reservation Fee
- Two Bedrooms
- Open Plan Living Space
- Open Plan Dining Kitchen
- Convenient Location
- Lovely Kitchen and Bathroom
- Enclosed Paved Garden
- Arranged Over Three Floors
- Superb End Of Terrace

**Postcode** SK12 2RA

**EPC Rating** E

**Local Authority** Cheshire East

**Council Tax** B

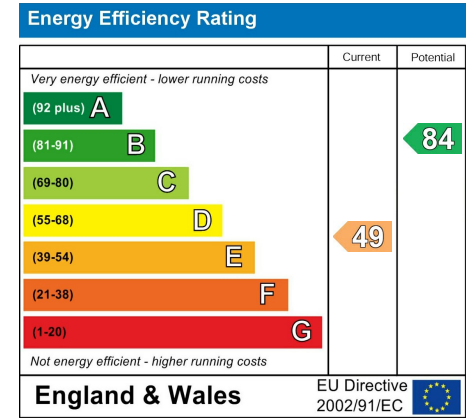

BASEMENT

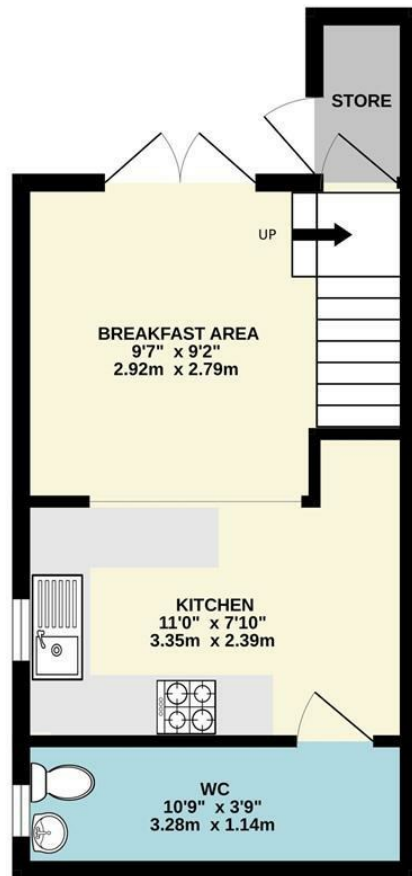

GROUND FLOOR

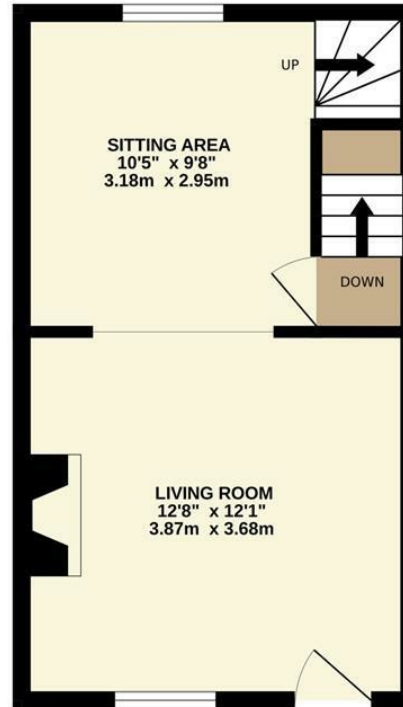

1ST FLOOR

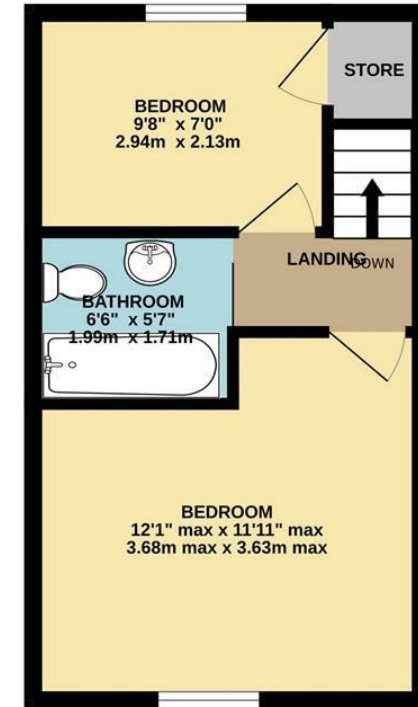

Whilst every attempt has been made to ensure the accuracy of the floorplan contained here, measurements of doors, windows, rooms and any other items are approximate and no responsibility is taken for any error, omission or mis-statement. This plan is for illustrative purposes only and should be used as such by any prospective purchaser. The services, systems and appliances shown have not been tested and no guarantee as to their operability or efficiency can be given.  
 Made with Metropix ©2023



These particulars are believed to be accurate but they are not guaranteed and do not form a contract. Neither Jordan Fishwick nor the vendor or lessor accept any responsibility in respect of these particulars, which are not intended to be statements or representations of fact and any intending purchaser or lessee must satisfy himself by inspection or otherwise as to the correctness of each of the statements contained in these particulars. Any floorplans on this brochure are for illustrative purposes only and are not necessarily to scale.

Offices at: Chorlton, Didsbury, Disley, Hale, Glossop, Macclesfield, Manchester Deansgate, Manchester Whitworth Street, New Mills, Sale, Wilmslow and Withington

14 Market Street, Disley, Cheshire, SK12 2AA

01663 76 78 78

disley@jordanfishwick.co.uk

www.jordanfishwick.co.uk