



*jordan fishwick*

Kinder View Close Disley Stockport



## Kinder View Close Disley Stockport SK12 2GF

Offers Over £300,000



### The Property

**\*\* BEAUTIFUL HOME BACK ON THE MARKET \*\* NO VENDOR CHAIN\*\*** Enjoying an elevated position on a popular, small modern development in Newtown, Disley, a three/four bedroom mid mews property. Immaculately presented throughout, south facing gardens, parking for two cars and remaining new build warranty. Comprising: ent hall, wc, dining kitchen, living room, two first floor bedrooms, study, family bathroom with underfloor heating, second floor master bedroom with en-suite. Rear views, pvc double glazing, gas central heating and high energy efficiency. Ideal position for Newtown Railway station.

\*NOTE: Parcel of land available by separate negotiation.



- South Facing Gardens
- Popular Small Development
- Convenient Location
- Three Bedrooms Plus Study
- Pleasant Rear Aspect
- No Vendor Chain
- Immaculately Presented
- Remaining New Build Warranty
- Elevated Position

**Postcode** SK12 2GF

**EPC Rating** B

**Local Authority** Cheshire East

**Council Tax** C

Energy Efficiency Rating		Current	Potential
Very energy efficient - lower running costs			
(92 plus) <b>A</b>			<b>97</b>
(81-91) <b>B</b>		<b>85</b>	
(69-80) <b>C</b>			
(55-68) <b>D</b>			
(39-54) <b>E</b>			
(21-38) <b>F</b>			
(1-20) <b>G</b>			
Not energy efficient - higher running costs			
<b>England &amp; Wales</b>		EU Directive 2002/91/EC 	



GROUND FLOOR

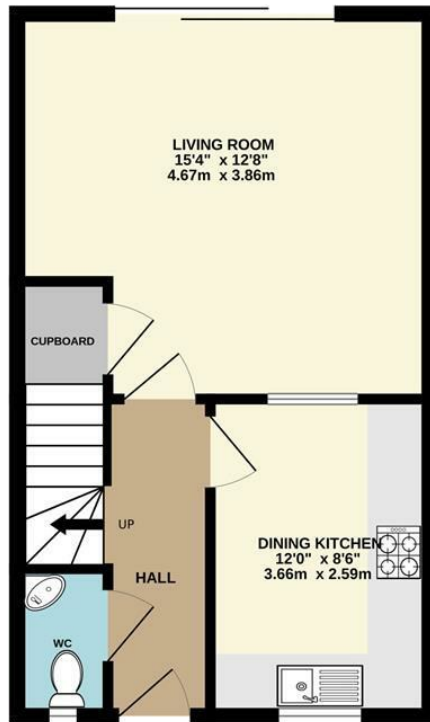

1ST FLOOR

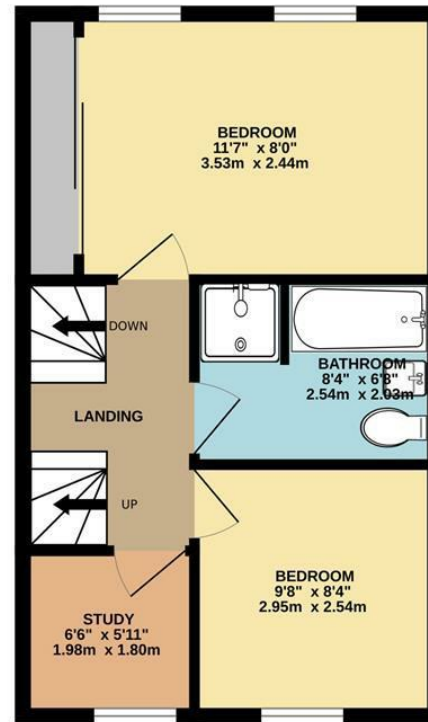

2ND FLOOR



Whilst every attempt has been made to ensure the accuracy of the floorplan contained here, measurements of doors, windows, rooms and any other items are approximate and no responsibility is taken for any error, omission or mis-statement. This plan is for illustrative purposes only and should be used as such by any prospective purchaser. The services, systems and appliances shown have not been tested and no guarantee as to their operability or efficiency can be given.  
Made with Metropix ©2023



These particulars are believed to be accurate but they are not guaranteed and do not form a contract. Neither Jordan Fishwick nor the vendor or lessor accept any responsibility in respect of these particulars, which are not intended to be statements or representations of fact and any intending purchaser or lessee must satisfy himself by inspection or otherwise as to the correctness of each of the statements contained in these particulars. Any floorplans on this brochure are for illustrative purposes only and are not necessarily to scale.

Offices at: Chorlton, Didsbury, Disley, Hale, Glossop, Macclesfield, Manchester Deansgate, Manchester Whitworth Street, New Mills, Sale, Wilmslow and Withington

14 Market Street, Disley, Cheshire, SK12 2AA

01663 76 78 78

disley@jordanfishwick.co.uk

www.jordanfishwick.co.uk