



Jordan fishwick

Hollinwood Road Disley Stockport

Hollinwood Road Disley Stockport SK12 2EB

£380,000



The Property

FABULOUS HOME IN A VERY POPULAR LOCATION Refurbished in recent years, this three bedroom 1930's bay fronted semi-detached home doesn't disappoint. Occupying a convenient position close to Disley Village centre and Railway Station and overlooking a wooded copse. Beautifully presented throughout, landscaped gardens, OFF ROAD PARKING, pvc double glazing and gas central heating. Comprising: entrance hall, living room with open fire, beautiful open plan re-fitted dining kitchen with French Doors to the garden and feature exposed brick chimney breast, three first floor bedrooms and a bathroom with re-fitted bathroom. Viewing Essential.



- Popular and Convenient Location
- Wooded Aspect and Private Landscaped Tiered Garden
- Three Bedrooms
- Refurbished in Recent Years
- Open Fire and Wood Burning Stove
- 1930's Semi-Detached Property
- Boarded Loft with Potential For Conversion (Subject to planning)
- Off Road Parking

Postcode SK12 2EB

EPC Rating D

Local Authority Cheshire East

Council Tax C

Energy Efficiency Rating		Current	Potential
Very energy efficient - lower running costs			
(92 plus) A			
(81-91) B			82
(69-80) C			
(55-68) D		59	
(39-54) E			
(21-38) F			
(1-20) G			
Not energy efficient - higher running costs			
England & Wales		EU Directive 2002/91/EC 	



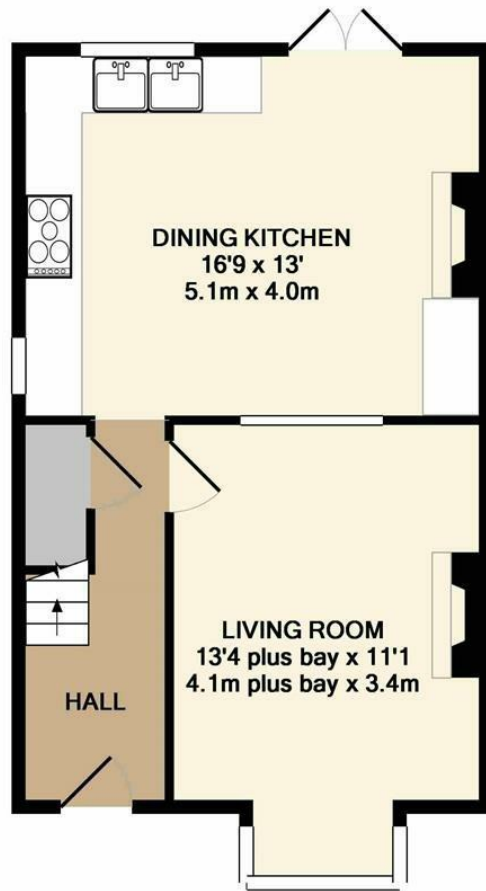

GROUND FLOOR

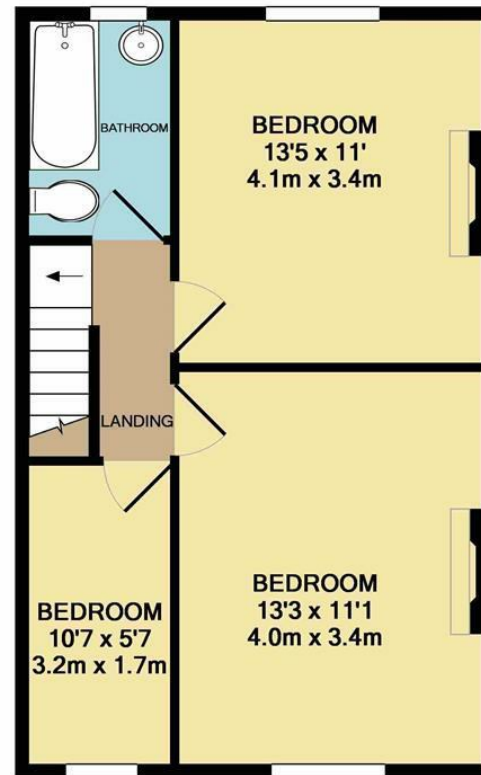

1ST FLOOR

Whilst every attempt has been made to ensure the accuracy of the floor plan contained here, measurements of doors, windows, rooms and any other items are approximate and no responsibility is taken for any error, omission, or mis-statement. This plan is for illustrative purposes only and should be used as such by any prospective purchaser. The services, systems and appliances shown have not been tested and no guarantee as to their operability or efficiency can be given
Made with Metropix ©2019



These particulars are believed to be accurate but they are not guaranteed and do not form a contract. Neither Jordan Fishwick nor the vendor or lessor accept any responsibility in respect of these particulars, which are not intended to be statements or representations of fact and any intending purchaser or lessee must satisfy himself by inspection or otherwise as to the correctness of each of the statements contained in these particulars. Any floorplans on this brochure are for illustrative purposes only and are not necessarily to scale.

Offices at: Chorlton, Didsbury, Disley, Hale, Glossop, Macclesfield, Manchester Deansgate, Manchester Whitworth Street, New Mills, Sale, Wilmslow and Withington

14 Market Street, Disley, Cheshire, SK12 2AA

01663 76 78 78

disley@jordanfishwick.co.uk

www.jordanfishwick.co.uk