



jordan fishwick

Green Lane Disley Stockport



Green Lane Disley Stockport SK12 2AL

Offers Over £2,500,000



The Property

*** SUPERB HOLIDAY LET POTENTIAL OVERLOOKING LYME PARK
*** Commanding the most incredible views across Lyme Park towards Manchester and standing in just over 3.5 acres of grounds, is Higher Stone Ridge. A character detached home with spacious, versatile accommodation including an assortment of workshops, barns and stables. Steeped in history with a wealth of features this charming property offers any new owner the opportunity to improve and update to their taste. Fantastic development potential as holiday lets with amazing potential income (subject to planning). The main house has four bedrooms with four reception rooms, attached workshop with store, separate 45ft stone barn with attached stable block and store, there is ample parking, lawn gardens with dry stone walling and panoramic views of The Cage at Lyme, enclosed paddock areas and a larger wooded field.



- Standing in 3.5 Acres of Grounds
- Sublime Views over Lyme Park
- Steep in History, Dating Back 500 Yrs
- Detached Barn and Stable Block
- Sought After Location in Disley
- Development Potential
- Four Bedroom Detached Main House

Postcode SK12 2AL

EPC Rating G

Local Authority Cheshire East

Council Tax G

Energy Efficiency Rating		Current	Potential
Very energy efficient - lower running costs			
(92 plus) A			
(81-91) B			
(69-80) C			
(55-68) D			
(39-54) E			
(21-38) F			
(1-20) G		1	1
Not energy efficient - higher running costs			
England & Wales		EU Directive 2002/91/EC 	



GROUND FLOOR

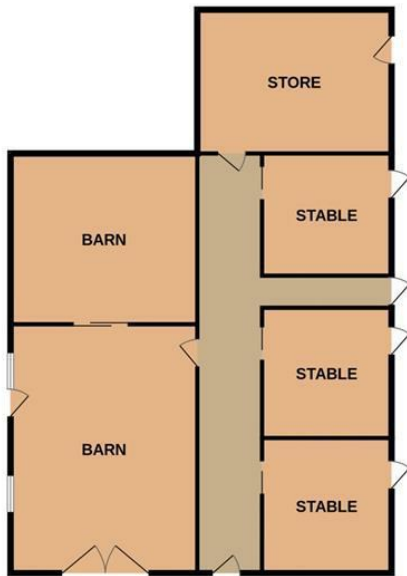

1ST FLOOR



Whilst every attempt has been made to ensure the accuracy of the floorplan contained here, measurements of doors, windows, rooms and any other items are approximate and no responsibility is taken for any error, omission or mis-statement. This plan is for illustrative purposes only and should be used as such by any prospective purchaser. The services, systems and appliances shown have not been tested and no guarantee as to their operability or efficiency can be given.
 Made with Metropix ©2023



These particulars are believed to be accurate but they are not guaranteed and do not form a contract. Neither Jordan Fishwick nor the vendor or lessor accept any responsibility in respect of these particulars, which are not intended to be statements or representations of fact and any intending purchaser or lessee must satisfy himself by inspection or otherwise as to the correctness of each of the statements contained in these particulars. Any floorplans on this brochure are for illustrative purposes only and are not necessarily to scale.

Offices at: Chorlton, Didsbury, Disley, Hale, Glossop, Macclesfield, Manchester Deansgate, Manchester Whitworth Street, New Mills, Sale, Wilmslow and Withington

14 Market Street, Disley, Cheshire, SK12 2AA

01663 76 78 78

disley@jordanfishwick.co.uk

www.jordanfishwick.co.uk