

These particulars are believed to be accurate but they are not guaranteed and do not form a contract. Neither Jordan Fishwick nor the vendor or lessor accept any responsibility in respect of these particulars, which are not intended to be statements or representations of fact and any intending purchaser or lessee must satisfy himself by inspection or otherwise as to the correctness of each of the statements contained in these particulars. Any floorplans on this brochure are for illustrative purposes only and are not necessarily to scale.

Whilst every attempt has been made to ensure the accuracy of the floorplan contained here, measurements of doors, windows, rooms and other items are approximate and no responsibility is taken for any error, omission or mis-statement. This plan is for illustrative purposes only and should be used as such by any prospective purchaser. The services, systems and appliances shown have not been tested and no guarantee as to their operability or efficiency can be given.
Made with Metropix ©2023

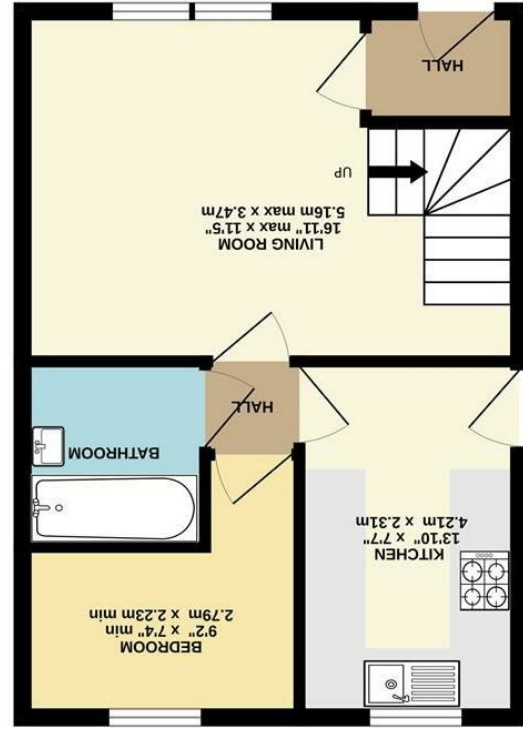

1ST FLOOR



GROUND FLOOR



1 Kinder View Close, Newtown, Disley, SK12 2GF

£280,000



The Property

NO VENDOR CHAIN Only two years old and located at the head of a cul-de-sac on a small modern development in Newtown Disley, a two bedroom semi-detached dormer bungalow. Finished to a high standard and offering versatile accommodation, this delightful home fits a multitude of buyers. Double width driveway parking, lawn gardens and comprising: entrance hall, living room, fitted dining kitchen with appliances, ground floor bedroom and bathroom, first floor master suite with fitted furniture and en-suite shower room. High energy efficiency, pvc double glazing and gas central heating. Viewing recommended.

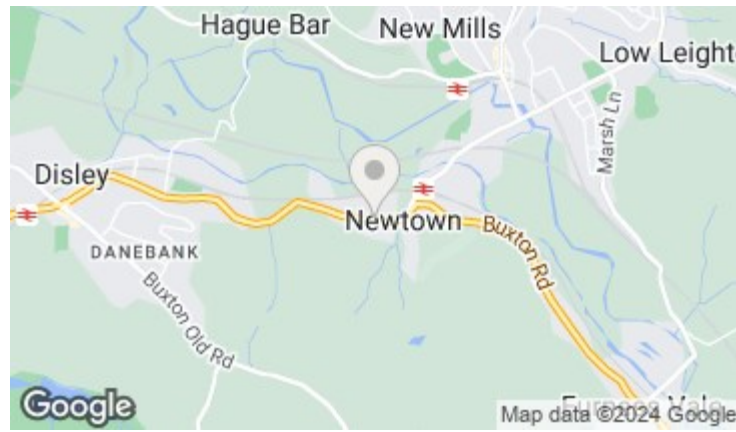

- Superb Semi-Detached Dormer Bungalow
- Convenient Location
- Modern Small Development
- Cul-de-sac Position
- Two Bedrooms
- Remaining New Build Warranty
- Double Width Driveway
- Lawn Gardens
- No Chain

Postcode - SK12 2GF
EPC Rating - B
Local Authority - Cheshire East
Council Tax - C

