



56 Tollesbury Avenue, Barleythorpe, Oakham,
LE15 7WE

 **NEWTON FALLOWELL**



Key Features

- Modern Mid Terrace
- Two Double Bedrooms With Built In Storage
- Kitchen/Diner
- Downstairs W.C & Utility Area
- Enclosed Rear Garden
- Two Allocated Parking Spaces
- Presented To A High Standard
- NO CHAIN!
- EPC Rating B
- Freehold

£205,000





Positioned in the heart of Barleythorpe within easy access to Oakham's popular market town centre, local train station, and schools is this well-presented modern mid-terraced home. A fantastic purchase for a first-time buyer or investor, this two-bedroom home is offered for sale with NO CHAIN and briefly comprises of a living room, kitchen/diner, downstairs W.C & Utility, two double bedrooms, and an updated shower room.

As you enter the property via the front door you step into the light and airy living room that offers a window to the front aspect, stairs to the first floor, and a useful under-stairs storage cupboard. Flowing through from the lounge is the downstairs W.C. & utility area that boasts a close coupled W.C. with half and full flush, a pedestal wash hand basin, and space and plumbing for a washing machine. From here you enter the kitchen/diner that boasts a gloss tiled floor, integrated hob & oven, and an inset stainless steel sink and drainer. Additional cabinets have been added to the kitchen for useful extra storage space. Opening out from the kitchen are double French doors that lead out to the rear garden. Upstairs the property offers two double bedrooms with bedroom two sitting to the rear of the property and offering a built-in wardrobe and a view to the rear aspect. The main bedroom sits to the front of the property and boasts built-in storage and a view of the front street scene. Completing the upstairs accommodation is the re-fitted family shower room that features a double walk-in shower with stainless steel fittings, Mira digital controller and an oversized shower head, close coupled W.C. with half and full flush, and a pedestal wash hand basin.

Externally the property offers a fully enclosed low-maintenance garden that is laid to a patio with a rear access gate and a wooden storage shed.

Room Measurements

Lounge 4.15m x 3.71m (13'7" x 12'2")

WC 1.57m x 1.21m (5'2" x 4'0")

Kitchen 3.73m x 2.48m (12'2" x 8'1")

Bedroom One 3.08m x 2.78m (10'1" x 9'1")

Bedroom Two 3.08m x 2.71m (10'1" x 8'11")

Bathroom 1.96m x 1.68m (6'5" x 5'6")

Residents Management Company

The property is liable to pay an annual charge to Oakham Heights Residents Management Company for the maintenance and upkeep of the common areas within the Oakham Heights development. We are advised that the current charge is £166.15 per property, per annum and is reviewable on an annual basis. Contact Newton Fallowell for further information.

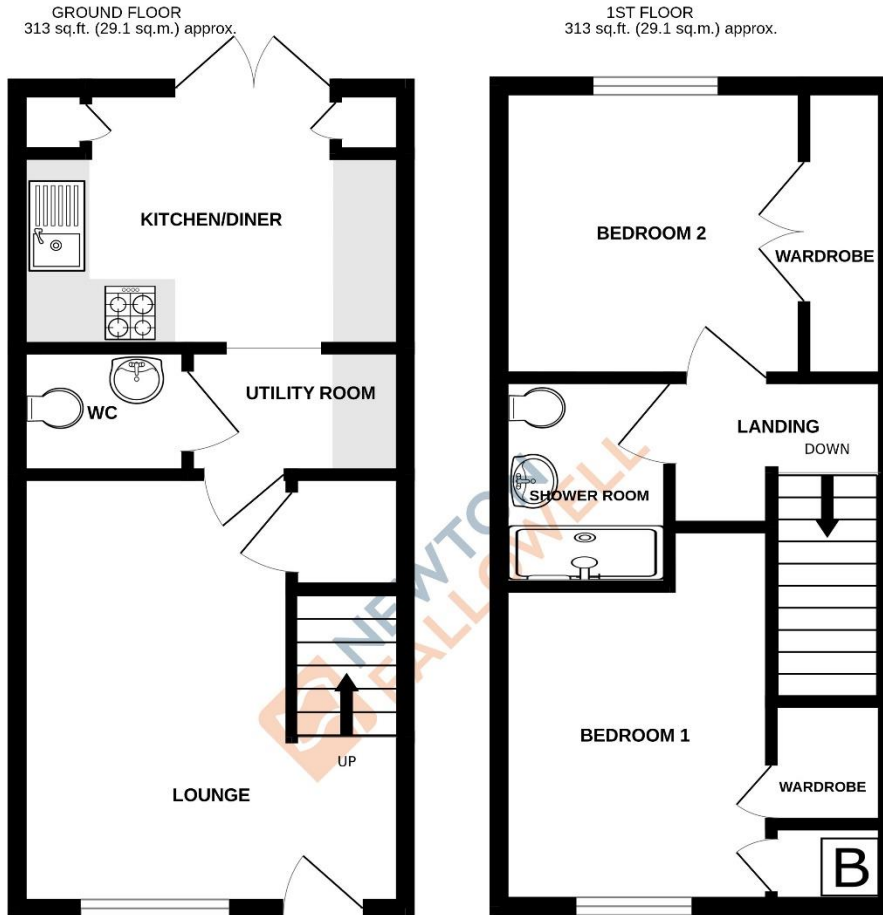

TOLLESBURY AVENUE, BARLEYTHORPE, OAKHAM LE157WE

TOTAL FLOOR AREA : 627 sq.ft. (58.2 sq.m.) approx.

Whilst every attempt has been made to ensure the accuracy of the floorplan contained here, measurements of doors, windows, rooms and any other items are approximate and no responsibility is taken for any error, omission or mis-statement. This plan is for illustrative purposes only and should be used as such by any prospective purchaser. The services, systems and appliances shown have not been tested and no guarantee as to their operability or efficiency can be given.
Made with Metroplan ©2024

Score	Energy rating	Current	Potential
92+	A		
81-91	B	89 B	90 B
69-80	C		
55-68	D		
39-54	E		
21-38	F		
1-20	G		

COUNCIL TAX INFORMATION:

Local Authority: Rutland County Council
Council Tax Band: B

AGENTS NOTE:

Please note these particulars may be subject to change and must not be relied upon as an entirely accurate description of the property. Although these particulars are thought to be materially correct, their accuracy cannot be guaranteed, and they do not form part of any contract. Some measurements are overall measurements and others are maximum measurements. All services and appliances have not and will not be tested.

ANTI-MONEY LAUNDERING REGULATIONS:

Intending purchasers will be required to provide identification documentation via our compliance provider, Lifetime Legal, at a cost of £55 per transaction. This will need to be actioned at the offer stage and we would ask for your cooperation in order that there will be no delay in agreeing the sale.

REFERRAL FEES:

Newton Fallowell and our partners provide a range of services to buyers, although you are free to use an alternative provider. We can refer you on to Mortgage Advice Bureau for help with finance. We may receive a fee of £300 if you take out a mortgage through them. If you require a solicitor to handle your purchase, we can refer you on to our in-house solicitors. We may receive a fee of £200 if you use their services.