



**Manchester Road, Altrincham, WA14**

**Asking Price of £18,000 pa**





# Full Description

---

Located on Manchester Road just a few minutes from the retail park, surrounded by residential housing, and walking distance from Altrincham town centre and Navigation Road Metrolink station. The location offers great exposure to passing trade and offers convenient access to transport links

The property offers a retail unit with prominent high street shop front on Manchester Road. The retail space is also accompanied by a rear office space/ meeting room; a kitchen area; a WC; and to the lower ground floor two large basement chambers provide ample storage space.







BASEMENT  
788 sq.ft. (73.2 sq.m.) approx.

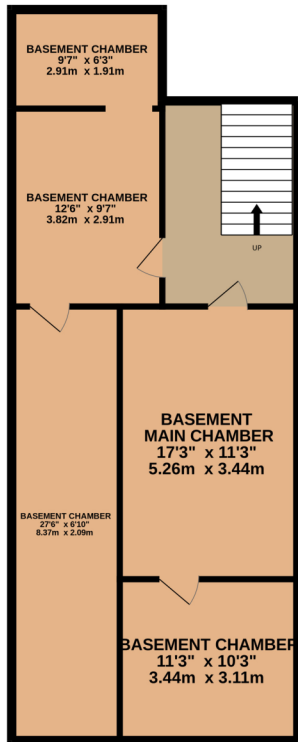

LOWER GROUND FLOOR  
342 sq.ft. (31.8 sq.m.) approx.

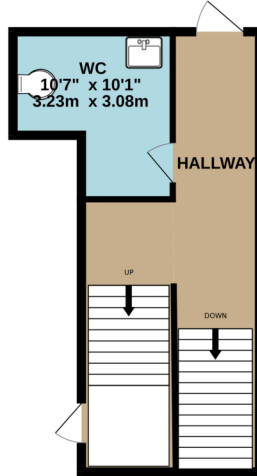

GROUND FLOOR  
723 sq.ft. (67.2 sq.m.) approx.

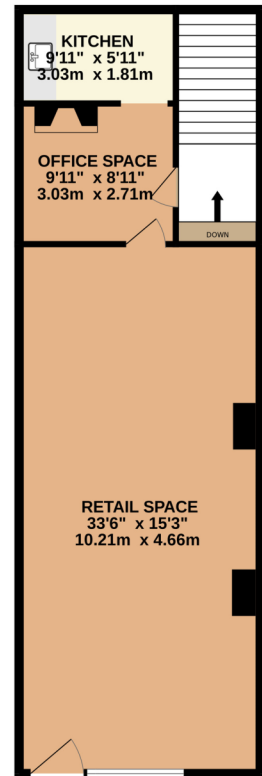

TOTAL FLOOR AREA: 1854 sq.ft. (172.2 sq.m.) approx.

Whilst every attempt has been made to ensure the accuracy of the floorplan contained here, measurements of doors, windows, rooms and any other items are approximate and no responsibility is taken for any error, omission or mis-statement. This plan is for illustrative purposes only and should be used as such by any prospective purchaser. The services, systems and appliances shown have not been tested and no guarantee as to their operability or efficiency can be given.  
Made with Metropix ©2024