



bonners & babingtons

Oram Court  
Marlow





Oram Court  
Dean Street  
Marlow  
Buckinghamshire

---

**Tenure:** Leasehold  
**Guide Price:** £350,000  
**Annual Service Charge:** TBC  
**Annual Ground Rent:** TBC  
**Tax Band:** D  
**EPC Rating:** C  
**Local Authority:** BCC

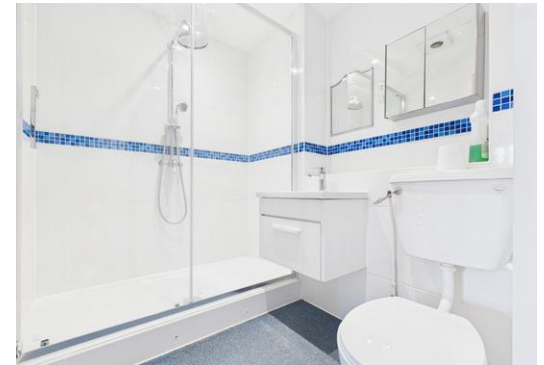

Offered to the market with no onward chain this two bedroom first floor apartment is ready for immediate occupation. Specifically for the Over 60's this apartment is situated in a bespoke development just a stone's throw from Marlow High Street yet is positioned in a secluded and peaceful location. Comprising two bedrooms, living room, kitchen and shower room this property also benefits from security entryphone system, warden alarm system, residents parking and communal grounds. The development also has a communal meeting room where regular residents events are held.

Marlow town centre is a thriving and stylish riverside community with a comprehensive range of shops and excellent pubs and restaurants. Nearby Marlow Station has a regular train service to London Paddington via Maidenhead (from 44 mins) with links to the City of London, via the Elizabeth Line. Access to the M4 and M40 is via the A404(M) and London Heathrow is approximately 22 miles away. There is a wide range of educational and recreational facilities in the area. Excellent local schools are numerous and include Sir William Borlase in Marlow.



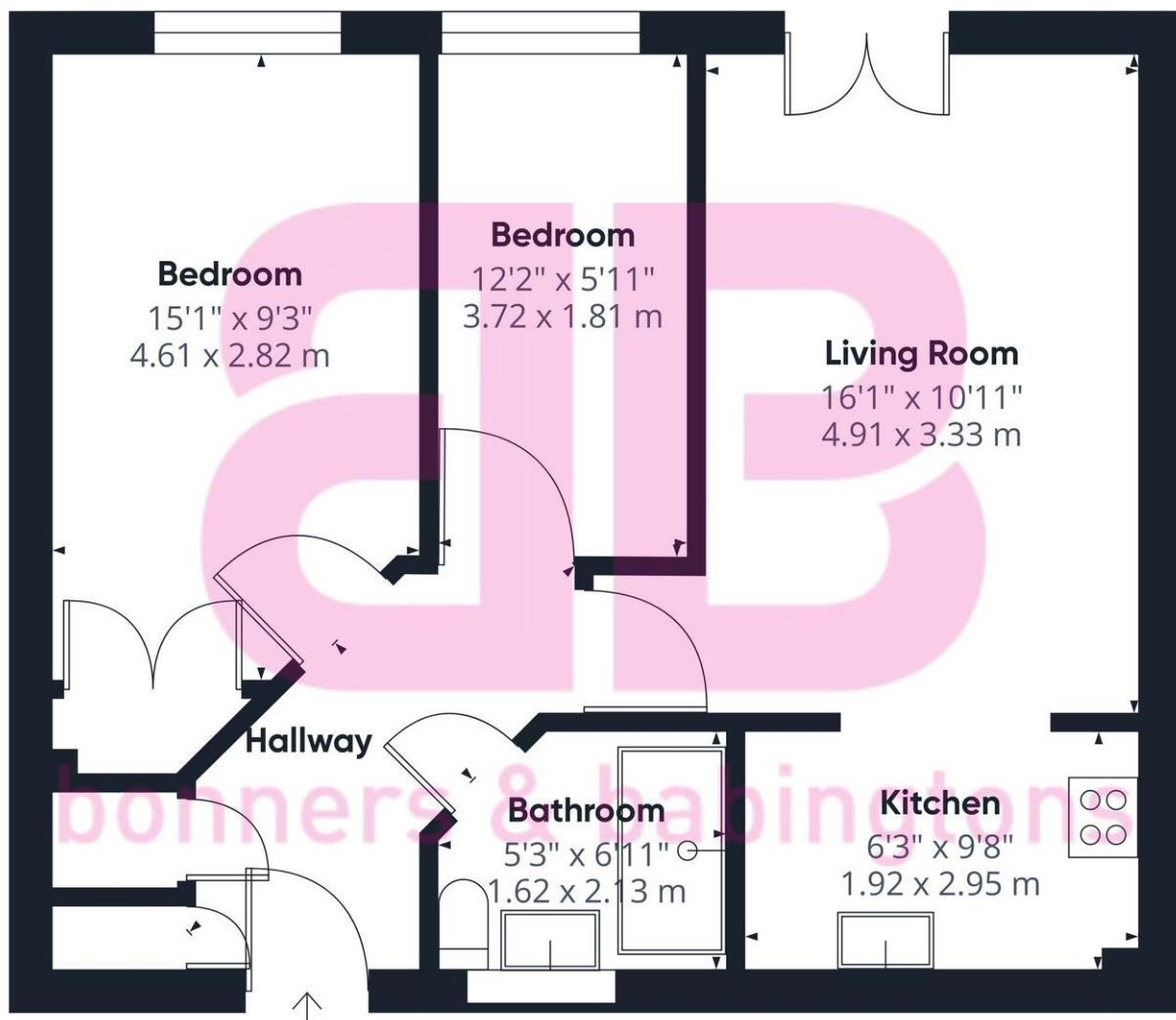

Approximate total area<sup>(1)</sup>  
578 ft<sup>2</sup>  
53.6 m<sup>2</sup>

(1) Excluding balconies and terraces

While every attempt has been made to ensure accuracy, all measurements are approximate, not to scale. This floor plan is for illustrative purposes only.

Calculations are based on RICS IPMS 3C standard.

GIRAFFE360



bonners & babingtons

Anglers Court, Spittal Street, Marlow, Buckinghamshire, SL7 3HJ

01628 333800

marlow@bb-estateagents.co.uk

rightmove

OnTheMarket

Zoopla.co.uk



#### Disclaimer

We endeavour to make our particulars accurate and reliable. They are for guidance only and are intended to give a fair overall summary of the property. They do not form part of any contract or offer, and should not be relied upon as a statement or representation of fact. Measurements, areas and distances are approximate and photographs provided for guidance only. No undertaking is given as to the structural condition of the property, or any necessary consents, or the operating ability or efficiency of any service, system or appliance. Prospective purchasers must satisfy themselves with regard to each of these points. If there is any particular aspect of the property about which you would like further information, please contact us, especially, before you travel to the property. B2170