



bonners & babingtons

Station Road
Marlow



Station Road
Marlow
Buckinghamshire
SL7 1NS

- Tenure: Freehold
- Guide Price: £550,000
- Local Authority: BCC
- EPC Rating: E
- Council Tax Band: D



A well proportioned Victorian home offered `For Sale` with NO UPPER CHAIN situated within easy walk of the town centre. The property offers a lovely blend of character features with a contemporary interior. The accommodation briefly comprises on the ground floor, living room with log burner, defined dining room with fireplace which is `open plan` to the modern fitted kitchen, rear lobby and bathroom.

On the first floor there are 2 good size double bedrooms, a further occasional bedroom 3/nursery room/office or an en suite shower room as there is plumbing provision for this. Outside there is a low maintenance rear garden with storage shed. The property benefits from gas central heating and is sold with NO UPPER CHAIN. * PHOTOGRAPHS SHOWN ARE PRE-TENANCY PHOTOGRAPHS*

Marlow town centre is a thriving and stylish riverside community with a comprehensive range of shops and excellent pubs and restaurants. Nearby Marlow Station has a train service to London Paddington via Maidenhead (from 1hr 5mins). Maidenhead also offers a regular train service to London Paddington with links to the City of London, further enhanced when Crossrail opens in Maidenhead in 2020. Access to the M4 and M40 is via the A404(M) and London Heathrow is about 22 miles away. There is a wide range of educational and recreational facilities in the area. Excellent local schools are numerous and include Sir William Borlase in Marlow.

BONNERS & BABINGTONS offer -
Situated on a popular and established road close to Marlow Town Centre this three bedroom end of terrace character cottage is available with no onward chain. Only a five minute walk to Marlow High Street and even less to Marlow Train Station.



Ground Floor

Approx. 41.1 sq. metres (441.9 sq. feet)

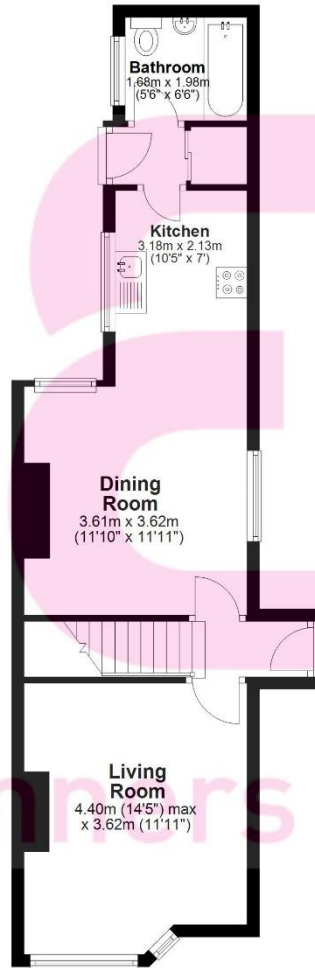

First Floor

Approx. 37.5 sq. metres (404.1 sq. feet)

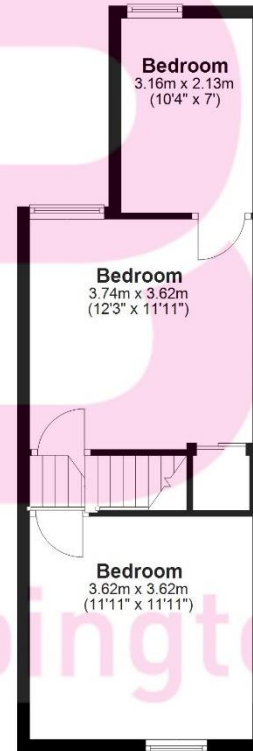

Total area: approx. 78.6 sq. metres (846.0 sq. feet)

This floorplan is not to scale. It is to be used for guidance and illustrative purposes only. Accuracy is not guaranteed.
Plan produced using PlanUp.



bonners & babingtons

3 Anglers Court, Spittal Street,
Marlow, Bucks, SL7 3HJ



01628 333800

www.bb-estateagents.co.uk

Disclaimer

We endeavour to make our particulars accurate and reliable. They are for guidance only and are intended to give a fair overall summary of the property. They do not form part of any contract or offer, and should not be relied upon as a statement or representation of fact. Measurements, areas and distances are approximate and photographs provided for guidance only. No undertaking is given as to the structural condition of the property, or any necessary consents, or the operating ability or efficiency of any service, system or appliance. Prospective purchasers must satisfy themselves with regard to each of these points. If there is any particular aspect of the property about which you would like further information, please contact us, especially, before you travel to the property. B2170