



22 Filbert Street, Chippenham, SN15 1FT

£289,000

Set at the bottom of a cul de sac, fronting on to an established green area, this generous two bedroom semi detached home has been well cared for by the current owners. Comprising; entrance hall, lounge, lobby, cloakroom and kitchen/dining room with French doors leading to the garden on the ground floor. On the first floor there is a generous bedroom with wardrobe, further double bedroom again with wardrobe included and bathroom with window. To the rear the garden has been landscaped to provide areas of patio, lawn, raised bed sunken seating area, garden shed and gated access to the side of the house. NO ONWARD CHAIN.

Entrance Hall

Double glazed front door, radiator, vinyl flooring, door to the lounge and stairs to the first floor.

Lounge 12'07" x 11'07" (3.84m x 3.53m)



Double glazed window to the front, two radiators, Vinyl flooring and door to the inner hall.



Inner Hall

Door to the cloakroom, door to the kitchen and vinyl flooring.

Cloakroom



Toilet, wash hand basin, radiator and vinyl flooring.

Kitchen/Dining Room 14'08" x 9'03"
maximum (4.47m x 2.82m maximum)



Double glazed French doors to the garden, radiator, vinyl flooring, space for a table and chairs, storage cupboard, range of floor and wall mounted units, tiled splashes, induction hob, extractor fan, electric oven, integral washer/dryer, dishwasher and fridge/freezer.



Landing



Double glazed window to the side, access to the loft which has a drop down ladder and is boarded, radiator and doors to the bedrooms and bathroom.

Bedroom One 11'07" x 11' (3.53m x 3.35m)



Double glazed window to the front, radiator and two built in cupboards.



Bedroom Two 11'02" x 8'04" (3.40m x 2.54m)



Double glazed window to the rear and radiator.

Bathroom 6'08" x 6'01" (2.03m x 1.85m)



Double glazed window to the rear, radiator, vinyl flooring, toilet, wash hand basin and bath with shower screen and mains shower over.

Garden



Generous landscaped garden providing areas of patio, lawn, bedding plants, sunken seating area, garden shed and gated side access.



Parking

The property has two side by side spaces located in front of the house.

Tenure

We are advised by the .GOV website that the property is freehold. There is an annual estate management charge payable. The last payment for the year made was £144.

Council Tax

We are advised by the .GOV website that the property is band C.

Agents Notes

A number of garden images were taken in the summer.

Floor Plan

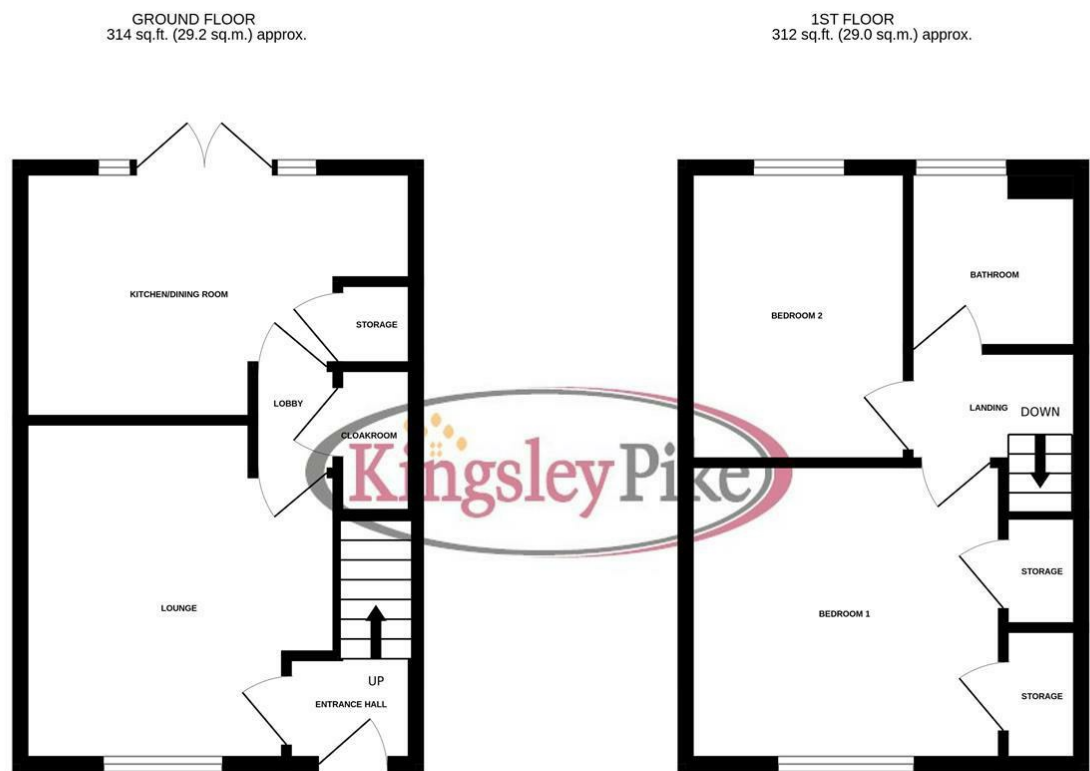

2 BEDROOM SEMI DETACHED HOUSE

TOTAL FLOOR AREA : 626 sq.ft. (58.2 sq.m.) approx.

Whilst every attempt has been made to ensure the accuracy of the floorplan contained here, measurements of doors, windows, rooms and any other items are approximate and no responsibility is taken for any error, omission or mis-statement. This plan is for illustrative purposes only and should be used as such by any prospective purchaser. The services, systems and appliances shown have not been tested and no guarantee as to their operability or efficiency can be given.
Made with Metropix ©2025

Area Map



Energy Efficiency Graph

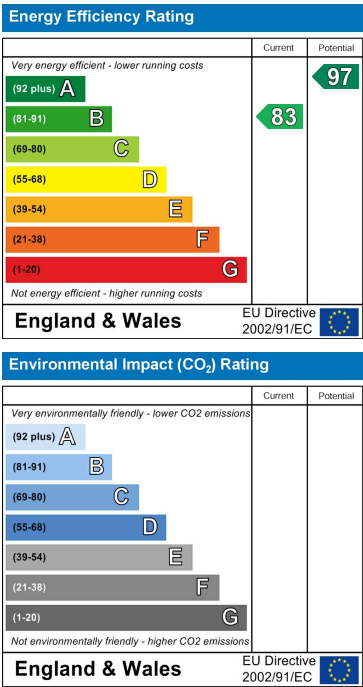

These particulars, whilst believed to be accurate are set out as a general outline only for guidance and do not constitute any part of an offer or contract. Intending purchasers should not rely on them as statements of representation of fact, but must satisfy themselves by inspection or otherwise as to their accuracy. No person in this firms employment has the authority to make or give any representation or warranty in respect of the property.