



18 Bryant Close, Chippenham, SN15 1FX

£300,000

Located on the new development of Birds Marsh View, a well presented modern end of terrace house. To the rear there is a part walled enclosed garden with areas of lawn and patio, to the front there are two allocated parking spaces. Internally comprising; entrance hall, cloakroom, lounge, kitchen/dining room, three bedrooms, family bathroom and en suite to the main.

Entrance Hall

Cloakroom 7'10" x 7'01" (2.39m x 2.16m)

Lounge 14'05" x 11'10" (4.39m x 3.61m)



Kitchen/Dining Room 15'07" x 9'01" (4.75m x 2.77m)



Landing

Bedroom One 11'11" x 9'09" max (3.63m x 2.97m max)



En Suite



Bedroom Two 7'07" x 9'02" (2.31m x 2.79m)

Bedroom Three 7'07" x 6'03" (2.31m x 1.91m)



Bathroom



Gardens



Parking

There are two allocated parking spaces

Tenure

We are advised by the .gov website that the property is freehold. The property has an estate charge for the upkeep of the surrounding areas of circa £150 per annum.

Council Tax

We are advised by the .gov website that the property is band C.

Floor Plan

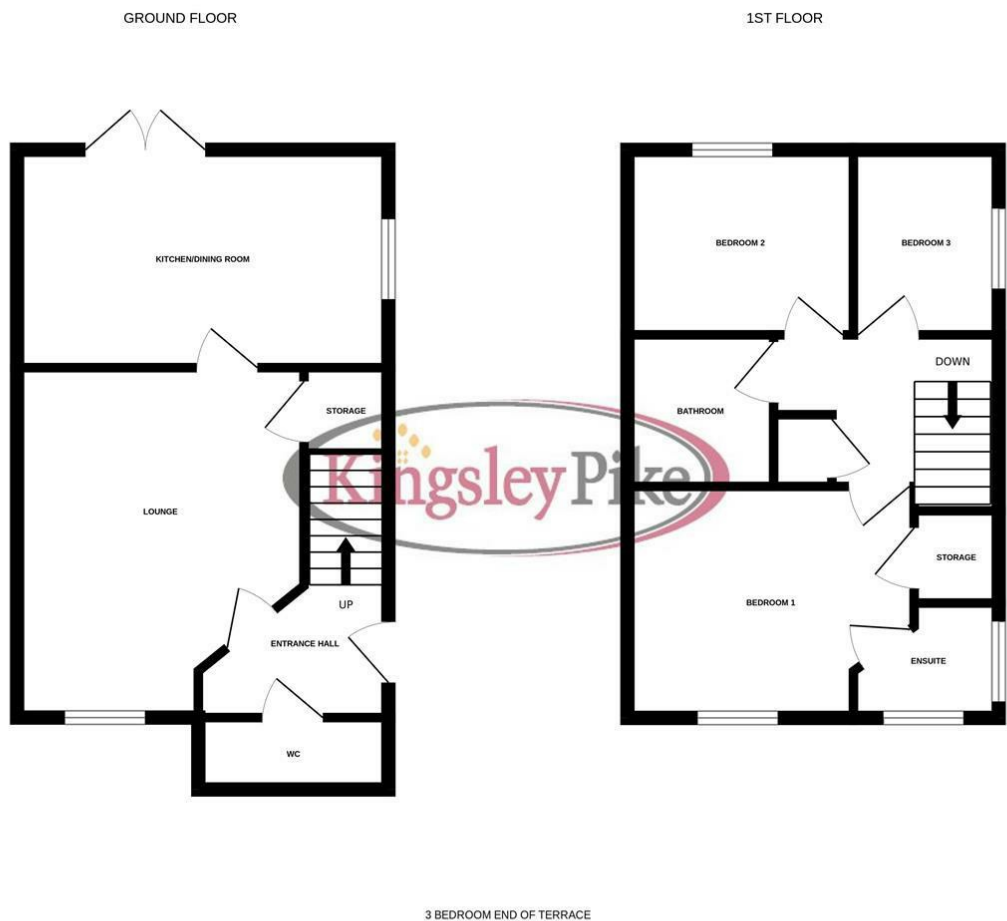

Whilst every attempt has been made to ensure the accuracy of the floorplan contained here, measurements of doors, windows, rooms and any other items are approximate and no responsibility is taken for any error, omission or mis-statement. This plan is for illustrative purposes only and should be used as such by any prospective purchaser. The services, systems and appliances shown have not been tested and no guarantee as to their operability or efficiency can be given.
Made with Metropix ©2024

Area Map

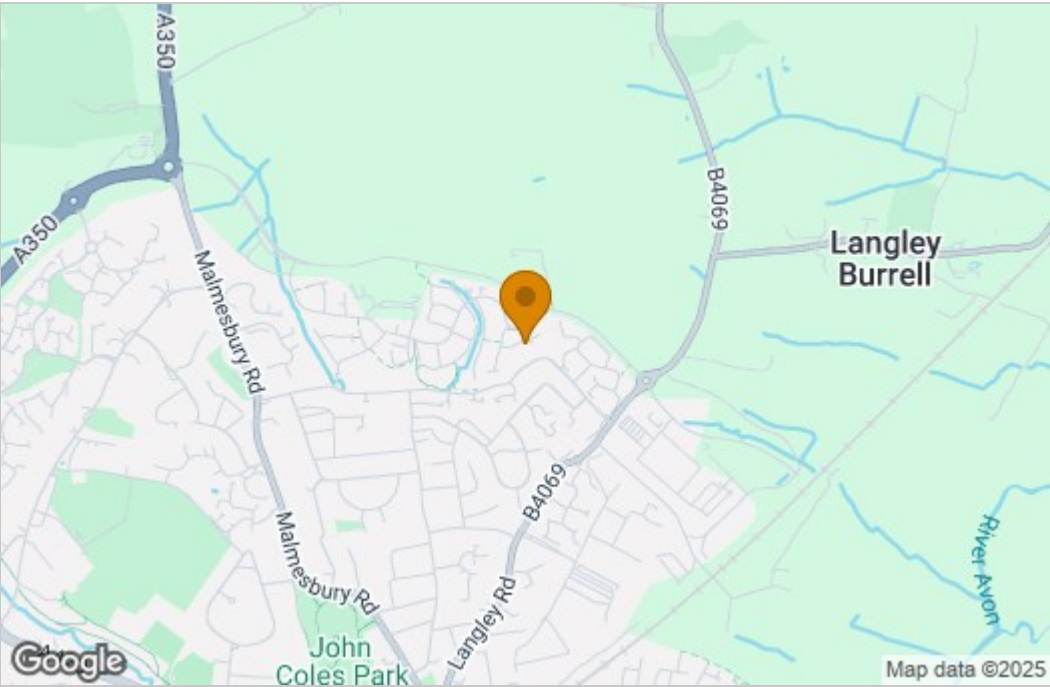

Energy Efficiency Graph

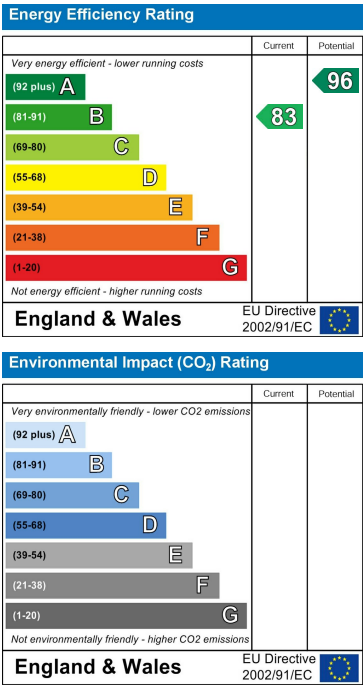

These particulars, whilst believed to be accurate are set out as a general outline only for guidance and do not constitute any part of an offer or contract. Intending purchasers should not rely on them as statements of representation of fact, but must satisfy themselves by inspection or otherwise as to their accuracy. No person in this firms employment has the authority to make or give any representation or warranty in respect of the property.