



26 Clift House Langley Road, Chippenham, SN15 1DS

£105,000

REFITTED BATHROOM. Located within walking distance to the town centre, a warden controlled two bedroom flat. The property benefits from communal gardens and communal parking, also within walking distance of John Coles Park. Accommodation briefly comprises: hallway, living room, kitchen, two bedrooms and refitted bathroom. Whilst there is a communal Laundry room in Clift House, this flat benefits from plumbing for a washing machine in the kitchen. This property can only be purchased by clients who are 55 years and older. There are lifts and a guest room and also communal living room. No Onward Chain.

Communal Hallway

Door leads into communal hall with seating area, lift serving other floors.

Entrance Hall

Front door leads into hallway with walk in cupboard, further cupboard housing hot water tank and water softener.

Living / Dining Room 15'07" x 9'05" (4.75m x 2.87m)



Double glazed bay window, entry phone. electric heater.

Kitchen 9'09" x 6'04" (2.97m x 1.93m)



Double glazed window, work tops, cupboards and drawers under, inset stainless steel sink, plumbing and space for washing machine, space for cooker, electric heater.

Bedroom One 12'02" x 9'0" (3.71m x 2.74m)



Double glazed window, built in wardrobe, electric heater..

Bedroom Two 12'03" x 6'05" (3.73m x 1.96m)



Double glazed window.

Re Fitted Bathroom



Modern shower room, refitted, walk in shower cubicle, hand basin with vanity unit, W.C, extractor fan.

Outside

Communal Gardens



Communal gardens with lawn and seating area.

Communal Parking

Communal Parking and first come first served basis.

Tenure

GOV.UK advises Leasehold.

99 Years from 2015

Service Charge: £296.59 / Month

There is a deferred Service Charge that a seller would have to pay if they sell the flat. Paid to Anchor Housing, 1% of the purchase price multiplied the number of years that they have owned the flat.

Council Tax Band

GOV.UK advises Band B

Floor Plan

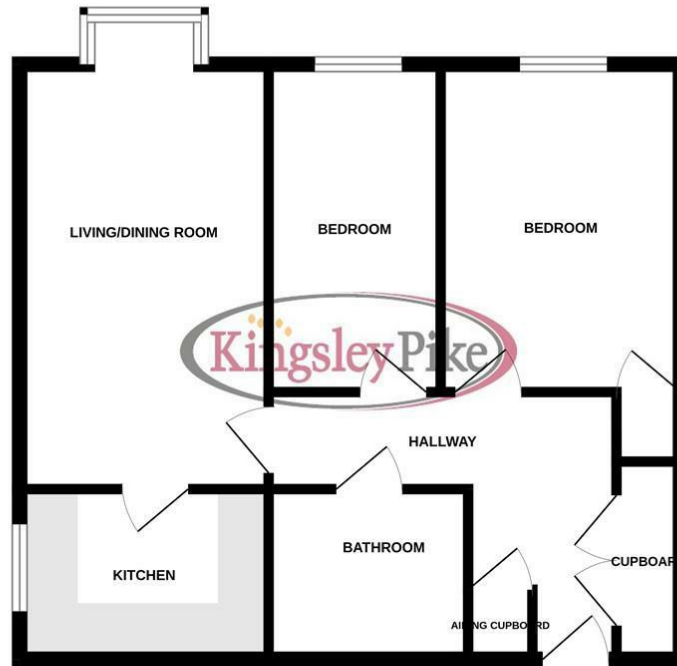

CLIFT HOUSE LANGLEY ROAD SN15 1DS

Whilst every attempt has been made to ensure the accuracy of the floorplan contained here, measurements of doors, windows, rooms and any other items are approximate and no responsibility is taken for any error, omission or mis-statement. This plan is for illustrative purposes only and should be used as such by any prospective purchaser. The services, systems and appliances shown have not been tested and no guarantee as to their operability or efficiency can be given.
Made with Metropix 02/2024

Area Map

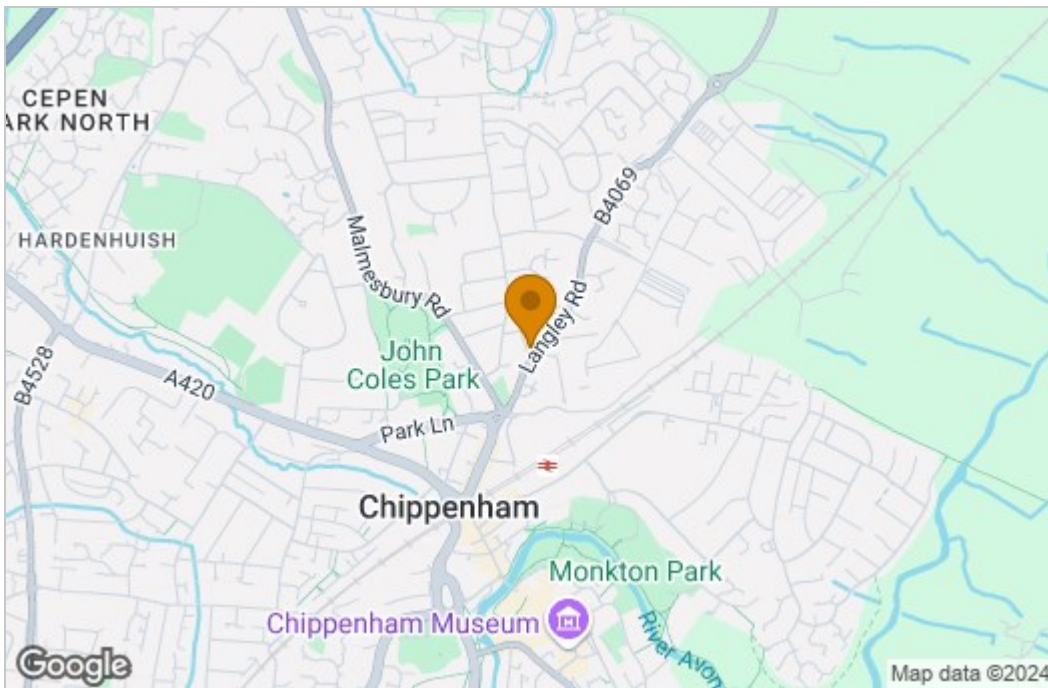

Energy Efficiency Graph

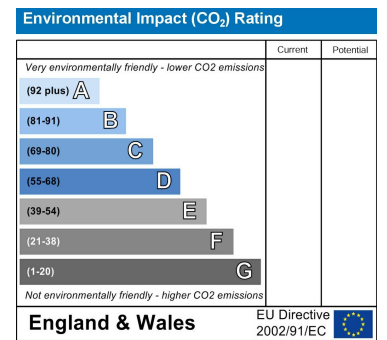
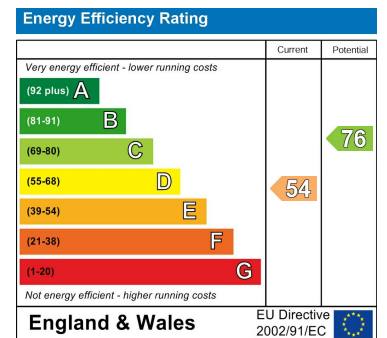

These particulars, whilst believed to be accurate are set out as a general outline only for guidance and do not constitute any part of an offer or contract. Intending purchasers should not rely on them as statements of representation of fact, but must satisfy themselves by inspection or otherwise as to their accuracy. No person in this firm's employment has the authority to make or give any representation or warranty in respect of the property.