



23 Market Mead, Chippenham, SN15 3RZ

£164,950

Located close to both the town Centre and main line railway station, a two bedroom ground floor flat. The accommodation briefly comprises: Communal hall, entrance hallway, living / dining room, fitted kitchen, two bedrooms and bathroom. The property benefits from double glazing and gas central heating, to the rear there is an allocated parking space.

Entrance Hallway

Front door leads into flat entrance with two built in cupboards and entry phone.

Living / Dining Room 16'04 into bay x 13'04"



Double glazed bay window, radiator, opening to kitchen.

Fitted Kitchen 9'08" x 7'09" (2.95m x 2.36m)



Laminated work tops with a range of cupboards and drawers under, also a range of cupboard over, inset stainless steel sink unit, inset gas hob with cooker hood, fitted electric oven, plumbing and space for washing machine, space for fridge / freezer, wall mounted gas boiler.

Bedroom One 11'05" x 10'06" (3.48m x 3.20m)



Double glazed window, built in wardrobes, radiator.

Bedroom Two 15'10" x 10'06" (4.83m x 3.20m)



Double glazed window, radiator.

Bathroom



Panelled bath with over bath shower, pedestal hand basin, W.C., towel radiator.

Outside

Allocated parking space.

Tenure & Council Tax Band

GOV.UK advises the tenure to be Leasehold

GOV .UK advises Band B

Floor Plan

GROUND FLOOR

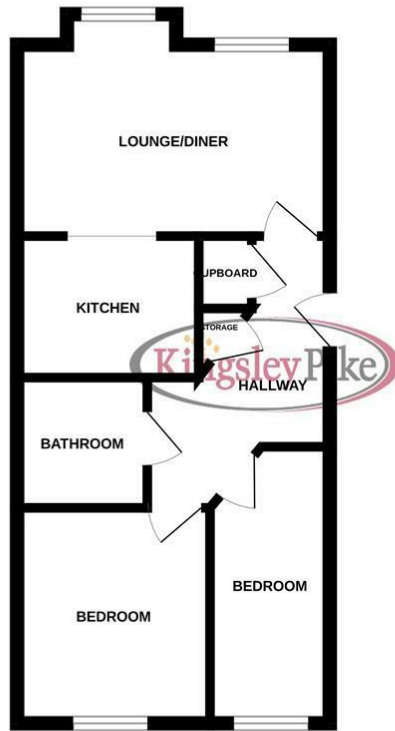

Whilst every attempt has been made to ensure the accuracy of the floorplan contained here, measurements of doors, windows, rooms and any other items are approximate and no responsibility is taken for any error, omission or mis-statement. This plan is for illustrative purposes only and should be used as such by any prospective purchaser. The services, systems and appliances shown have not been tested and no guarantee as to their operability or efficiency can be given.
Made with Metropix ©2023

Area Map

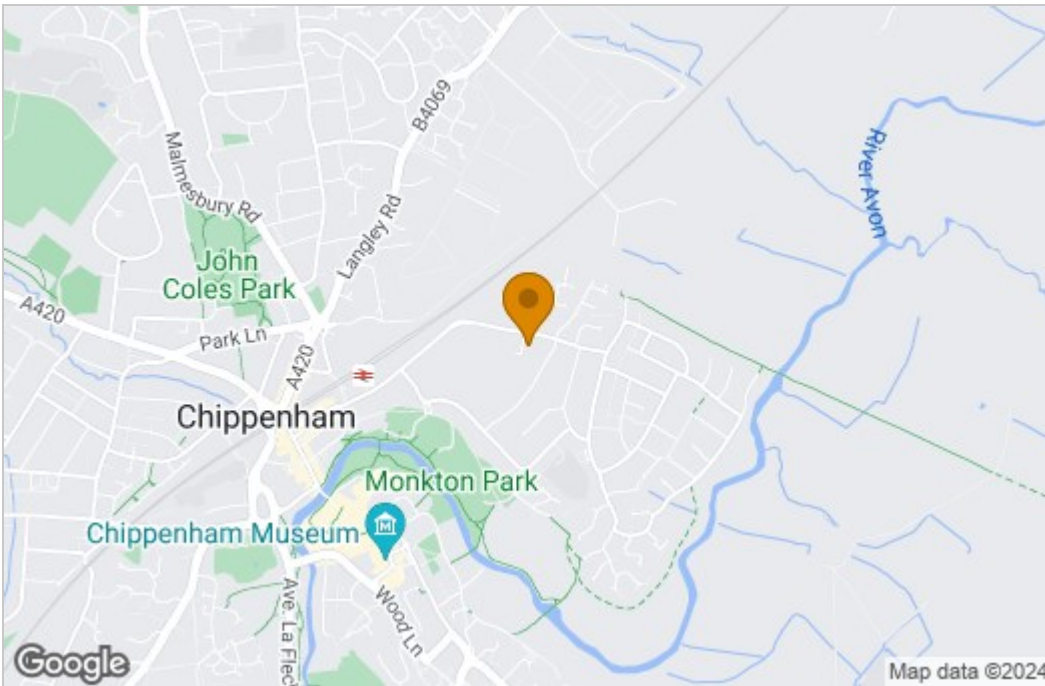

Energy Efficiency Graph

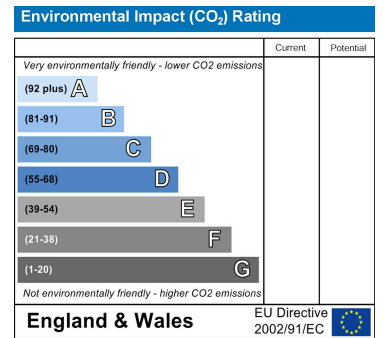
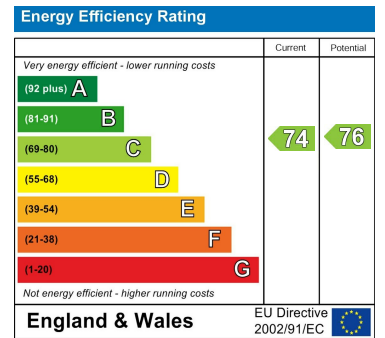

These particulars, whilst believed to be accurate are set out as a general outline only for guidance and do not constitute any part of an offer or contract. Intending purchasers should not rely on them as statements of representation of fact, but must satisfy themselves by inspection or otherwise as to their accuracy. No person in this firm's employment has the authority to make or give any representation or warranty in respect of the property.

63 New Road, Chippenham, Wiltshire, SN15 1ES
 Tel: 01249 464844 Email: sales@kingsleypike.co.uk <https://www.kingsleypike.co.uk>