

## Westhorpe Road, Finningham

Guide Price £280,000 - £290,000

3 1 1



Spacious three bedroom semi-detached house occupying a fantastic corner plot with driveway parking for several cars.

## Key Features

- Guide Price £280,000 - £290,000
- Potential to sell with tenant in situ
- 3 bedrooms
- Parking for several cars
- Large garage with power/light
- Upgraded electric smart heating
- Large corner plot
- Freehold - EPC Rating D
- Council Tax Band C
- Mains drainage

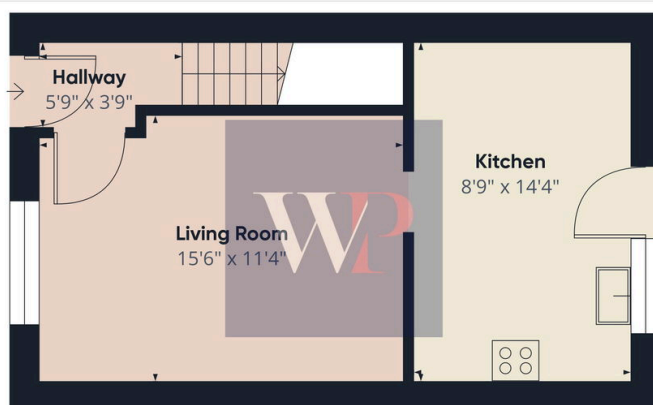

Floor 0 Building 1

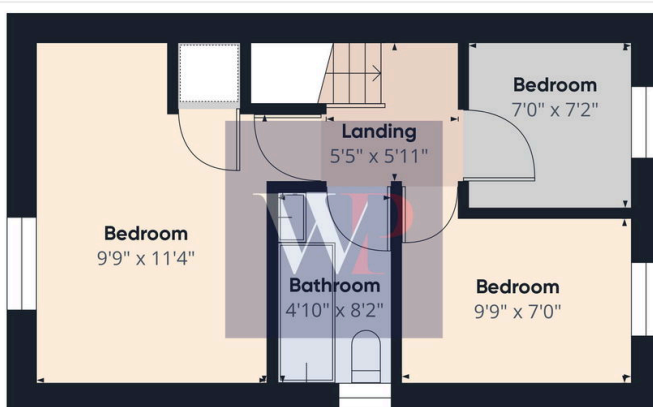

Floor 1 Building 1



Approximate total area<sup>a</sup>  
670.27 ft<sup>2</sup>

(1) Excluding balconies and terraces

While every attempt has been made to ensure accuracy, all measurements are approximate, not to scale. This floor plan is for illustrative purposes only.

Calculations are based on RICS IPMS 3C standard.

GIRAFFE360