



Millfield, Castleton Way, Eye

Guide Price £350,000 - £375,000

 4
  2
  2



Four bedroom detached house with double garage and located close to the town centre and Hartismere school.

Key Features

- Guide Price £350,000 - £375,000
- Double garage
- Close to Hartismere school
- Freehold - EPC Rating D
- Gas heating
- Four bedrooms
- Accommodation in region of 1,100 sq ft
- End of cul-de-sac location
- Council Tax Band D
- Mains drainage



Floor 0

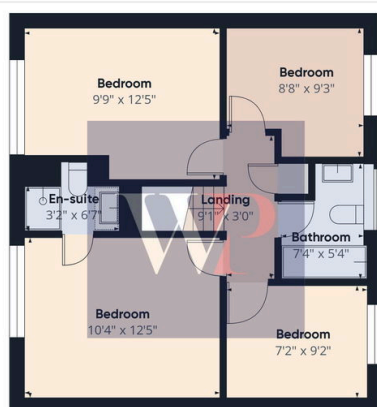

Floor 1



Approximate total areaⁿ
1150.56 ft²

(1) Excluding balconies and terraces

While every attempt has been made to ensure accuracy, all measurements are approximate, not to scale. This floor plan is for illustrative purposes only. Calculations are based on RICS IPMS 3C standard.

GIRAFFE360