

## Pearce Road, Diss

Guide Price £220,000 - £230,000

3 bedrooms 1 bathroom 1 garage



A three bedroom family home with potential to extend (STPP) being sold with no onward chain.

## Key Features

- Guide Price £220,000-£230,000
- No onward chain
- Larger than average plot size for the development
- Extension potential
- Off-road parking & garage
- Freehold
- Gas heating
- EPC Rating C
- Council Tax Band B
- Mains drainage



Floor 0

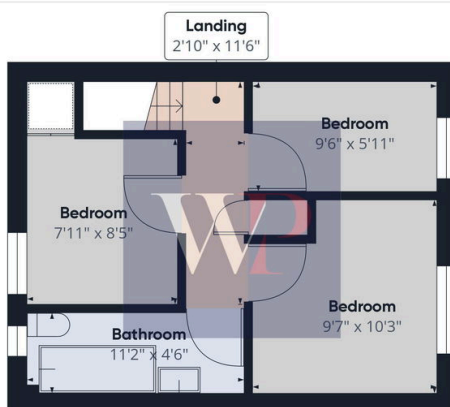

Floor 1



Approximate total area<sup>(1)</sup>  
673.71 ft<sup>2</sup>

(1) Excluding balconies and terraces

While every attempt has been made to ensure accuracy, all measurements are approximate, not to scale. This floor plan is for illustrative purposes only.

GIRAFFE360