

the floorplan...

GROUND FLOOR
439 sq.ft. (40.8 sq.m.) approx.

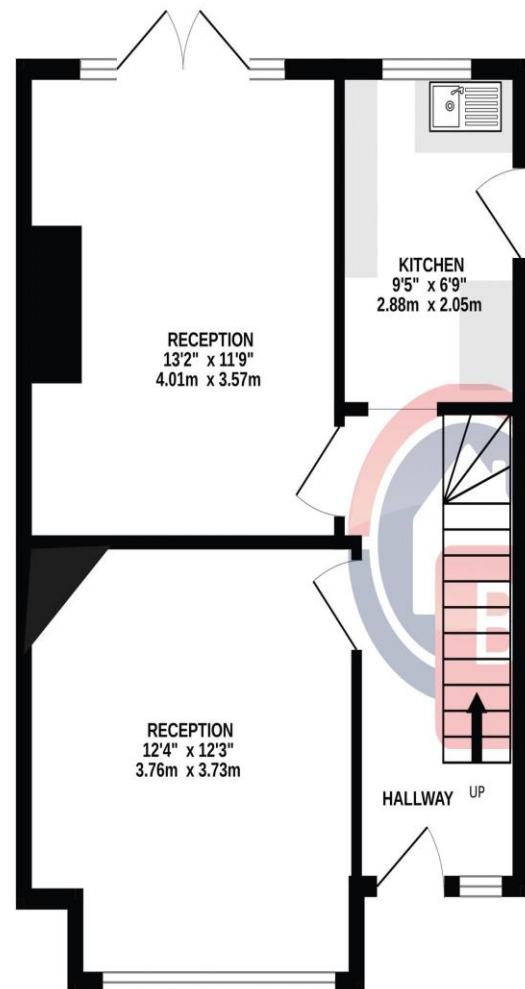

1ST FLOOR
455 sq.ft. (42.3 sq.m.) approx.

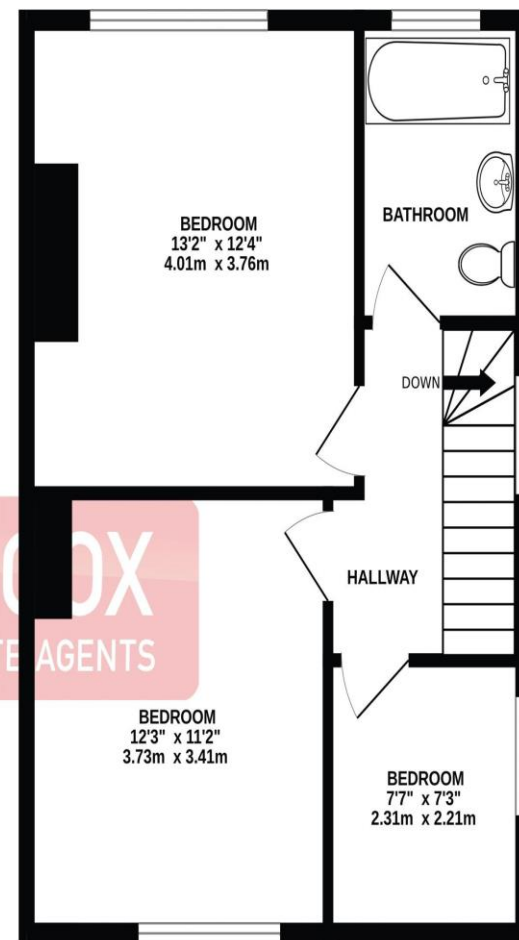

TOTAL FLOOR AREA : 894 sq.ft. (83.1 sq.m.) approx.

Whilst every attempt has been made to ensure the accuracy of the floorplan contained here, measurements of doors, windows, rooms and any other items are approximate and no responsibility is taken for any error, omission or mis-statement. This plan is for illustrative purposes only and should be used as such by any prospective purchaser. The services, systems and appliances shown have not been tested and no guarantee as to their operability or efficiency can be given.
Made with Metropix ©2025

more details from...

call: Brian Cox Greenford: 0208 578 1004
email: emma.gerald@brian-cox.co.uk
web: www.brian-cox.co.uk



0208 578 1004
brian-cox.co.uk



THREE BEDROOM - SEMI-DETACHED HOUSE - NO CHAIN - POTENTIAL TO EXTEND (STPP). Brian Cox and Company are proud to bring to the market this three-bedroom semi-detached family home. The property is located on a very popular residential road and briefly consists of two reception rooms, kitchen, three bedrooms and a family bathroom. Further benefits include double glazing, large rear garden, as well as being offered with no onward chain. Viewings are highly recommended so call now to arrange yours!!



£550,000
Freehold

Bennetts Avenue, Greenford UB6 8AU

Consumer Protection from Unfair Trading Regulations 2008 We have not tested any apparatus, equipment, fixtures, fittings or services and so cannot verify that they are in working order or fit for purpose. You are advised to obtain verification from your solicitor or surveyor. References to the tenure of a property are based on information supplied by the seller. We have not had sight of the title documents and a buyer is advised to obtain verification from their solicitor. Items shown in photographs are not included unless specifically mentioned within the sales particulars, but may be available by separate negotiation. We advise you to book an appointment to view before embarking on any journey to see a property, and check its availability.



in brief...

- Three Bedroom
- Semi-Detached House
- No Chain
- Large Rear Garden
- In Need of Updating
- Potential to Extend (STPP)



the location...

nearest stations ...

Greenford (0.3 miles)
South Greenford (0.4 miles)
Perivale (0.9 miles)

Greenford is a large suburb in the London Borough of Ealing in West London, UK. It was an ancient parish in the historic county of Middlesex. It is 11 miles (18 km) from Charing Cross in Central London.

There are several local primary schools in the area which include Oldfield Primary School, Edward Betham CofE Primary School, Coston Primary School, Our Lady of Visitation Catholic Primary School and Selborne Primary School.

If you have older children there are also local secondary schools nearby these include William Perkin Church of England High School, Greenford High School, Cardinal Wiseman Catholic High School and Brentside High School.

0208 578 1004

brian-cox.co.uk