

# the floorplan...

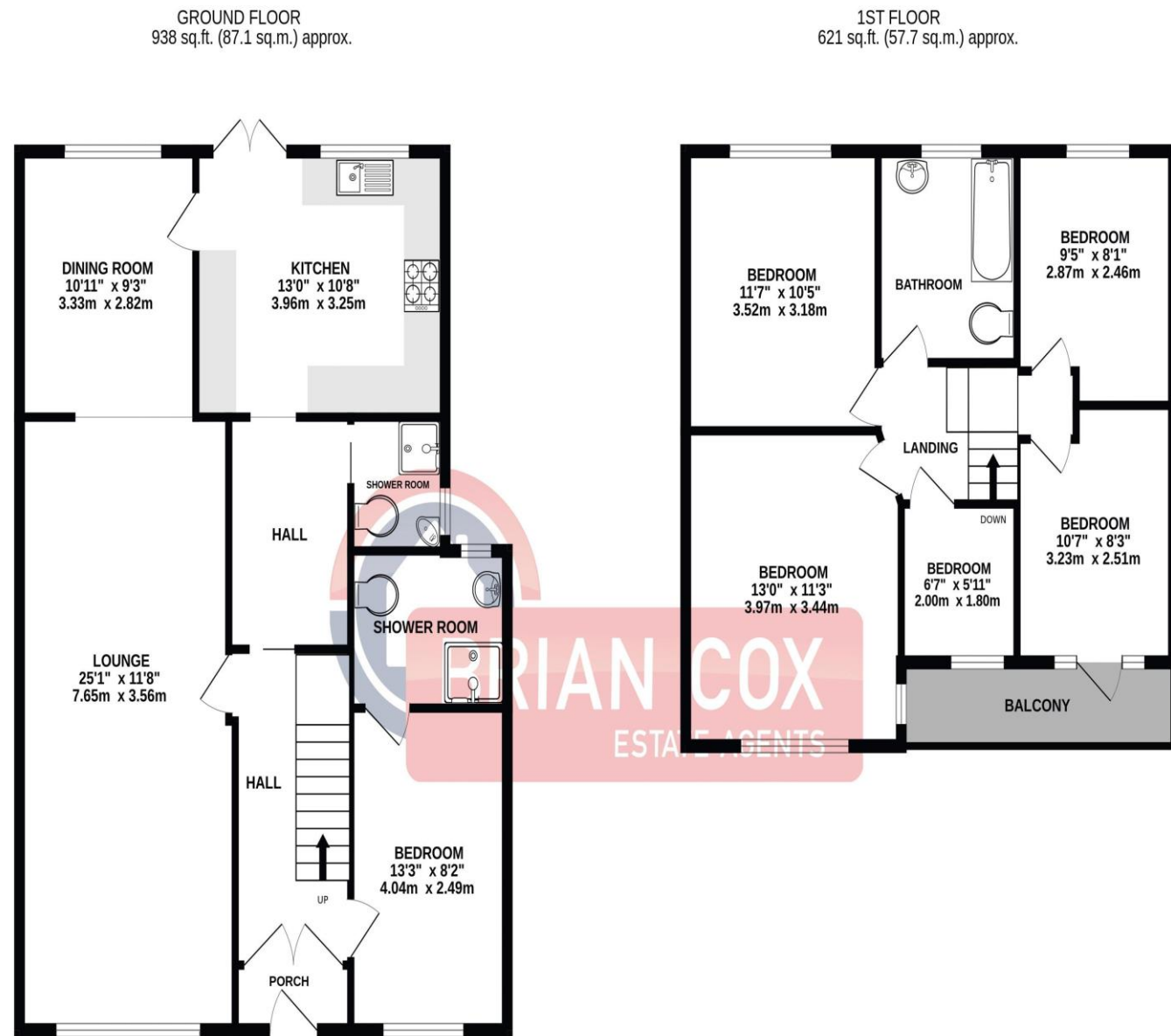

TOTAL FLOOR AREA: 1559 sq.ft. (144.8 sq.m.) approx.  
 Whilst every attempt has been made to ensure the accuracy of the floorplan contained here, measurements of doors, windows, rooms and any other items are approximate and no responsibility is taken for any error, omission or mis-statement. This plan is for illustrative purposes only and should be used as such by any prospective purchaser. The services, systems and appliances shown have not been tested and no guarantee as to their operability or efficiency can be given.  
 Made with Metropix ©2024

## more details from...

call: **Brian Cox Greenford: 0208 578 1004**  
 email: [emma.gerald@brian-cox.co.uk](mailto:emma.gerald@brian-cox.co.uk)  
 web: [www.brian-cox.co.uk](http://www.brian-cox.co.uk)



0208 578 1004  
[brian-cox.co.uk](http://brian-cox.co.uk)



SIX BEDROOM - SEMI-DETACHED - DOUBLE FRONTED - THREE BATHROOMS - OFF STREET PARKING - PRIVATE REAR GARDEN. Brian Cox and Company are delighted to bring to the market this substantial six-bedroom family home in Perivale. The property briefly comprises a large porch, through lounge, modern fitted kitchen, dining room, downstairs shower room, utility space and a downstairs bedroom with an en-suite on the ground floor. The first floor boasts five bedrooms, one with a balcony and a family bathroom. Further benefits include off street parking, private rear garden, ample storage and much more. Viewings are highly recommended to fully appreciate this wonderful home so call to arrange your chance to view!



£750,000  
 Freehold

Langdale Gardens, Perivale UB6 8DG



## in brief...

- Six Bedroom
- Three Bathrooms
- Semi-Detached House
- Off Street Parking
- Double Glazed / Gas Central Heating
- 0.4 Miles from Perivale Station



## the location...

### nearest stations ...

Perivale (0.4 miles)  
Alperton (0.9 miles)  
South Greenford (0.9 miles)



The property is situated in the London Borough of Ealing and benefits from a number of local amenities including Perivale Community Centre, Perivale Library, Sudbury Golf Club and Ealing Central Sports Ground to name a few.

Perivale has a station on the Central Line of the London Underground system and is also near to Alperton tube station on the Piccadilly Line. Three bus routes (95, E5 and 297) link the town to Shepherds Bush, Ealing, Greenford, Southall, Wembley and Willesden.

There are many local schools in the area some include Vicar's Green Primary School, St John Fisher Catholic Primary School, Perivale Primary School and North Ealing Primary School.

