

the floorplan...

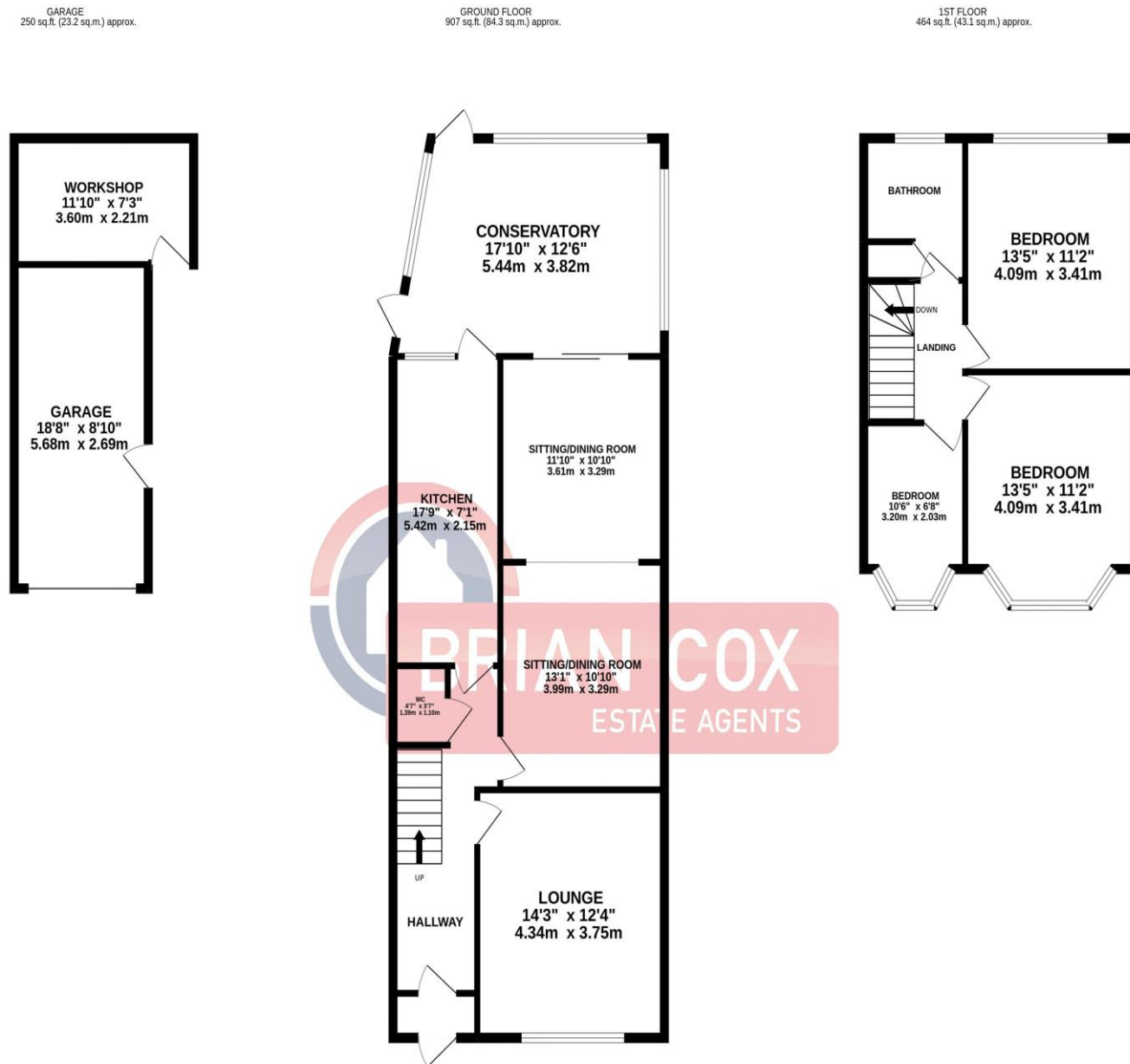

TOTAL FLOOR AREA : 1621 sq.ft. (150.6 sq.m.) approx.

Whilst every attempt has been made to ensure the accuracy of the floorplan contained here, measurements of doors, windows, rooms and any other items are approximate and no responsibility is taken for any error, omission or mis-statement. This plan is for illustrative purposes only and should be used as such by any prospective purchaser. The services, systems and appliances shown have not been tested and no guarantee as to their operability or efficiency can be given.
Made with Metropix ©2022

more details from...

call: **Brian Cox Greenford: 0208 578 1004**

email: emma.gerald@brian-cox.co.uk

web: www.brian-cox.co.uk



0208 578 1004
brian-cox.co.uk



THREE BEDROOM - SEMI-DETACHED FREEHOLD HOUSE - OFF STREET PARKING - EXTENDED. Brian Cox and Company are delighted to present to the market this three-bedroom extended freehold semi-detached family home. The property is conveniently located within easy reach of Greenford Station, the A40, Westway Cross Retail Park and William Perkin CofE High school. Viewings are available now so call to arrange yours!!



£635,000
Freehold

Greenford Road, Greenford UB6 8QP

Consumer Protection from Unfair Trading Regulations 2008 We have not tested any apparatus, equipment, fixtures, fittings or services and so cannot verify that they are in working order or fit for purpose. You are advised to obtain verification from your solicitor or surveyor. References to the tenure of a property are based on information supplied by the seller. We have not had sight of the title documents and a buyer is advised to obtain verification from their solicitor. Items shown in photographs are not included unless specifically mentioned within the sales particulars, but may be available by separate negotiation. We advise you to book an appointment to view before embarking on any journey to see a property, and check its availability.



in brief...

- Three Bedroom
- Semi-Detached House
- Extended
- Off Street Parking
- Garage
- Convenient Location



the location...

nearest stations ...

- Greenford Station (0.3 miles)
- South Greenford Station (0.4 miles)
- Perivale Station (0.9 miles)



Greenford is a large suburb in the London Borough of Ealing in West London, UK. It was an ancient parish in the historic county of Middlesex. It is 11 miles (18 km) from Charing Cross in Central London.

There are several primary schools in the area which include Coston Primary School, Selborne Primary School, The Edward Betham Church of England Primary School and Coston Primary School.

If you have older children there are also local secondary schools nearby which are William Perkin Church of England High School, Brentside High School and The Cardinal Wiseman Catholic School.

