

the floorplan...

GARAGE
250 sq.ft. (23.2 sq.m.) approx.

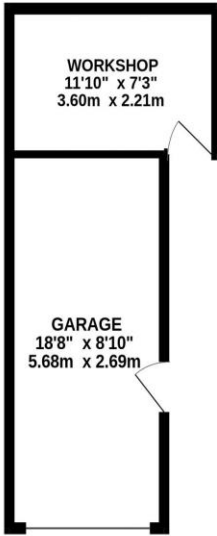

GROUND FLOOR
907 sq.ft. (84.3 sq.m.) approx.

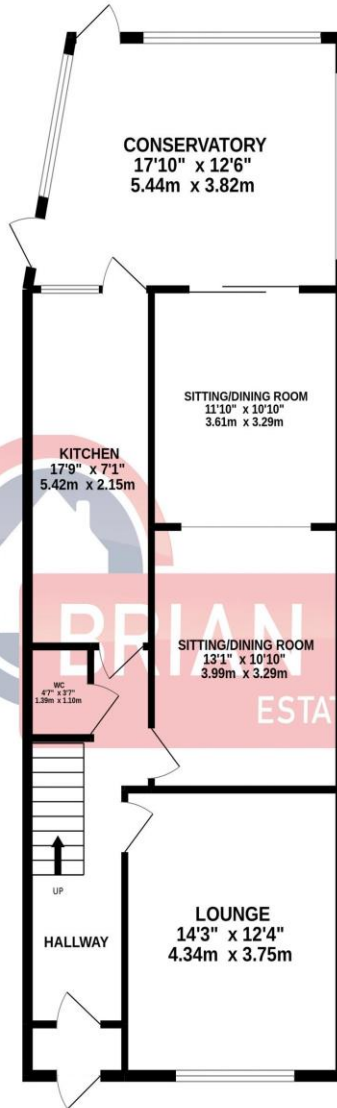

1ST FLOOR
464 sq.ft. (43.1 sq.m.) approx.

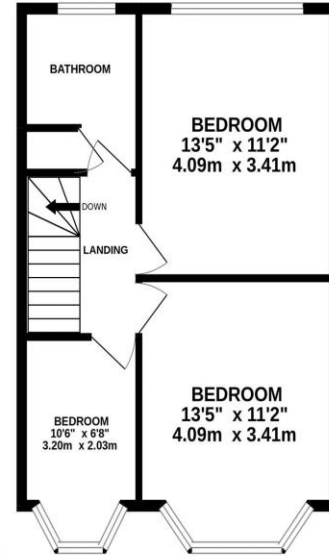

TOTAL FLOOR AREA: 1621 sq.ft. (150.6 sq.m.) approx.

Whilst every attempt has been made to ensure the accuracy of the floorplan contained here, measurements of doors, windows, rooms and any other items are approximate and no responsibility is taken for any error, omission or mis-statement. This plan is for illustrative purposes only and should be used as such by any prospective purchaser. The services, systems and appliances shown have not been tested and no guarantee as to their operability or efficiency can be given.
Made with Metropix ©2022

more details from...

call: **Brian Cox North Greenford: 0208 578 1004**
email: daniel.jed@brian-cox.co.uk
web: www.brian-cox.co.uk



0208 578 1004
brian-cox.co.uk



THREE BEDROOM - SEMI-DETACHED
FREEHOLD HOUSE - OFF STREET PARKING
- EXTENDED. Brian Cox and Company are
delighted to present to the market this
three bedroom extended freehold semi-
detached family home. The property is
conveniently located within easy reach of
Greenford Station, the A40, Westway
Cross Retail Park and William Perkin CofE
High school. Viewings are available now
so call to arrange yours!!



£635,000
Freehold

Greenford Road, Greenford UB6 8QP

Consumer Protection from Unfair Trading Regulations 2008 We have not tested any apparatus, equipment, fixtures, fittings or services and so cannot verify that they are in working order or fit for purpose. You are advised to obtain verification from your solicitor or surveyor. References to the tenure of a property are based on information supplied by the seller. We have not had sight of the title documents and a buyer is advised to obtain verification from their solicitor. Items shown in photographs are not included unless specifically mentioned within the sales particulars, but may be available by separate negotiation. We advise you to book an appointment to view before embarking on any journey to see a property, and check its availability.