

# the floorplan...

GROUND FLOOR  
501 sq.ft. (46.5 sq.m.) approx.

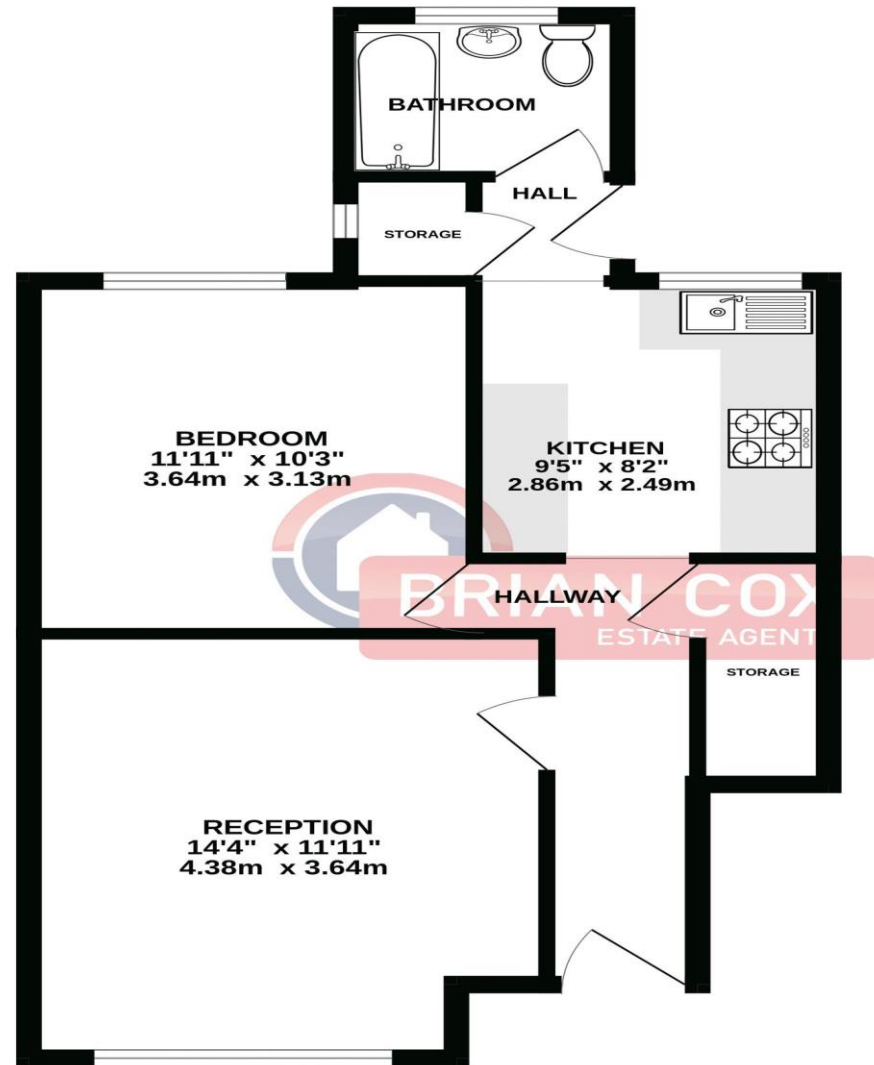

TOTAL FLOOR AREA : 501 sq.ft. (46.5 sq.m.) approx.  
Whilst every attempt has been made to ensure the accuracy of the floorplan contained here, measurements of doors, windows, rooms and any other items are approximate and no responsibility is taken for any error, omission or mis-statement. This plan is for illustrative purposes only and should be used as such by any prospective purchaser. The services, systems and appliances shown have not been tested and no guarantee as to their operability or efficiency can be given.  
Made with Metropix ©2024

## more details from...

call: **Brian Cox Greenford: 0208 578 1004**  
email: [emma.gerald@brian-cox.co.uk](mailto:emma.gerald@brian-cox.co.uk)  
web: [www.brian-cox.co.uk](http://www.brian-cox.co.uk)



Consumer Protection from Unfair Trading Regulations 2008 We have not tested any apparatus, equipment, fixtures, fittings or services and so cannot verify that they are in working order or fit for purpose. You are advised to obtain verification from your solicitor or surveyor. References to the tenure of a property are based on information supplied by the seller. We have not had sight of the title documents and a buyer is advised to obtain verification from their solicitor. Items shown in photographs are not included unless specifically mentioned within the sales particulars, but may be available by separate negotiation. We advise you to book an appointment to view before embarking on any journey to see a property, and check its availability.



0208 578 1004  
[brian-cox.co.uk](http://brian-cox.co.uk)



**CASH BUYERS ONLY!! ONE BEDROOM - GROUND FLOOR MAISONETTE - FRONT AND REAR GARDENS - NO CHAIN.** Brian Cox and Company are delighted to bring to the market this one-bedroom ground floor maisonette. The property briefly consists of a lounge, double bedroom, bathroom and fitted kitchen. Located within easy reach of Greenford Station, the a40 as well as local schools and shops. Further benefits include double glazing, gas central heating and both the front and rear gardens. All in all this is an ideal home so call now to arrange your chance to view and avoid disappointment!!



£240,000  
Leasehold

Jeymer Drive, Greenford UB6 8NU



## in brief...

- One Bedroom
- Ground Floor Maisonette
- Front and Rear Gardens
- Double Glazed / Gas Central Heating
- Convenient Location
- Approx. 45 Year Lease



## the location...

### nearest stations ...

- Greenford (0.5 miles)
- Northolt (0.7 miles)
- South Greenford (1.0 miles)



Greenford is a large suburb in the London Borough of Ealing in West London, UK. It was an ancient parish in the historic county of Middlesex. It is 11 miles (18 km) from Charing Cross in Central London.

There are several local primary schools in the area which include Oldfield Primary School, Coston Primary School, Edward Betham Church of England Primary School, and Ravenor Primary School.

If you have older children there are also local secondary schools some of these include William Perkin Church of England High School, Greenford High School and The Cardinal Wiseman Catholic School.

