



**15 Lime Way, Radlett
Hertfordshire WD7 9FH
Guide Price £530,000**

Nestled within the highly popular 'Harperbury' development and built by Bloor Homes, is this delightful semi-detached three bedroom house that offers a perfect blend of modern living and comfort. Built in 2020, the property boasts a contemporary design and is well-suited for families or professionals seeking a peaceful yet convenient location.

Offered CHAIN FREE and in immaculate condition throughout, living accommodation comprises of a spacious lounge at the front of the property, with a stunning kitchen diner to the rear with built in island, separate utility space and a downstairs WC. Upstairs, there are three bedrooms (two doubles and one single) and two bathrooms (including one en-suite).

With a low maintenance rear garden (fully paved) and gated rear access to two allocated parking bays to the rear, this property would be an ideal downsize, first time buy or family home and immediate viewing is highly recommended.

EPC Rating Band B.



Entrance Hall

Lounge

14'2 x 11'10 at max points (4.32m x 3.61m at max points)

Kitchen Diner

12'2 x 11'10 (3.71m x 3.61m)

WC

Landing

Master Bedroom

9'8 x 8'5 excluding wardrobes (2.95m x 2.57m excluding wardrobes)

En-Suite Shower Room

Bedroom Two

11'8 x 8'10 at max points (3.56m x 2.69m at max points)

Bedroom Three

11'8 x 6'5 at max points (3.56m x 1.96m at max points)

Family Bathroom

Rear Garden

Parking

2 allocated parking bays to the rear of the property

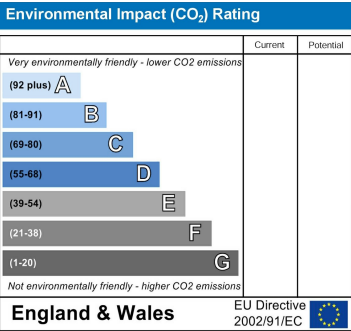
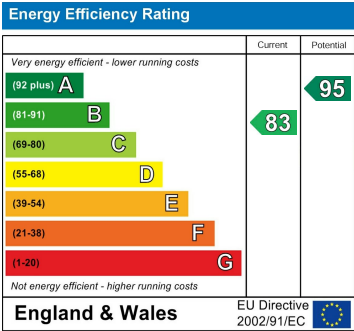

20 Andrew Close, Shenley | Herts WD7 9LP
Tel: 01923 856464 | Email: info@shenleyestates.com



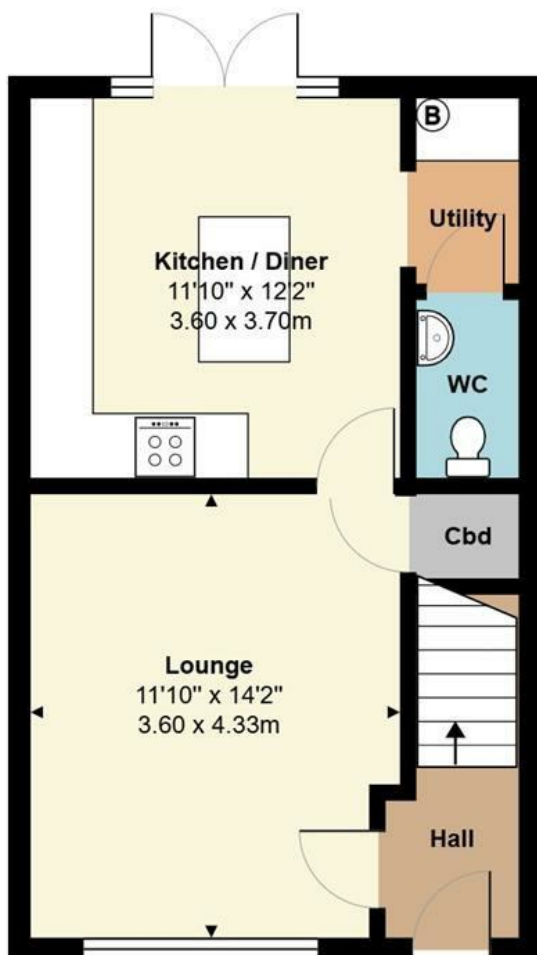

Ground Floor
Area: 419 ft² ... 38.9 m²

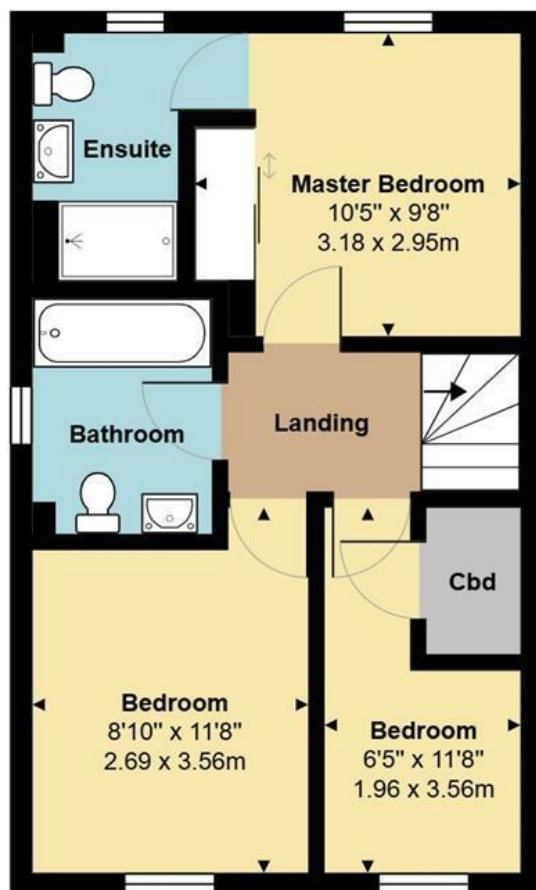

First Floor
Area: 419 ft² ... 38.9 m²

Total Area: 838 ft² ... 77.8 m²
All measurements are approximate and for display purposes only

