



**18 Birchwood Newcome Road, Shenley
Herts WD7 9ET
Guide Price £495,000**

Tucked away in the heart of Shenley Village is this lovely three bedroom end of terrace house. In a quiet pathway off of Newcome Road lies this well maintained and deceptively spacious cottage style house.

In addition to the three bedrooms (with two generous doubles) and family bathroom, the downstairs living space is open plan with a kitchen to the front and both dining and living space to the rear overlooking the south-easterly landscaped garden which benefits from an outdoor brick built shed.

The property also benefits from a lovely front garden and some countryside views.

Energy Rating Band D.



Entrance Hall

Downstairs WC

Kitchen Breakfast Room
13'11 x 11'2 (4.24m x 3.40m)

Lounge
17'4 x 11'9 (5.28m x 3.58m)

Landing

Bedroom One
13'3 x 10'6 (4.04m x 3.20m)

Bedroom Two
12'4 x 10'1 (3.76m x 3.07m)

Bedroom Three
8'11 x 7' (2.72m x 2.13m)

Family Bathroom

Rear Garden

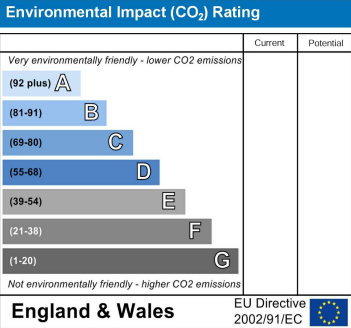
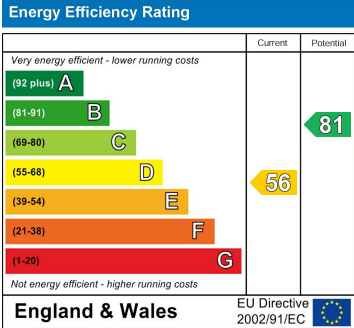

20 Andrew Close, Shenley | Herts WD7 9LP
Tel: 01923 856464 | Email: info@shenleyestates.com



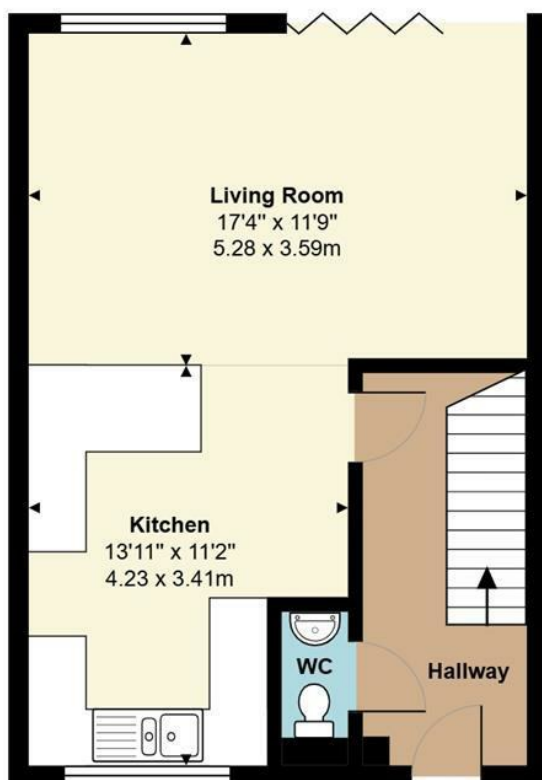

Ground Floor
Area: 458 ft² ... 42.5 m²

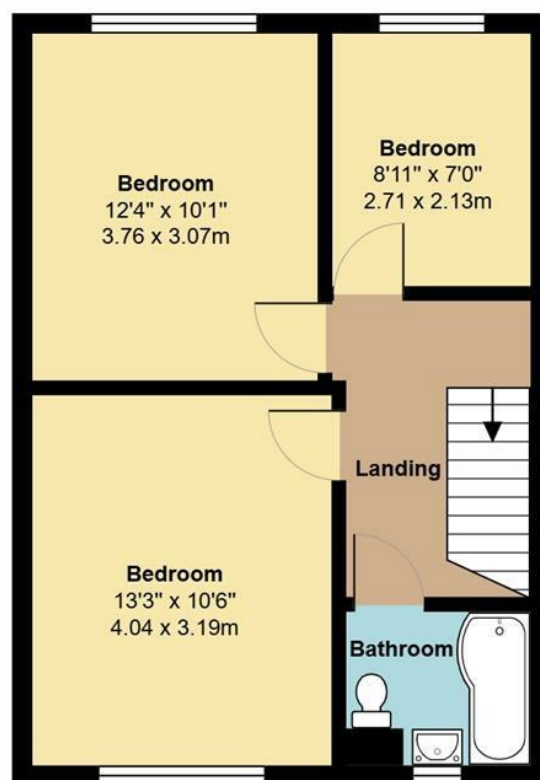

First Floor
Area: 458 ft² ... 42.5 m²



Total Area: 916 ft² ... 85.1 m²
All measurements are approximate and for display purposes only

