



**15 Fielders Way, Shenley
 Hertfordshire WD7 9EY
 Guide Price £450,000**

Offered for sale CHAIN FREE is this lovely two bedroom Crest built house located on a popular close on Porters Park. Accommodation comprises two double bedrooms, updated bathroom, fitted kitchen, downstairs wc and a lovely bright and spacious lounge diner.



The property also benefits from a SW facing sunny aspect garden and allocated OSP for two cars. Immediate viewing is strongly recommended.

Energy Rating Band C.



Entrance Hall

Downstairs Cloakroom

Kitchen
9'10 x 5'9 (3.00m x 1.75m)

Lounge Diner
15'9 x 12 (4.80m x 3.66m)

Landing

Bedroom One
12 x 9'7 (3.66m x 2.92m)

Bedroom Two
12 x 9'7 (3.66m x 2.92m)

Bathroom

Rear Garden

Parking
Allocated parking for 2 cars in front of the property

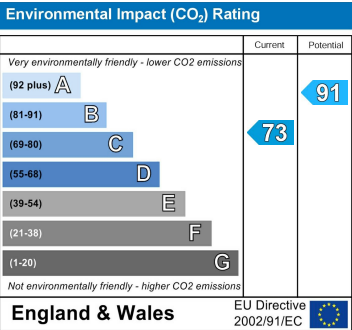
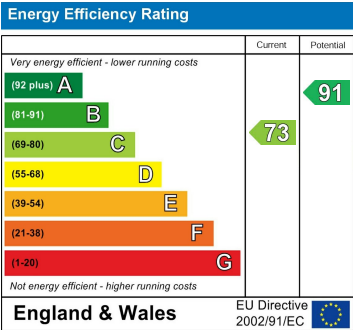

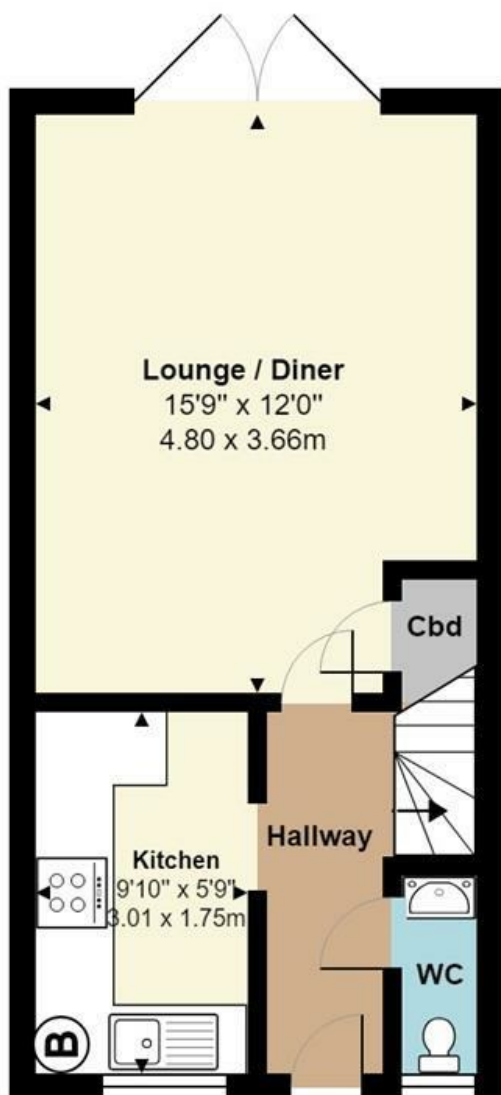

Area: 314 ft² ... 29.1 m²

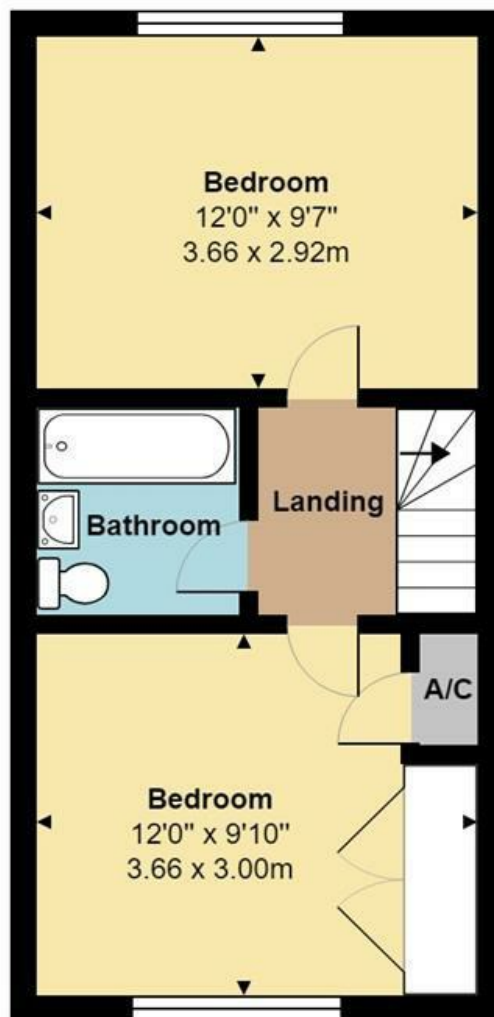

Area: 314 ft² ... 29.1 m²

Total Area: 627 ft² ... 58.3 m²

All measurements are approximate and for display purposes only

