



**14 Fielders Way, Shenley
Hertfordshire WD7 9EY
Guide Price £510,000**

Offered for sale is this lovely three bedroom end of terrace house at the top end of Porters Park.

Accommodation comprises three bedrooms, family bathroom, downstairs wc, kitchen and spacious lounge dining room.

This is a lovely bright house, and whilst in need of some updating, benefits from a lovely level sunny aspect garden, off street parking and being located close to all local amenities including Shenley Park, bus stops and local shops.

This is a fabulous opportunity to secure a lovely home that you can truly make your own.

EPC Rating Band C.



Entrance Hall

Downstairs WC

Lounge Diner

16'8 excluding bay window x 15'1 at max points (5.08m excluding bay window x 4.60m at max points)

Kitchen

15'1 x 8'10 (4.60m x 2.69m)

Landing

Bedroom One

13'5 into wardrobes x 8'10 (4.09m into wardrobes x 2.69m)

Bedroom Two

12'2 x 8'5 (3.71m x 2.57m)

Bedroom Three

8'10 x 6'5 (2.69m x 1.96m)

Bathroom

Rear Garden

Parking

Driveway for one car in front of the property

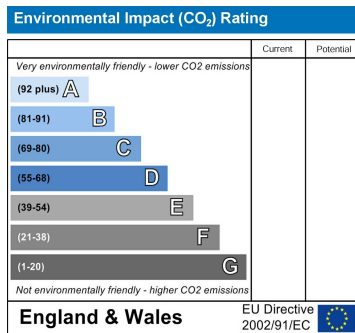
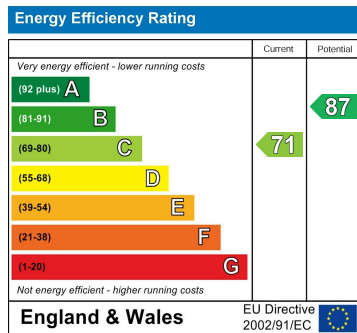

20 Andrew Close, Shenley | Herts WD7 9LP
 Tel: 01923 856464 | Email: info@shenleyestates.com



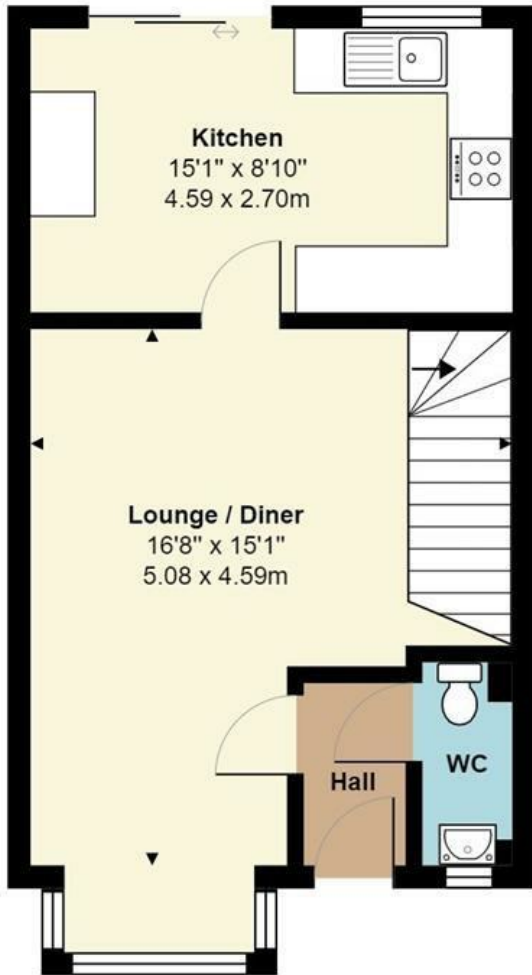

Ground Floor
Area: 409 ft² ... 38.0 m²

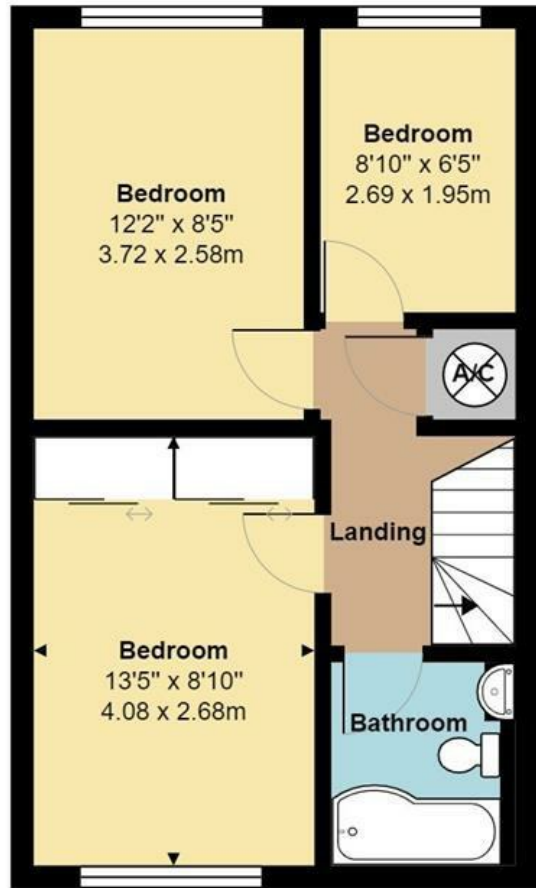

First Floor
Area: 393 ft² ... 36.5 m²

Total Area: 803 ft² ... 74.6 m²
All measurements are approximate and for display purposes only

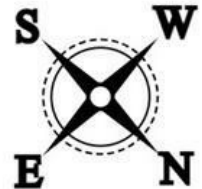

20 Andrew Close, Shenley | Herts WD7 9LP
Tel: 01923 856464 | Email: info@shenleyestates.com

