



**20 Greenwood Gardens, Shenley
Hertfordshire WD7 9LF
Guide Price £425,000**

Offered for sale CHAIN FREE is this well presented Crest built two bedroom house located at the top end of Porters Park. Accommodation comprises two double bedrooms with fitted wardrobes, bathroom, fitted kitchen, downstairs wc and spacious lounge diner along with allocated parking for two cars in front of the property. Immediate viewing is essential.

Energy rating C.



Entrance Hall

Downstairs Cloakroom

Kitchen

9'9 x 5'9 (2.97m x 1.75m)

Lounge Diner

15'9 x 12'2 max (4.80m x 3.71m max)

Landing

Bedroom One

12'2 max x 9'10 into wardrobes (3.71m max x 3.00m into wardrobes)

Bedroom Two

12'2 x 9'9 into wardrobes (3.71m x 2.97m into wardrobes)

Bathroom

Rear Garden

West Facing.

Parking

Parking for 2 cars in front of the property

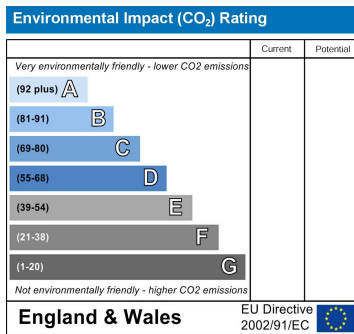
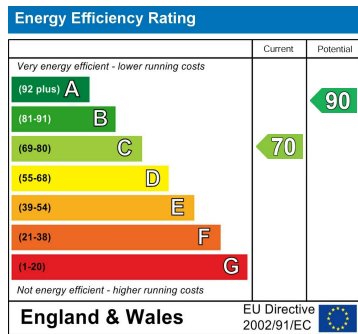

20 Andrew Close, Shenley | Herts WD7 9LP
 Tel: 01923 856464 | Email: info@shenleyestates.com



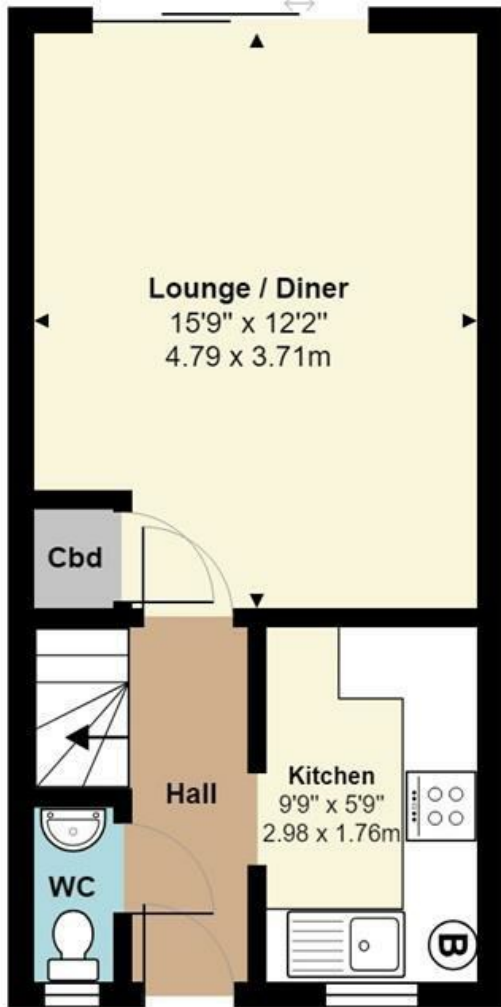
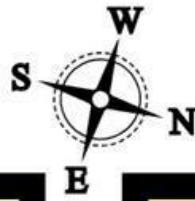

Ground Floor
Area: 315 ft² ... 29.3 m²

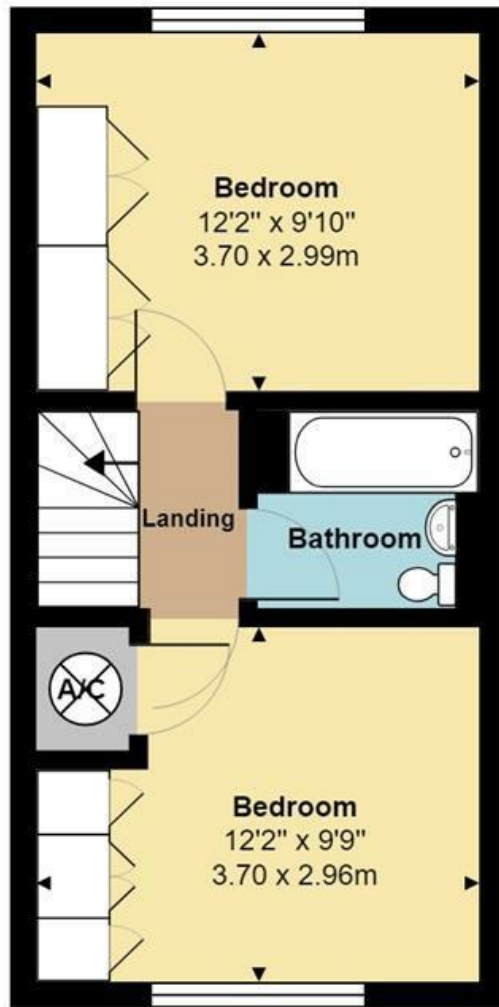

First Floor
Area: 315 ft² ... 29.3 m²

Total Area: 631 ft² ... 58.6 m²

All measurements are approximate and for display purposes only



20 Andrew Close, Shenley | Herts WD7 9LP
Tel: 01923 856464 | Email: info@shenleyestates.com

