



Albert Place | Methley | LS26 9EN

By Auction £90,000

Two bedroom End Terrace | EPC TBC | Council Tax B

Emsleys | estate agents

***RARE OPPORTUNITY. EXTENSIVE PLOT & GARDEN. TUCKED AWAY LOCATION. ***

View, bid, buy! For sale by Modern Method of Auction; Starting Bid Price £90,000 plus Reservation Fee. (Please see agents notes for further information).

Introducing a end terraced property on the market for sale, in need of a loving touch to restore its potential. This classic home is nestled in a quiet and peaceful location, surrounded by green spaces offering tranquility and a serene environment.

The home boasts reception room, kitchen providing the essentials for everyday cooking and dining. The kitchen space offers a canvas for you to design your ideal culinary space, whether you aspire to have a modern and sleek kitchen or a more rustic farmhouse style.

With two double bedrooms offering great potential for personalization and decoration to suit your style and needs. Adding to the conveniences of this home is a bathroom, offering a private space.

This classic terraced property, is in need of renovation and personal touch, could transform into a charming and comfortable home.

Its tranquil location and potential-filled spaces make it an exciting opportunity for those looking for a project or investment.

Ground Floor

Kitchen/Dining Room 3.28m x 4.30m (10'9" x 14'1")

Wall mounted central heating boiler, under stairs storage cupboard. Double glazed window to the side and rear, double glazed rear entry door.

Living Room 3.88m x 3.37m (12'9" x 11'1")

Double glazed window and door to the front, stairs to the first floor.

First Floor

Landing

Door to:

Bedroom 1 3.83m x 3.37m (12'7" x 11'1")

Positioned to the front, central heating radiator

Bedroom 2 3.33m x 2.62m (10'11" x 8'7")

Positioned to the rear, central heating radiator

Bathroom 2.43m x 1.73m (8'0" x 5'8")

Positioned to the rear, three piece colored suite

External

To the front is a lawn garden and to the rear is a small yard



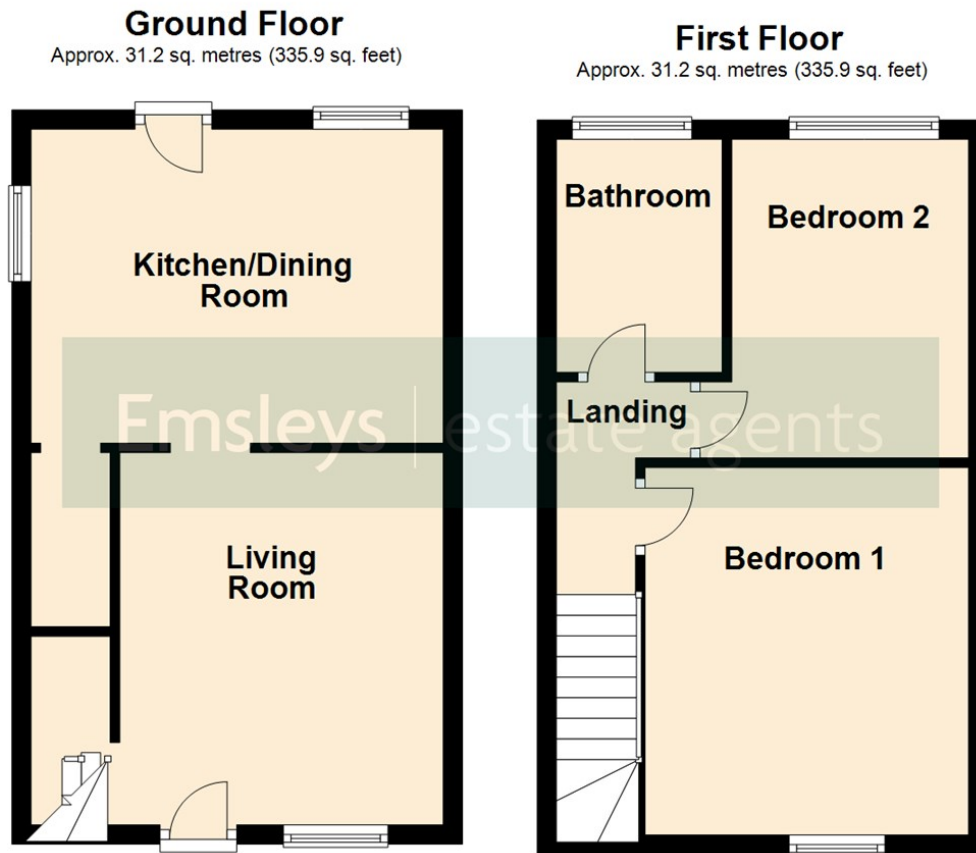

Total area: approx. 62.4 sq. metres (671.7 sq. feet)

These details are for guidance only and complete accuracy cannot be guaranteed. If there is any point, which is of particular importance, verification should be obtained. They do not constitute a contract or part of a contract. All measurements are approximate. No guarantee can be given with regard to planning permissions or fitness for purpose. No apparatus, equipment, fixture or fitting has been tested. Items shown in photographs are NOT necessarily included. Interested Parties are advised to check availability and make an appointment to view before travelling to see a property.

65 Commercial Street | Rothwell | Leeds | LS26 0QD
t: 0113 201 4040 www.emsleysestateagents.co.uk

Emsleys | estate agents