



Durham Road, Stockton-On-Tees, TS19 0PX

Offered with no onward chain, this well presented three bedroom, double fronted detached bungalow features a detached garage and a south-west facing rear garden.

The accommodation includes a spacious entrance hall leading to a good sized lounge with a bay window and feature fireplace. At the rear, a large open plan kitchen and dining room is fitted with contemporary units, granite worktops, and integrated Zanussi double oven and gas hob, a dishwasher and fridge. From the dining area, stairs lead to a third double bedroom with eaves storage. The kitchen opens onto a sun room and a useful utility area. On the ground floor are two further double bedrooms, one with a bay window and fitted wardrobes, along with a modern fully tiled shower room with a large walk-in rainfall shower.

The property benefits from being newly rendered and damp proofed in 2024, a new security alarm (2024), a modern Worcester boiler and tall ceilings. Externally, a block paved driveway leads to a parking and turning area, softened by established borders and shrubs. Double gates at the side give access to the extended driveway and large single garage. The rear garden is enclosed by new fencing and offers lawns, planted borders and a paved patio to enjoy the afternoon and evening sun.

Ideally located close to shops, schools and essential amenities, with easy access to North Tees Hospital and excellent commuter links via the A19, this property will appeal to a range of buyers, including families and those looking for single storey living.

£325,000



3



1



2



Durham Road, Stockton-On-Tees, TS19 0PX

HALL

LOUNGE
14' x 11'10" (4.27m x 3.61m)

KITCHEN/DINING ROOM
15'1" x 14'6" (4.60m x 4.42m)

SUN ROOM
16'3" x 6'3" (4.95m x 1.91m)

BEDROOM ONE
14' x 12' (4.27m x 3.66m)

BEDROOM TWO
11' x 11' (3.35m x 3.35m)

BATHROOM

LANDING

BEDROOM THREE
12'11" x 10'1" (3.94m x 3.07m)

AML PROCEDURE
To comply with anti-money laundering regulations (AML) all estate agents must be registered with HMRC. Gowland White complies with this legislation by using an online AML risk assessment company, approved by the UK Government. Please note that all buyers are charged a fee of £36.00 (inc. VAT), for each buyer, to cover this process. These fees are payable before we can progress an agreed sale.







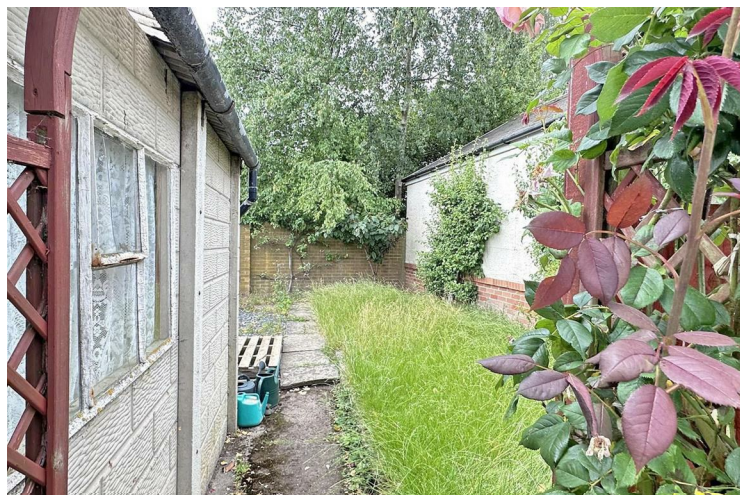

Durham Road, Stockton-On-Tees, TS19 0PX

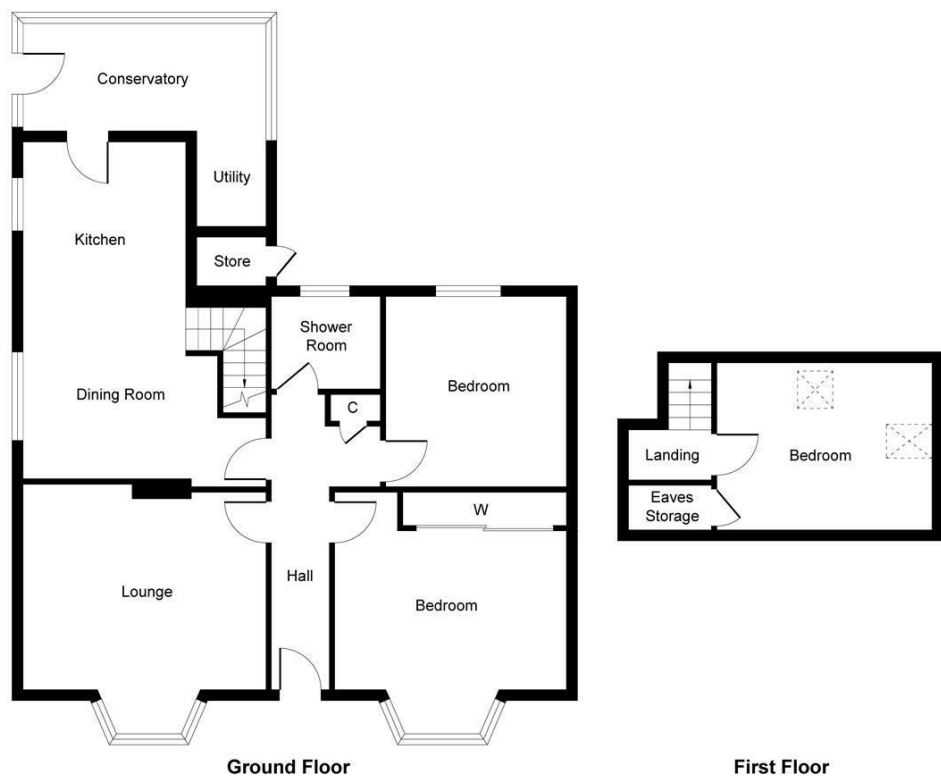

Whilst every attempt has been made to ensure the accuracy of the floor plan contained here, measurements of doors, windows, rooms and any other items are approximate and no responsibility is taken for any error, omission, or mis-statement. The measurements should not be relied upon for valuation, transaction and/or funding purposes. This plan is for illustrative purposes only and should be used as such by any prospective purchaser or tenant. The services, systems and appliances shown have not been tested and no guarantee as to their operability or efficiency can be given.

Copyright V360 Ltd 2025 | www.houseviz.com

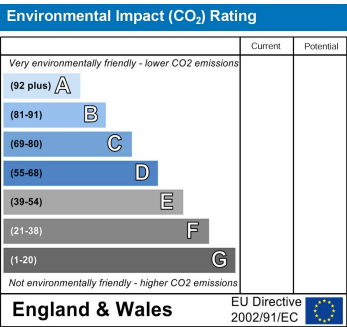
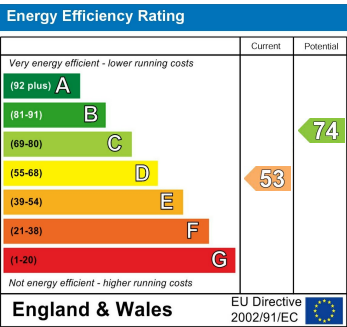

VIEWING
Please contact us on 01642 615657 if you wish to arrange a viewing or would like more information.

These particulars, whilst believed to be accurate are set out as a general outline only for guidance and do not constitute any part of an offer or contract. Intending purchasers should not rely on them as statements of representation of fact, but must satisfy themselves by inspection or otherwise as to their accuracy. No person in this firms employment has the authority to make or give any representation or warranty in respect of the property.

17 Bishop Street, Stockton on Tees, TS18 1SY
stockton@gowlandwhite.co.uk