



The Avenue, Fairfield, Stockton-On-Tees, TS19 7EY

This charming two bedroom detached bungalow, offered with no onward chain, is tucked away in a secluded position at the end of a private road. Set on a large plot, it offers excellent potential for expansion and development of the existing outbuildings.

Immaculately presented, the property opens with a spacious entrance hall leading to a large lounge/dining room, complete with an electric fire and French doors opening to the side garden. The impressive kitchen/breakfast room includes a range of fitted units, marble worktops, and integrated appliances, including an induction hob, double oven, washing machine, dryer, and fridge/freezer.

Both double bedrooms come with fitted wardrobes, with the master bedroom benefiting from an en-suite shower room. A well appointed family bathroom completes the living space. The bungalow is double-glazed throughout and warmed by a new heat pump installed in 2023.

Outside, well maintained gardens surround the property, featuring lawns, flower beds, planters, a patio, decking, and a pond, offering various spaces to enjoy the outdoors. A long driveway provides ample off-road parking and leads to a large detached garage and carport. The outbuilding, featuring two rooms with a WC, power, and lighting, offers further development potential as a separate annex, workshop, or home office, subject to planning consent.

Although nestled in a secluded setting, this property is ideally located in Fairfield, providing privacy while remaining conveniently close to reputable schools, Stockton Sixth Form College, and local shops and amenities. With quick access to the A66, it offers excellent transport links, making it an ideal choice for those seeking both tranquility and convenience.

£375,000



The Avenue, Fairfield, Stockton-On-Tees, TS19 7EY

HALL

LOUNGE

13'10" x 11'1" (4.22m x 3.38m)

DINING ROOM

14'8" x 8' (4.47m x 2.44m)

KITCHEN/BREAKFAST ROOM

20'10" x 9'6" (6.35m x 2.90m)

BEDROOM ONE

13'5" x 11'11" (4.09m x 3.63m)

ENSUITE

6'3" x 4'4" (1.91m x 1.32m)

BEDROOM TWO

11'11" x 10'11" (3.63m x 3.33m)

BATHROOM

6'7" x 6'2" (2.01m x 1.88m)



The Avenue, Fairfield, Stockton-On-Tees, TS19 7EY



The Avenue, Fairfield, Stockton-On-Tees, TS19 7EY



The Avenue, Fairfield, Stockton-On-Tees, TS19 7EY

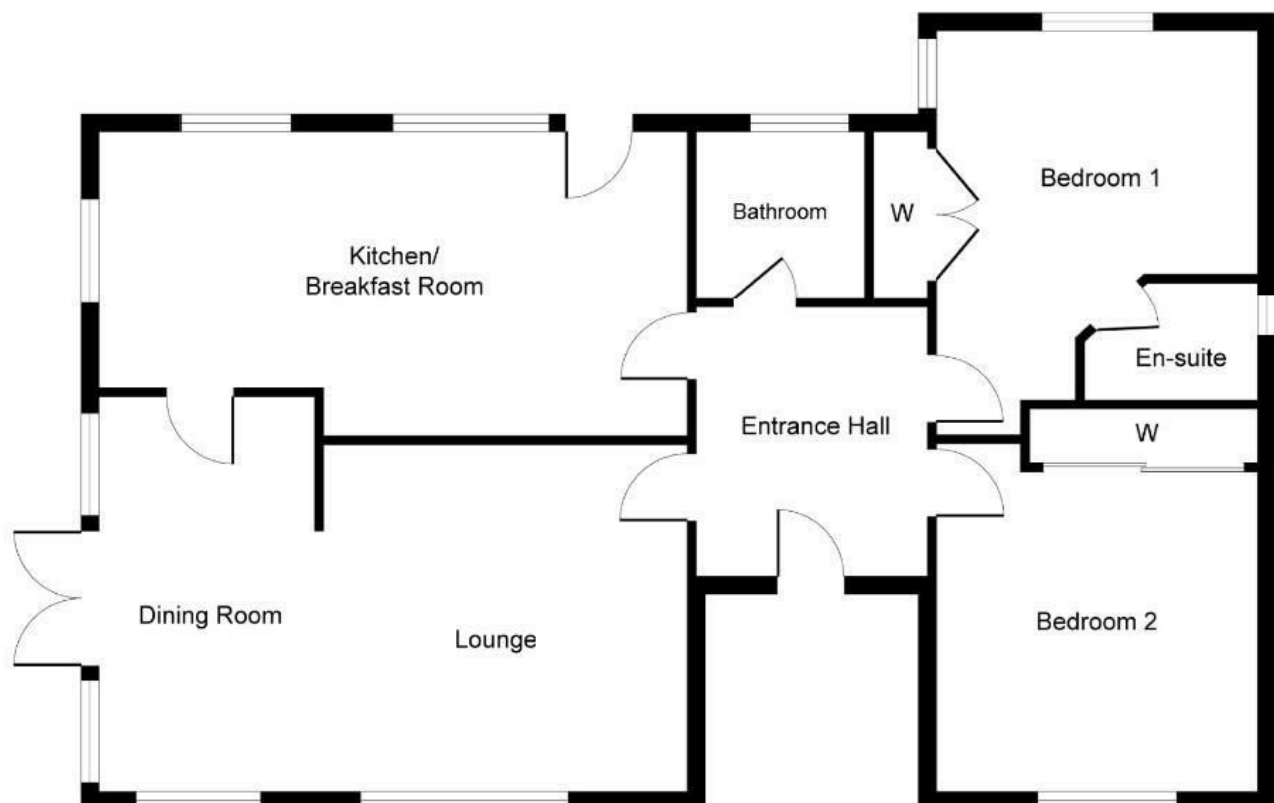

The Avenue, Fairfield, Stockton-On-Tees, TS19 7EY

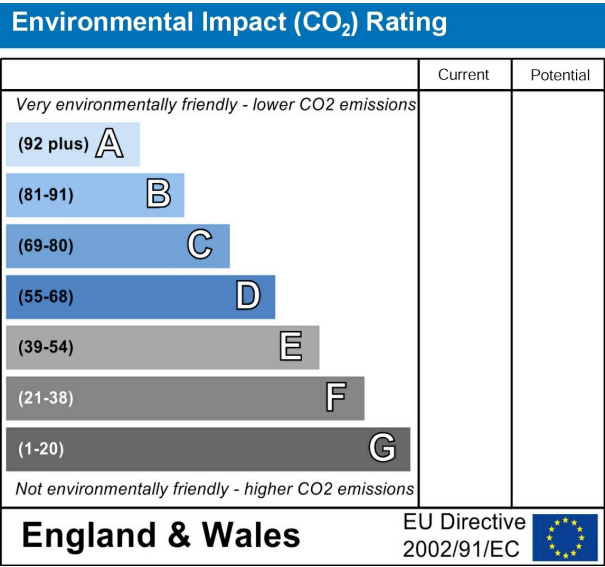
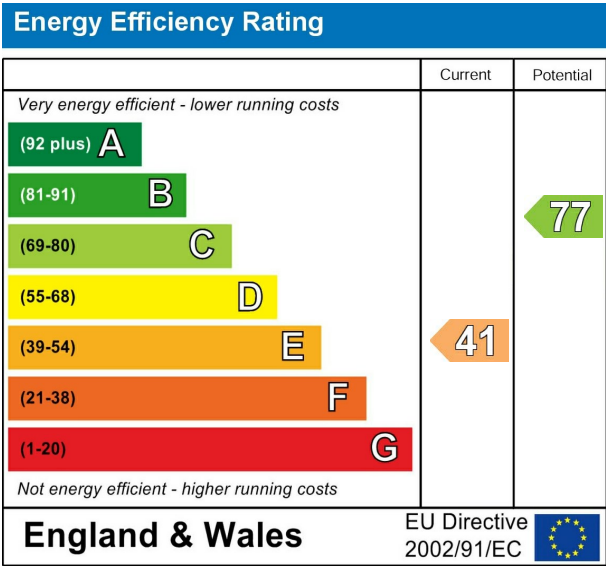
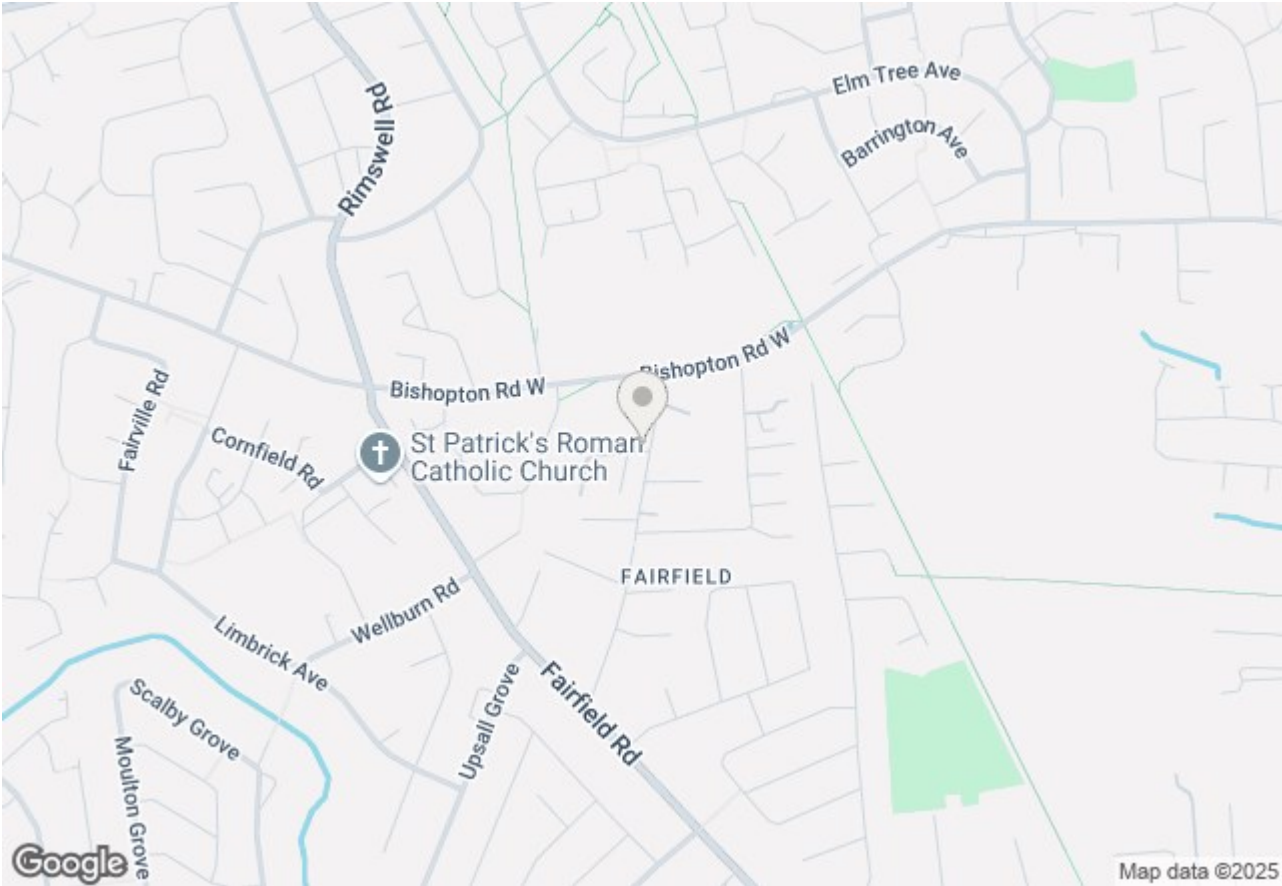

VIEWING
Please contact us on 01642 615657 if you wish to arrange a viewing or would like more information.

These particulars, whilst believed to be accurate are set out as a general outline only for guidance and do not constitute any part of an offer or contract. Intending purchasers should not rely on them as statements of representation of fact, but must satisfy themselves by inspection or otherwise as to their accuracy. No person in this firms employment has the authority to make or give any representation or warranty in respect of the property.

17 Bishop Street, Stockton on Tees, TS18 1SY
stockton@gowlandwhite.co.uk