



Tasman Drive, Hartburn, Stockton-On-Tees, TS18 5LA

Offered with NO CHAIN, discover this charming two bedroom semi-detached bungalow with detached garage, presented in good condition and offered with no chain. Perfectly situated in the sought after area of Hartburn, this property enjoys a sunlit south-facing rear garden and easy single floor living.

The welcoming entrance hall leads to a generously sized lounge. The modern kitchen features sleek high gloss units, an integrated oven, hob, fridge/freezer, and a freestanding washing machine. French doors open onto the rear garden, creating a seamless indoor-outdoor living experience.

There are two bedrooms, with one offering a lovely view of the garden. The contemporary shower room is equipped with a large shower cubicle and modern fittings.

Externally, the front garden is neatly maintained with a lawn, established shrubbery, and a driveway leading to a gate offering additional security. The rear garden includes a detached garage, a sunny patio area, and a well kept lawn, perfect for relaxation and outdoor entertaining.

Conveniently located close to popular schools, amenities at Harper's Parade shops, and Hartburn Village, with easy access to bus routes and the A66 for effortless commuting, this delightful bungalow is ideal for those seeking a low maintenance home with the benefits of single floor living.

£160,000



Tasman Drive, Hartburn, Stockton-On-Tees, TS18 5LA

HALL

LOUNGE

12'5 x 15'11 (3.78m x 4.85m)

KITCHEN

8'10 x 10'2 (2.69m x 3.10m)

BEDROOM ONE

15'3 x 9'6 (4.65m x 2.90m)

BEDROOM TWO

10'10 x 5'10 (3.30m x 1.78m)

SHOWER ROOM

5'10 x 5'9 (1.78m x 1.75m)





Map

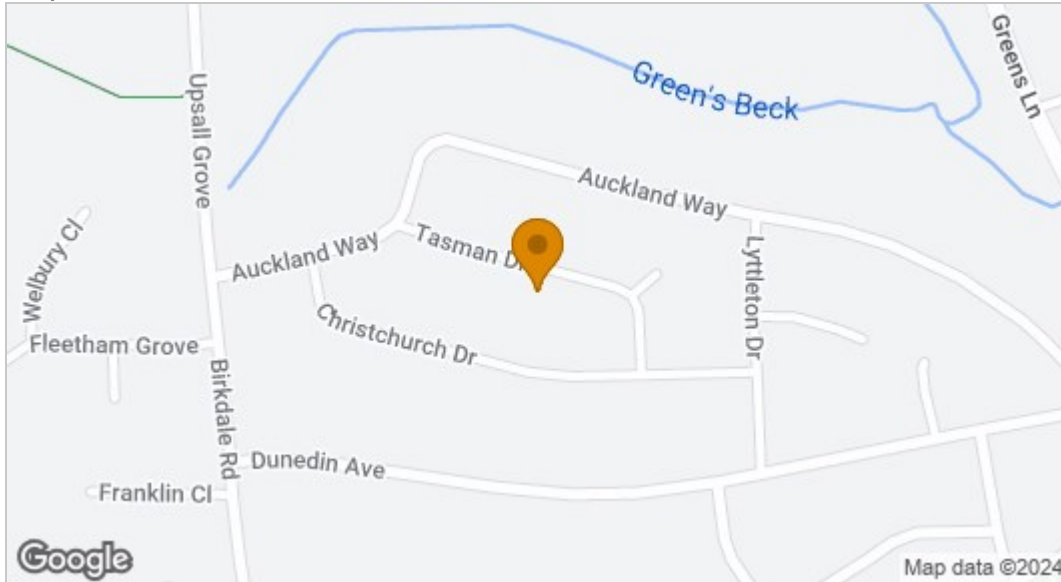

EPC graph

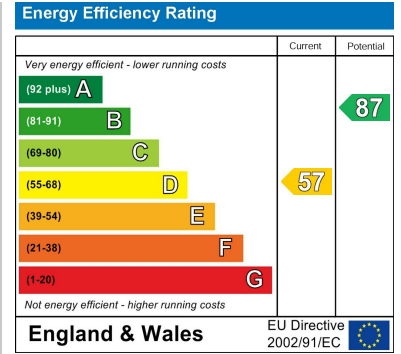

Floor Plan

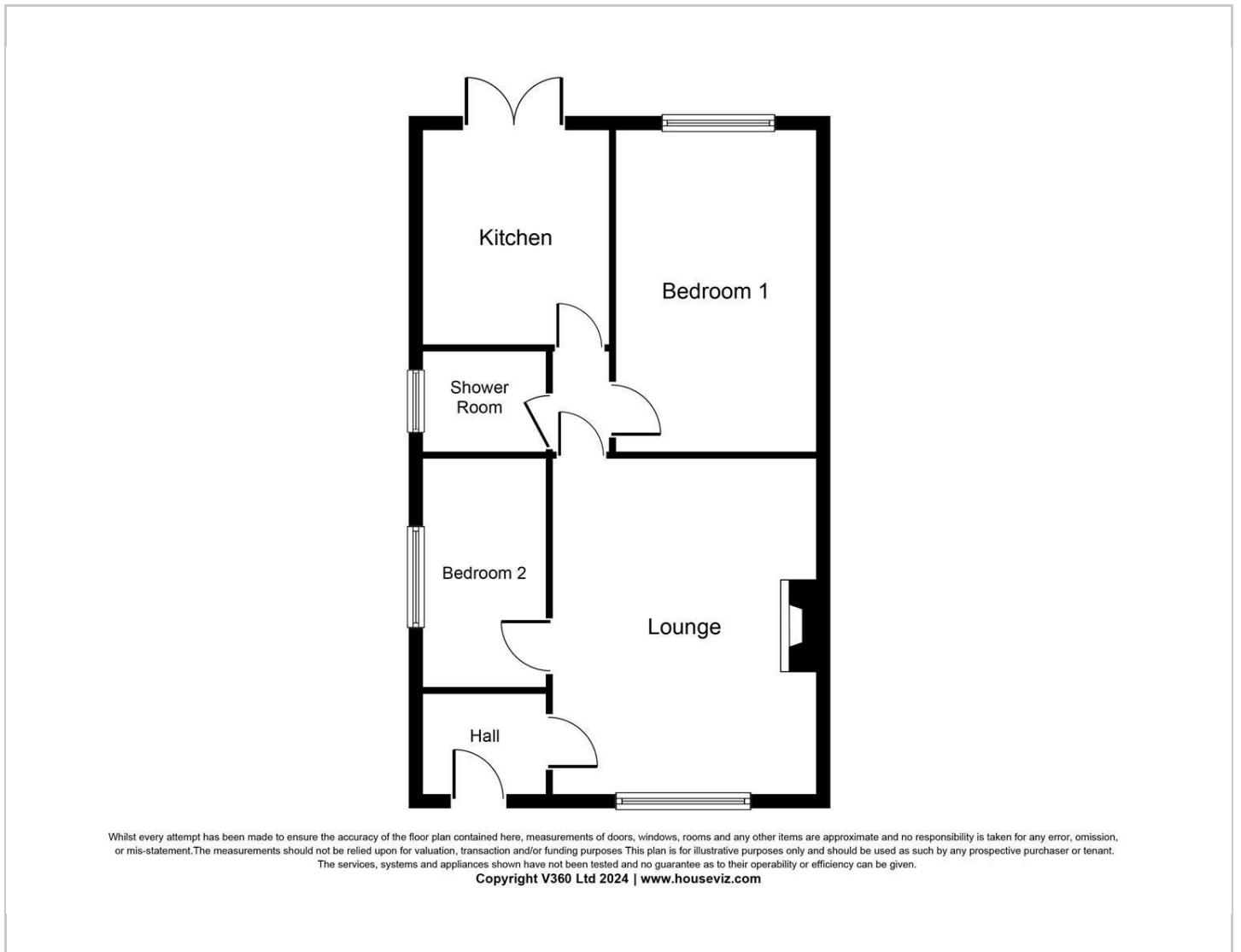

VIEWING

Please contact us on 01642 615657 if you wish to arrange a viewing or would like more information.

These particulars, whilst believed to be accurate are set out as a general outline only for guidance and do not constitute any part of an offer or contract. Intending purchasers should not rely on them as statements of representation of fact, but must satisfy themselves by inspection or otherwise as to their accuracy. No person in this firm's employment has the authority to make or give any representation or warranty in respect of the property.

17 Bishop Street, Stockton on Tees, TS18 1SY

Tel: 01642 615657 Email: stockton@gowlandwhite.co.uk <https://www.gowlandwhite.co.uk/>